

Oversize
K
912.781
Sh1
1873

Use
LM
496
nc.9.

ATLAS
OF
SHAWNEE
COUNTY, KANSAS

S.A.T.

Over-size Also
K LM
912.781 496
Shl m 9
1873

ATLAS

OF

SHAWNEE CO.

KANSAS.

From Recent ^{AND} Actual Surveys ^{AND} Records
Under the Superintendence of

F. W. BEERS.

PUBLISHED BY

F. W. BEERS & CO.

36 Vesey St.

NEW YORK.

1873.

Litho Power Press Print of
CHARLES HART
36 Vesey St. N.Y.

Engraved on Stone by
LOUIS E. NEUMAN
36 Vesey St. N.Y.

Entered, according to Act of Congress in the Year 1874, by F. W. Beers & Co. in the Office of the Librarian of Congress at Washington D. C.

KANSAS STATE
HISTORICAL SOCIETY

FEB 7 1927
Mrs. James Hartman

TABLE OF CONTENTS.

TOWNSHIP PLANS.

	PAGE.
AUBURN.....	58 & 59
DOVER.....	24 & 25
MISSION.....	28 & 29
MONMOUTH.....	66 & 67
ROSSVILLE.....	8 & 9
SILVER LAKE.....	12 to 17
SOLDIER.....	20 & 21
TOPEKA.....	32 & 33
TECUMSEH.....	54 & 55
WILLIAMSPORT.....	62 & 63

CITY AND VILLAGE PLANS.

	PAGE.
AUBURN.....	63
ROSSVILLE.....	9
SILVER LAKE.....	16
TOPEKA.....	36 to 51
TECUMSEH.....	55

MISCELLANEOUS.

	PAGE.
Table of Distances.....	4
Explanations for the Atlas.....	4
United States Statistics.....	4
Map, (Outline,) of Shawnee Co.....	5
Business Notices.....	6

POTTAWATTAMIE CO.

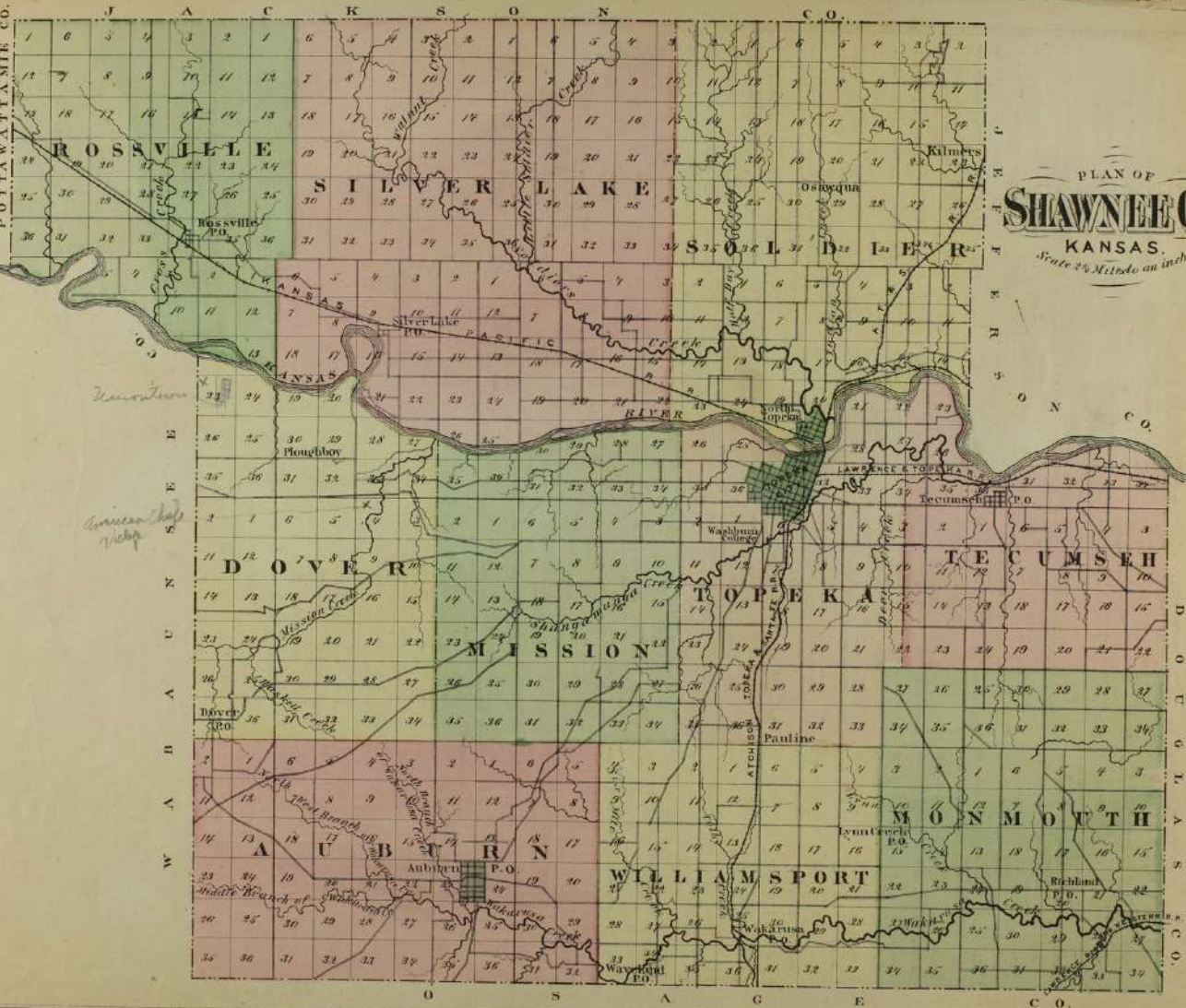

PLAN OF
SHAWNEE CO.
 KANSAS.
 Scale 2 1/2 Miles to an inch

Uniontown
Uniontown
Uniontown

SHAWNEE COUNTY BUSINESS NOTICES.

Topeka

ATTORNEYS

Admiral & Carey Railroad St, North Topeka
Cunningham B. cor. 5th and Kansas Ave
Clemens & Friedrich. Office, over Adams Bank, North Topeka
Cummings J. F. Res. cor. Monroe and 7th St
Dennis E. W. Attorney and General Solicitor, E. P. R. R. Co., 106 6th Ave
Donald W. P. Attorney and Counsellor at Law, Topeka Kansas
Ennis A. Atty and Counsellor at Law, 143 Kansas Ave.
Guthrie John. Atty and Counsellor at Law, 140 Kansas Ave.
Johnston T. E. Atty and Counsellor at Law, cor. 5th and Kan Ave
McFarland N. C. Atty and Counsellor at Law, 202 Kan Ave
McFarland J. D. Atty and Counsellor at Law, North Topeka
Moss J. H. Atty and Counsellor at Law, 181 Kansas Ave
Martin, Buras & Case. Atty and Counsellors at Law, 154 Kansas Ave
McDonald Jno. M. Atty and Counsellor at Law, 196 Sixth Ave
McDougal C. Atty and Counsellor at Law, S. E. cor. 6th and Kan Ave
Noble & Gray. Atty and Counsellors at Law, 157 Kan Ave
Richter E. J. Atty and Counsellor at Law, 185 Kan Ave
Stafford J. Atty and Counsellor at Law, 293 Kan Ave
Searle J. G. Atty and Counsellor at Law, 185 Kan Ave
Spencer J. M. Atty and Counsellor at Law, cor. 6th and Kan Ave
Shull E. Notary Public, 106 6th Ave
Williams A. L. Attorney, 149 Kan Ave

BANKS

Capital Bank 202 Kansas Ave, J. D. Knox, Pres. A. Stinson, Cashier
Citizens Bank, Kansas Ave, North Topeka, J. R. Swallow, Cashier. A. P. Havens, Asst Cashier.
Kansas Valley Nat Bank, D. M. Adams, Pres. C. N. Rice, Cashier
Shawnee County Bank, N. W. cor. 6th and Kansas Ave, W. D. Terry, Pres, W. J. Stagg, Cashier, D. Haywood, Vice Pres
Topeka Bank and Savings Institution, S. W. cor. 5th and Kansas Ave, G. W. Veale, Vice Pres, J. R. Mulrann, Cashier
Topeka Nat Bank, 185 Kansas Ave, Saml. R. Lakin, Cashier

BOOK BINDERS and STATIONERS

Crane & Byron. Wholesale Stationers, Blank Book Manufacturers, Printers, Binders, and Lithographers, Commonwealth Building. We desire to be called upon by each Stranger, visiting the City.

BOOTS and SHOES

Benson A. P. Mfr. Wholesale and Retail Dealer in Ladies, Gents, and Children's Boots and Shoes, and Custom Work, 150 Kansas Ave
Bill & George. General Dealers in Boots and Shoes, and Mfrs of all kinds of Ladies and Gents wear. Boot up side down 190 Kansas Ave
McGintey Geo. Mfr and Dealer in Boots and Shoes. Special attention given to Custom work, 167 Kansas Ave

BREWERS

Herboldsheimer A. Propr of Topeka Steam Brewery. Highest quality paid for. Beer, Bavarian Lager Beer, constantly on hand. Orders promptly attended to, P. O. Box 130
Moser P. Propr of Brewery, cor. 2d and Polk St. Manufacturer of Lager Beer

CROCKERY

Farnsworth J. W. Importer and Dealer in Crockery, Glassware, Silver Plated and Britanna Ware, Lamps, Chandeliers and Gas Fixtures, Table Cutlery, &c., 147 Kansas Ave

CONTRACTORS and BUILDERS

Bishop J. W. cor. 6th and Polk
Cordington A. M. Quiney bet. 6th and 7th St
Chubb J. 10th and Kansas Ave
Elliott J. Stone and Brick Builder, 279 Harrison St
Howard Bros. Railroad St, North Topeka
Morris A. 135 Jefferson St
Nagel C. Curtis and Kansas Ave, North Topeka
Rosen & Lagerstrom. Brick and Stone work, 82 Topeka Ave, P. O. Lock Box, 178

COAL

Blandin D. F. Supt. Carbo, Coal Mining Co. B. E. cor. 6th and Kansas Ave

CARRIAGE MANUFACTURERS

Fensky H. General Blacksmithing, Carriage and Wagon making, Horse Shoeing, &c., Kansas Ave, N. Topeka
Polley J. A. Mfr of Carriages, Buggies, and Light Wagons, adjoining, 5th Ave Hotel, Dealer in the celebrated Harrison Wagon

DRY GOODS

Burgess H. & Son. Dealers in Dry Goods, Clothing, Hats, Caps, Boots and Shoes, Quincere, &c., Kansas Ave, North Topeka

Kendall C. F. Dry Goods, Hats, Caps, and Carpets, Wholesale and Retail, 167 Kansas Ave
Lyman P. C. General Dealer in Dry Goods, Groceries, Hats, Caps, Boots, Shoes, and Clothing, 70 Kansas Ave, N. Topeka
Minkler H. H. Dealer in Dry Goods, Groceries, Hats, Caps, Boots, Shoes, and Agricultural Implements, Dover
Palmer S. E. A. Dealer in Dry Goods, Groceries, and all Goods, generally kept in a first-class Country Store, Auburn
Sage A. Dry Goods, Hats, Caps, Boots, Shoes, Groceries, &c., Dover, Dover Township

DRUGGISTS

Arnold A. J. Wholesale and Retail Druggist, Kansas Ave, North Topeka
Baker & Brown. Wholesale and Retail Druggists, 201 Kansas Ave

EDITORS

Macdonald & Baker. Publishers of the "State Record," 104 6th Ave
Prouty S. S. General Manager of "Commonwealth"

FOUNDRIES

Kansas Valley Foundry, and Machine Co. Works located, cor. Second and Madison Sts, Mfrs of Steam Engines, Boilers, Mill and Mining Machinery, Architectural Iron Work, also, Sash, Blinds, Doors, Mouldings, Brackets, &c., A. Stark, Supt

FLORISTS and NURSERYMEN

Keith & Rogers. Florists and Gardeners, Dealers in and Growers of Ornamental Trees, Shrubs, Vines, &c., Rosas and Green House Plants a specialty, Green Houses and Garden on Kansas Ave, South of Topeka
Stark & Meade. Fruitland Nurseries, two miles South East State House. Fruit Trees, Small Fruits, Evergreens, Shrubbery and all Nursery Stock, at lowest prices and quality warranted.
Stone E. R. Dealer in Fruit and Ornamental Trees, Shrubbery, &c. One mile East of Topeka, on Lawrence and Topeka Road
Stone G. W. Dealer in and Raiser of Hedge Plants, N. E. part of Dover Township

GROCERS

Baker E. W. & Co. Wholesale Grocers, Pork Packers, and Dealers in Tobacco and Cigars, cor. Kansas Ave, and Rail Road St, North Topeka
Bauer H. P. General Dealer in Groceries, Kansas Ave, North Topeka
Cook & McFadden. Grocers, 243 Kansas Ave
Friedrich I. Grocer and Landlord of Tenement Property, cor. 2nd and Madison Sts
Hughes R. G. Dealer in Groceries, Provision, Country Dainties, Flour, Feed, cor. 6th and Topeka Ave
Morse D. L. Dealer in Groceries, and Propr of Bakery Kansas Ave, bet 7th and 8th St
Whitson C. E. & Co. Grocers, 241 Kansas Ave

GRAIN, FLOUR and FEED

Edson W. Dealer in Flour and Feed, 246 Kansas Ave
Shellabarger, Griswold & Co. Shawnee Mills, Mfrs of best qualities of Family Flour, Meal and Mill Feed, Cash paid for Wheat, cor. 3d and Kansas Ave

HOTELS

Capital House, 6th bet. Kansas Ave, and Jackson, J. Wilson, Propr
Curtis House, cor. Rail Road and Jackson St, Wm. Curtis, Propr
Fifth Avenue Hotel, cor. 5th and Quiney St, J. B. Fluna, Propr
Gault House, cor. 5th and Jackson, R. C. Love, Propr

HARDWARE

Knowles J. S. & Co. General Dealers in Hardware, 239 Kansas Ave
Kistler B. F. & Sons. Hardware, Stores, and Agricultural Implements, Kansas Ave, North Topeka
Reese S. Hardware, Cutlery, Queensware, Garden Seeds, &c. Kansas Ave, North Topeka

INSURANCE

Martin R. G. Agent for German Mutual Life of St. Louis, and Fireman's Fund of Cal. Also Dealer in School Furniture, 155 Kansas Ave
Pope E. Sec. of Home Insurance Co, Shawnee Co, Bank Building
Watson J. P. Insurance Agt, and Dealer in Coal, 6th and Kansas Ave

LUMBER DEALERS

Kulbak H. Builder and Lumber Dealer, 151 and 165 Jackson St
McClure W. P. Dealer in Lumber, and Stock Res Quiney, bet. 9th and 10th
Reed C. Kansas Ave, and 8th Ave
Widler & Eckel. Dealers in Lumber, Doors, Sash, Mouldings, Shingles, and Lath, Office, East Side Kansas Ave, North of New Depot, N. Topeka

LIVERIES

Lindsey & Thomas. Livery Stable, 5th St, bet. Kansas Ave, and Jackson St
Parks C. W. Propr Livery, cor. Quiney and R. Road St, North Topeka
Rain S. & Co. Propr Livery, 6th Ave, bet. Jackson and Van Buren Sts
Wolff Geo. Propr Livery, 5th St, bet. Kansas Ave, and Quiney St

MANUFACTURERS

King Wrought Iron Bridge Manufacturing and Iron Works. Mfr of all Patterns, of Iron Combination and Wagon Railway, and High Way Bridges, Swing Bridges, Iron Turn Tables, Substructures, and Iron Supporters

MERCHANT TAILORS

Bowman C. Merchant Tailor, and Dealer in Gents Furnishing Goods, 177 Kansas Ave
Steinberger L. & Co. Clothing, Hats, Caps, &c., 188 Kansas Ave

MARKETS

Bell & Beck. Poultry Meat Market, cor. 8th Ave and Jackson
Chandler & Johnston. Poultry Meat Market, 118 9th Ave
Frisbie & Kemp. Poultry Meat Market, 114 Kansas Ave
Horton N. P. Poultry Meat Market, Kansas Ave, North Topeka

PHYSICIANS

Brown W. H. Tecumseh Township
Campford M. A. Soldier Township
Carruth Mrs. L. M.D. Homeopathist, Res. Crane St, bet. Kansas Ave, and Quiney Special attention given to diseases of Women, and Children
Eidson A. M. Physician and Surgeon, 153 Kansas Ave
McDonald B. D. Physician and Surgeon, cor. 9th and Kansas Ave
Rodgers W. W. Physician and Surgeon, 86 Kansas Ave, North Topeka
Sheldon S. E. Physician and Surgeon, over Kansas Valley Bank
Springfield F. M. M.D. cor 5th and Madison
Telfer E. 225 Kansas Ave
Wynand Geo. Office, over Capital Bank, Kansas Ave, Res. Van Buren, bet 3d and 4th
Wood J. D. Physician, Williamsport Township

PHOTOGRAPHER

Knigh J. Lee. New Riverside Gallery, Established since 1868. All Negatives registered and preserved, the most complete and extensive Gallery in the State. Eight Silver Medals, and Nine Diplomas, received as First Premiums at State Fairs, in 1870, 1871, 1872. Photographic Stock and Artists materials at Wholesale, 174 Kansas Ave

REAL ESTATE

Admiral & Carey. Rail Road St, North Topeka
Booth J. cor. Kansas Ave, and 7th St
Czaplin A. P. Loan and Real Estate Agt, 97 Kansas Ave
Gavitt & Scott. 180 1-2 Kansas Ave
Gregg S. C. 72 Kansas Ave, North Topeka
Holliday C. K. 174 Kansas Ave
Horn D. H. 175 Kansas Ave
Langell E. 214 Kansas Ave
Miller Bradford. 163 Kansas Ave
Stricker H. J. Tecumseh
Thompson T. S. 81 and 83, 10th Ave
Van Horn B. E. Kansas Ave, North Topeka, over Citizens Bank
Walker T. H. Res. cor. Harrison St, and 10th Ave
Wilcox Adams & Co. 297 Kansas Ave

STATE, CITY and COUNTY OFFICERS

Secretary of State. W. H. Smallwood
Treasurer. J. E. Hayes
Mayor of Topeka. O. T. Welch
Clerk. R. H. C. Searle
City Marshal. S. Hindman
County Treas. T. M. James
Recorder. W. P. Thompson
Deputy Recorder. Geo. B. Holmes
County Supt. Geo. B. Holmes
County Commissioners. E. Carriger, B. J. Rieker, Golden Silvers

SEWING MACHINE AGENT

Bowman C. Agent for Singer Machines, Kan Ave
Bright C. W. Agent for the Domestic, the King of Lock Stitch Sewing Machines. It challenges the world on either light or heavy work. Office, Kan Ave, bet. 6th and 7th

Mason & Wright. Agents for the Howe Machine. The Howe is the only Machine that gives satisfaction, took the only premium given by the Kansas State Agricultural Society, Sept 1872. Makes the most perfect stitch on all kinds of material, of any machine in the market, Office, 155 Kansas Ave

SALOONS

Johnson N. A. 165 Kansas Avenue
Kimmerle G. H. 71 Kan Avenue, North Topeka
Smith C. Dealer in Wines and Liquors, 7th St, near Kansas Ave

MISCELLANEOUS

Anderson T. J. Agent for K. F. E. R
Brown J. W. Farmer, Auburn
Bush B. E. Farmer, Auburn
Burling H. Land Department, A. T. and S. F. R. R.
Botsford Bros. Stock Dealers, cor. 7th and Elmore St
Brewer J. Farmer, cor. Western Ave, and Eleventh St

Brooks W. H. Jr. Cor. Eight and Buchanan St

Burton E. Propr Boarding House, 6th and Van Buren St
Bramer J. S. Speculator, 158 Kan Ave
Crane P. L. Capitalist, Res. Monroe bet. 3d and 4th Sts
Craig S. M. Res, Rail Road St., North Topeka
Carriger E. Farmer, Auburn
Campbell W. W. Dealer in Agricultural Implements
Cross D. M. Millwright, 106 Quiney Street
Campbell H. Res, 95 Harrison St
Cox A. Farmer, Topeka Township
Copson D. Painter, 121 Kan Ave
Disney W. Farmer and Stock Dealer, Month-month Township
Devoreux J. P. Land Commissioner of K. P. Rail Road
Emt H. H. Miller, Monroe St, bet. First and Second St
Evans J. E. Justice Peace, Soldier Township
Foster F. R. Farmer, Topeka Township
Foster F. H. Stock Dealer and Farmer, Topeka Township
Fagan W. W. Asst Supt, A. T. and S. F. R. R.
Gage G. G. Res, Van Buren bet. 4th and 5th Street
Gemmell H. B. Supt L. and S. W. E. R. Office, 68 Mass. St, Lawrence
Hamilton G. W. Farmer, Williamsport
Hamilton J. Civil Engineer, 174 Kansas Ave
Higgins J. S. Res, cor. 4th and Topeka
Horner A. F. Dealer in Stone and Lime, Florence, Kansas. Res, cor. Ninth and Tylar St
Harvey J. M. Farmer, Topeka Township
Higgins H. Farmer, Topeka Township
Hickey J. A. Res, cor. 7th and Van Buren
Jackson E. D. Farmer, Month-month Township
Kellam E. P. Chief Clerk Land Dept. A. T. and S. F. R. R. Co
Kellam Geo. M. Farmer, Topeka Township
Klein Jacob. Farmer, Topeka Township
Lakin D. L. Land Commissioner, A. T. and S. F. R. R. Co
Laurent L. Res, Kansas Ave, opp Capital Mills
LaTourrette C. Res, cor. Eleventh and Topeka Ave
Mills T. B. With King Bridge Co
McLaughlin J. A. Gun Dealer, 231 Kan Ave
Macawly O. H. Farmer, Soldier Township
Merrill Geo. Receiver, U. S. Land Office, 232 Kan Ave
Newtson G. H. Supt A. T. and S. F. R. R. Nichols B. Res, cor. Quiney and Gordon St, North Topeka
Oakley W. M. E. Clergyman, Res, cor. 11th and Tylar
Otis J. G. Farmer, Topeka Township
Pratt D. Farmer and Stock Broker, Topeka Township
Palmer A. Farmer, Topeka Township
Price H. C. Printer at Commonwealth, Res. 10 Sixth Ave, West
Rain Lewis. Foreman of Car Shop, A. T. and S. F. R. R.
Richmond J. Farmer, Topeka Township
Spencer G. W. Farmer, Topeka
Sext H. A. Farmer, Soldier Township
Shellbarger J. M. Farmer, Soldier Township
Silvers G. Farmer, Soldier Township
Stinson T. N. Farmer, Tecumseh
Smith I. H. Register, U. S. Land Office, 232 Kan Ave
Tice Perry. Farmer, Williamsport
Throop H. P. Speculator, Harrison St, Topeka
Ward A. A. Farmer, Topeka Township
Wade W. B. Farmer, Tecumseh Township
Woods G. H. Farmer, Lincoln St
Wilder E. Bras, A. T. and S. F. R. R. Co
Waysman J. K. Farmer and Stock Dealer, Tecumseh
Young J. N. Res, Topeka Ave, bet. 6th and 7th St
Young W. E. Res, cor. 6th and Harrison St

Rossville

Binnis B. Builder
Cass James. Lumber Dealer
De Graf J. Farmer
Gabbey B. S. Physician
Hopkins S. R. Sec. of Rossville Mtg Co, Manufacturer of Furniture, Wagons, Agricultural Implements, &c.
Hartnett C. H. Blacksmith
Kerr & Higginbotham. Dealers in Dry Goods, and Groceries
Kline & Lee. Dealers in Groceries and Stock
McElvane J. C. Merchant at Alma, Kansas
Neserve T. W. Justice of the Peace
Nadeau P. A. Farmer and Stock Dealer
Sherman A. C. Propr of Town Site and Dealer in Real Estate
Shumate H. K. Atty at Law, and Real Estate Agt
Seikel M. Farmer and Stock Dealer
Wilson A. Farmer and Stock Dealer, Kingville

RXII

RXIII

J A C K S O N C O

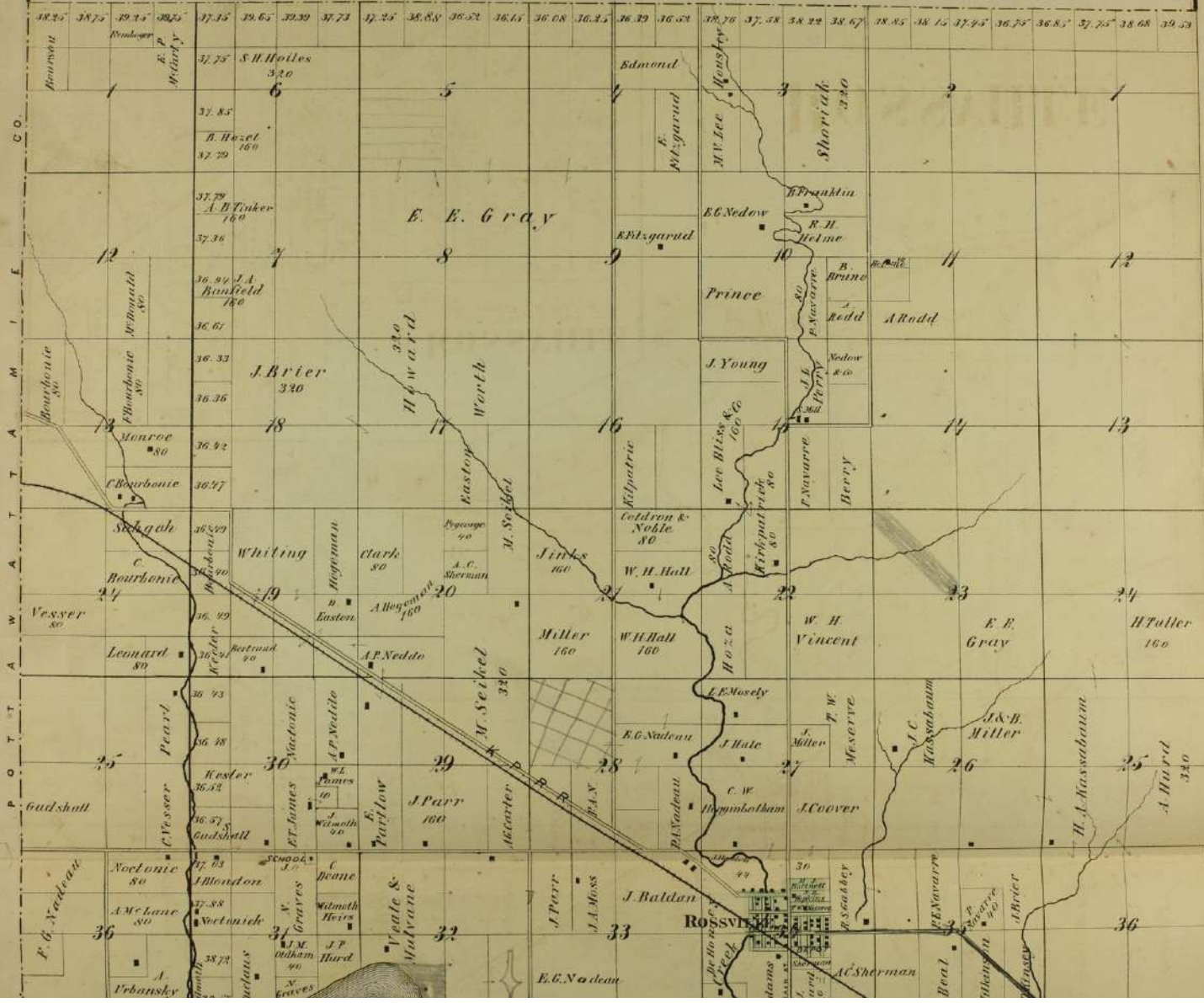

T.P. T.X. S.I.L.V.E.R. LAKE



PART OF
SILVER LAKE

Scale 2 inches to the mile

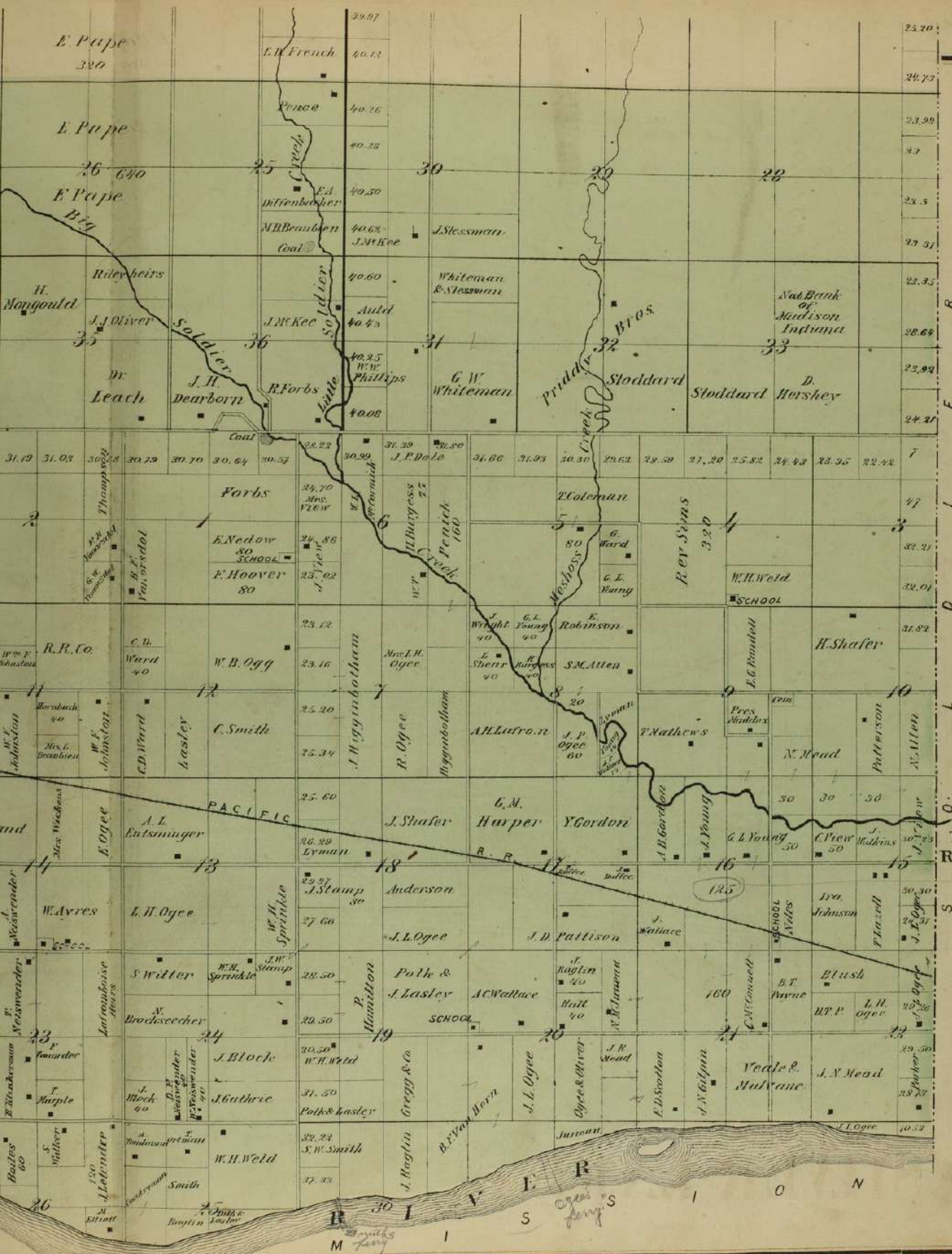

R
E
I
D
L
O.
T. XI
R. XV
S

For Charles
Hillage, as
agent for
Mrs. F. Hillage
Dec 1870-72
stable teacher
my school.

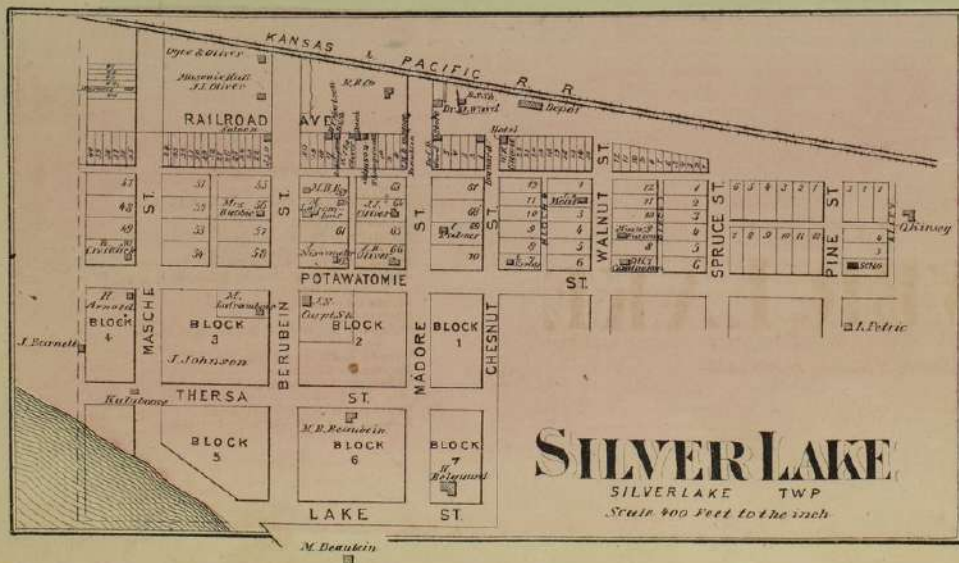
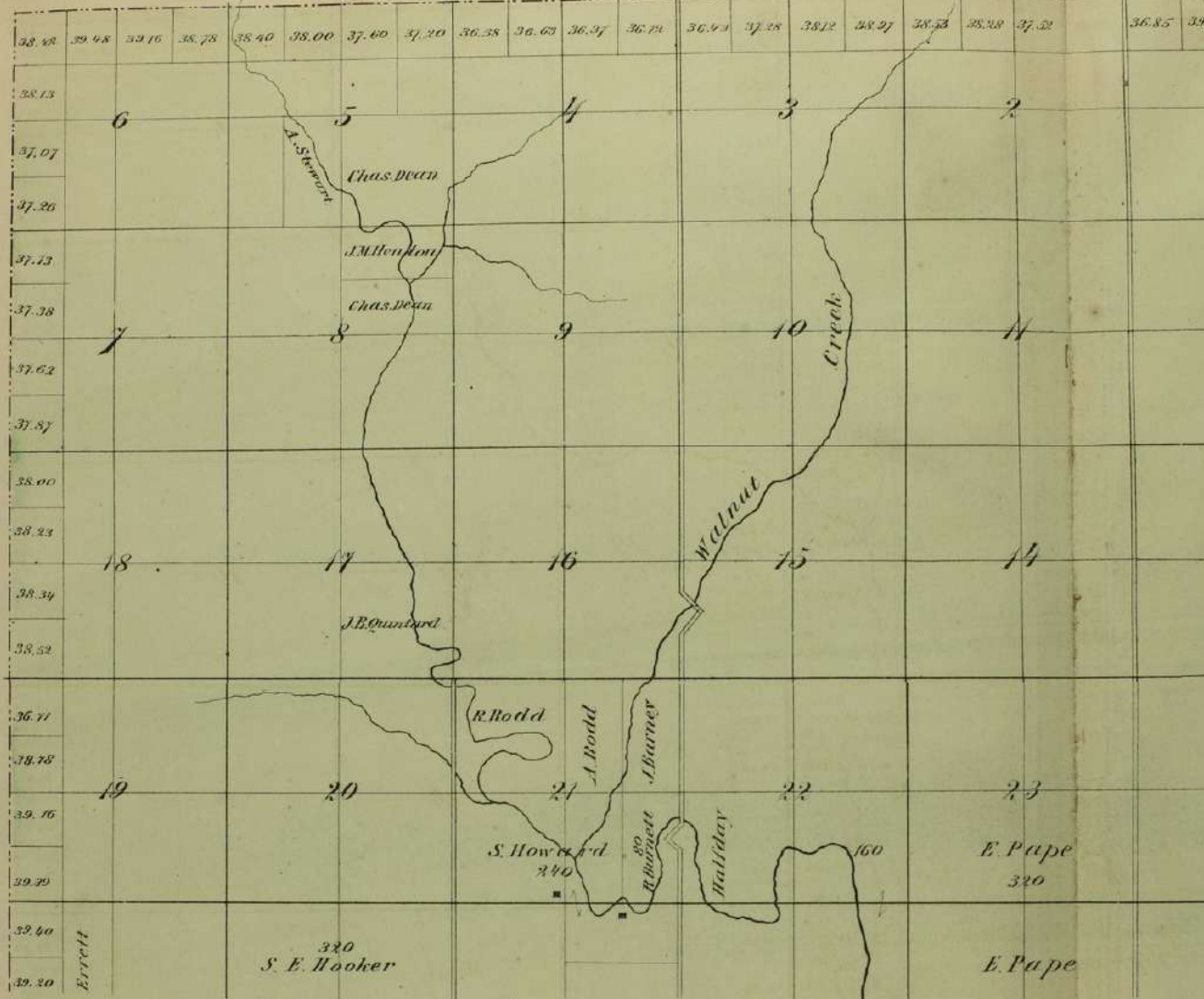

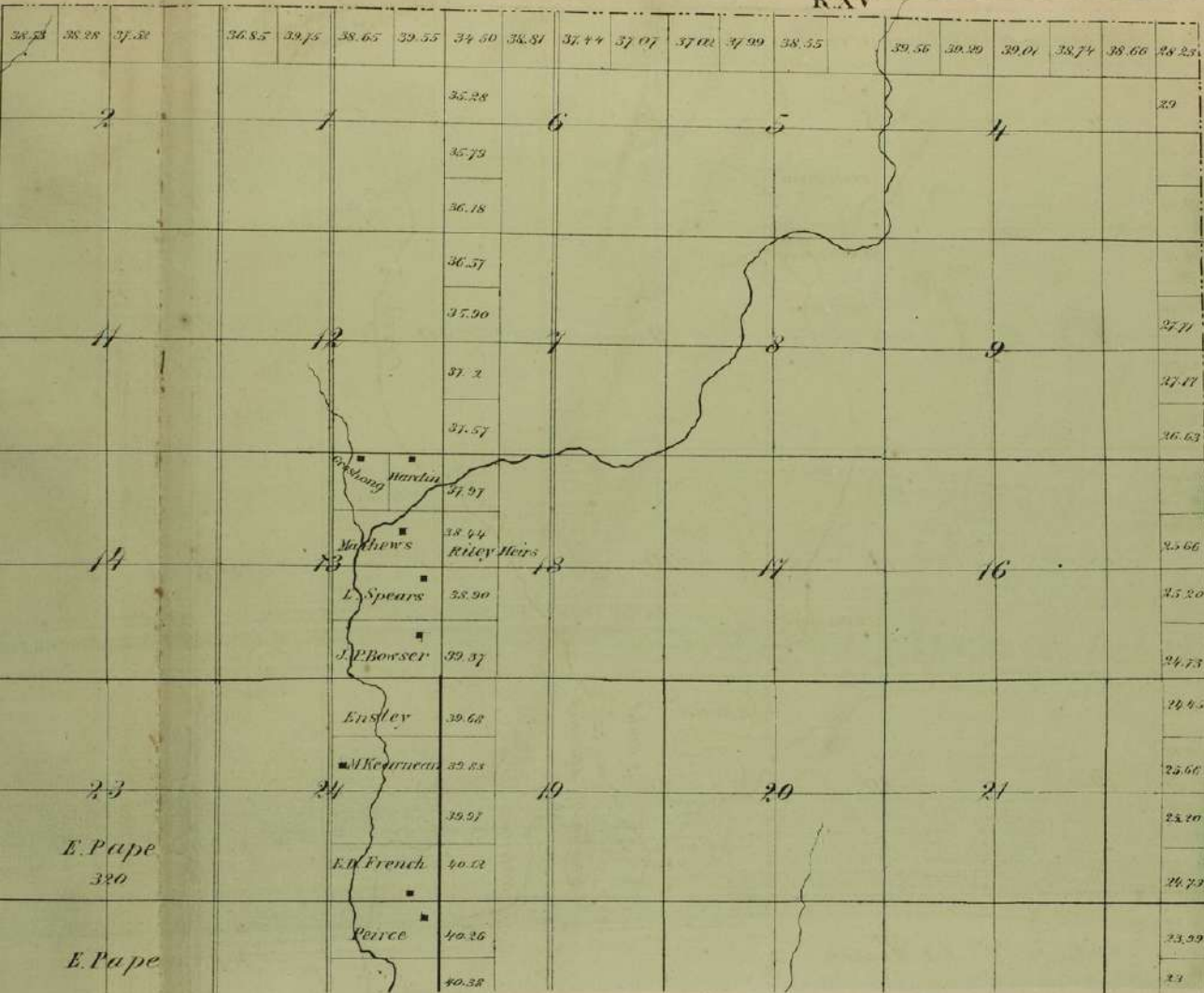

T. X

E. Pape
320

E. Pape

PART OF
SILVER LAKE

Scale 2 inches to the mile

Silver Lake
Business Notices

- Ayres W. Farmer
- Beaubien M. E. Merchant
- Dole J. P. Farmer and Carpenter
- Elliott W. H. Prop. of Hotel
- Johnston W. P. Notary Public, R. R. and Express Agt
- Keanedy E. H. Farmer
- Neesivender A. Farmer
- Oliver J. J. Prop. of Billiard Hall and Saloon
- Oliver J. B. Real Estate Agt
- Payne E. T. Farmer
- Ward C. D. Physician and Surgeon, also Merchant
- Wallace A. C. Building Mover
- Young G. L. Farmer and Stock Dealer

J A C K S O N C O

R. XV

R. XVI

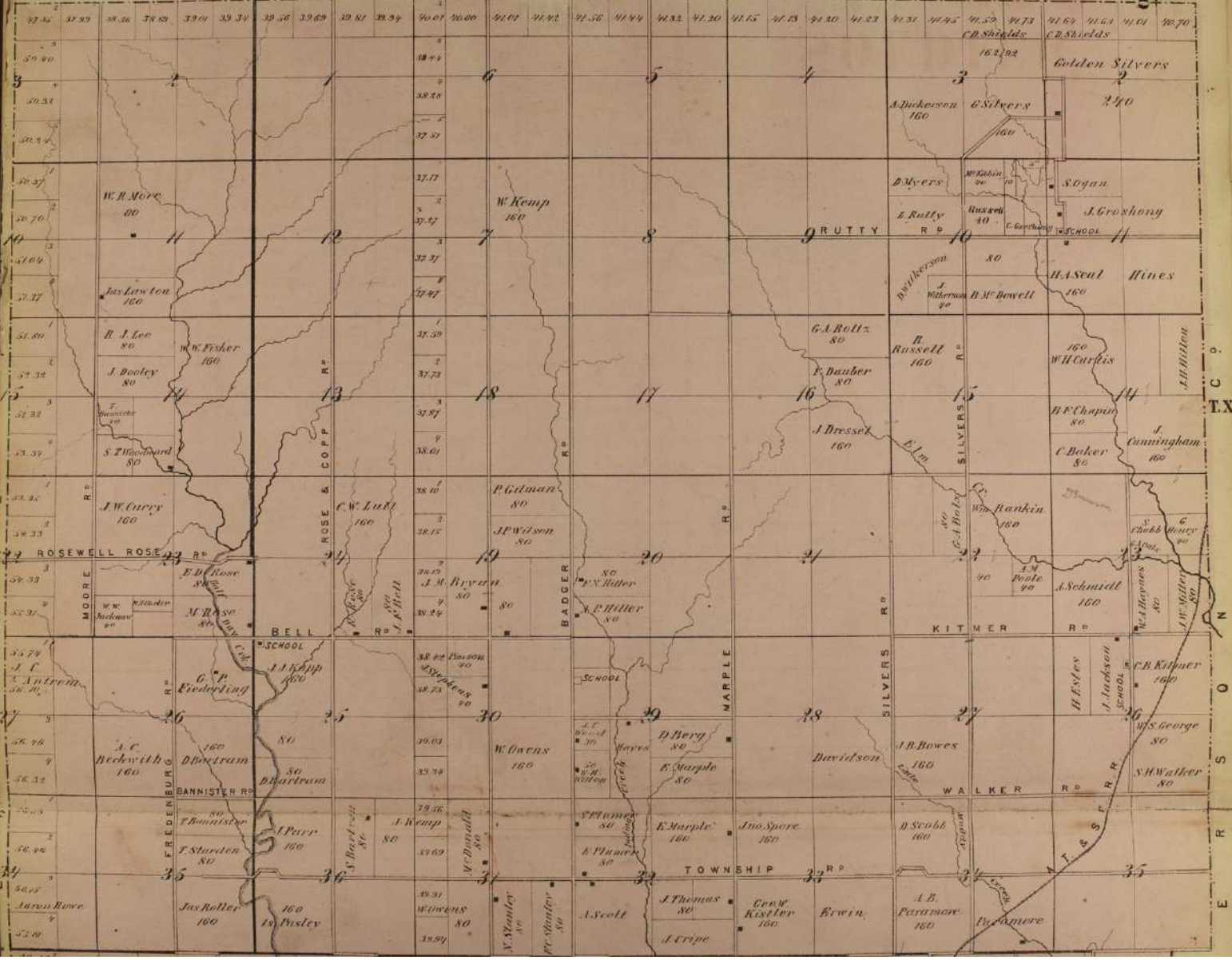

TX
N
S
E



Section	Parcel 1	Parcel 2	Parcel 3	Parcel 4	Parcel 5	Parcel 6	Parcel 7	Parcel 8	Parcel 9	Parcel 10
36	A.C. Beckwith 160	D. Bannister 160	W. Owens 160	E. Sharple 80	Davidson 160	J.B. Bowers 160	S.H. Waller 80			
35	J. Parr 160	J. Kemp 80	E. Marple 160	J. Thomas 80	Geo. W. Kistler 160	Erwin 160	A.R. Paramore 160			
34	J.D. Harper 143.11	J.D. Harper 161.99	I. Bickel 117	Alberfall 160	County Asylum 115	Wm. Shellabarger 135	Sam'l Larimer 113.50	J.S. Starr 160	S.W. Walper 160	
33	N.R. Bickel 160	J.N. Smith 80	M.A. Comptons 160	E. Hughes 160	Gen. Walters 80	J.H. Budget 80	Wm. Shellabarger 80	J.M. Shellabarger 80	J.T. Vaughan 160	
32	J.R. Bickel 80	R.N. Novak 160	C. Hughes 160	E. Hughes 160	B.F. Kistler 160	J. Bickel 80	J.M. Shellabarger 80	J.H. Smith 160	J.C. Buford 160	
31	Allen 160	J.M. Schultz 80	J.W. Valey 160	Wendal 160	Hamilton & Jones 160	Wm. Shellabarger 80	B.F. Kistler 80	J.H. Smith 160	J.C. Buford 160	
30	J.R. Bickel 80	R.N. Novak 160	C. Hughes 160	E. Hughes 160	B.F. Kistler 160	J. Bickel 80	J.M. Shellabarger 80	J.H. Smith 160	J.C. Buford 160	
29	ES Ward 160	Hines 113.95	Eliseo Campores 80	Soldier 160	Jas. M. Harding 160	Mrs. Turner 160	Papekoe 160	Wm. Shellabarger 80	J. Smith 160	
28	ES Ward 80	Eliseo Cole 85.16	Eliseo Campores 82.82	Joseph 80	H. Freeman 80	Jas. M. Harding 160	Mrs. Turner 160	Papekoe 160	J. Smith 160	
27	J.W. Wallace 80	W. Feather 80	B.F. Rawson 80	D.H. Macanley 80	J. Wilder 80	H. Smith 80	H. Smith 80	L. Laurent 290	E.F. Keilam 270	
26	J.W. Wallace 80	W. Feather 80	B.F. Rawson 80	D.H. Macanley 80	J. Wilder 80	H. Smith 80	H. Smith 80	L. Laurent 290	E.F. Keilam 270	

Millard
Old Mainstone
Trading Post



TXI
C. D.

E.
E.
S.

N.
S.

T. P.
N.
O.
S.

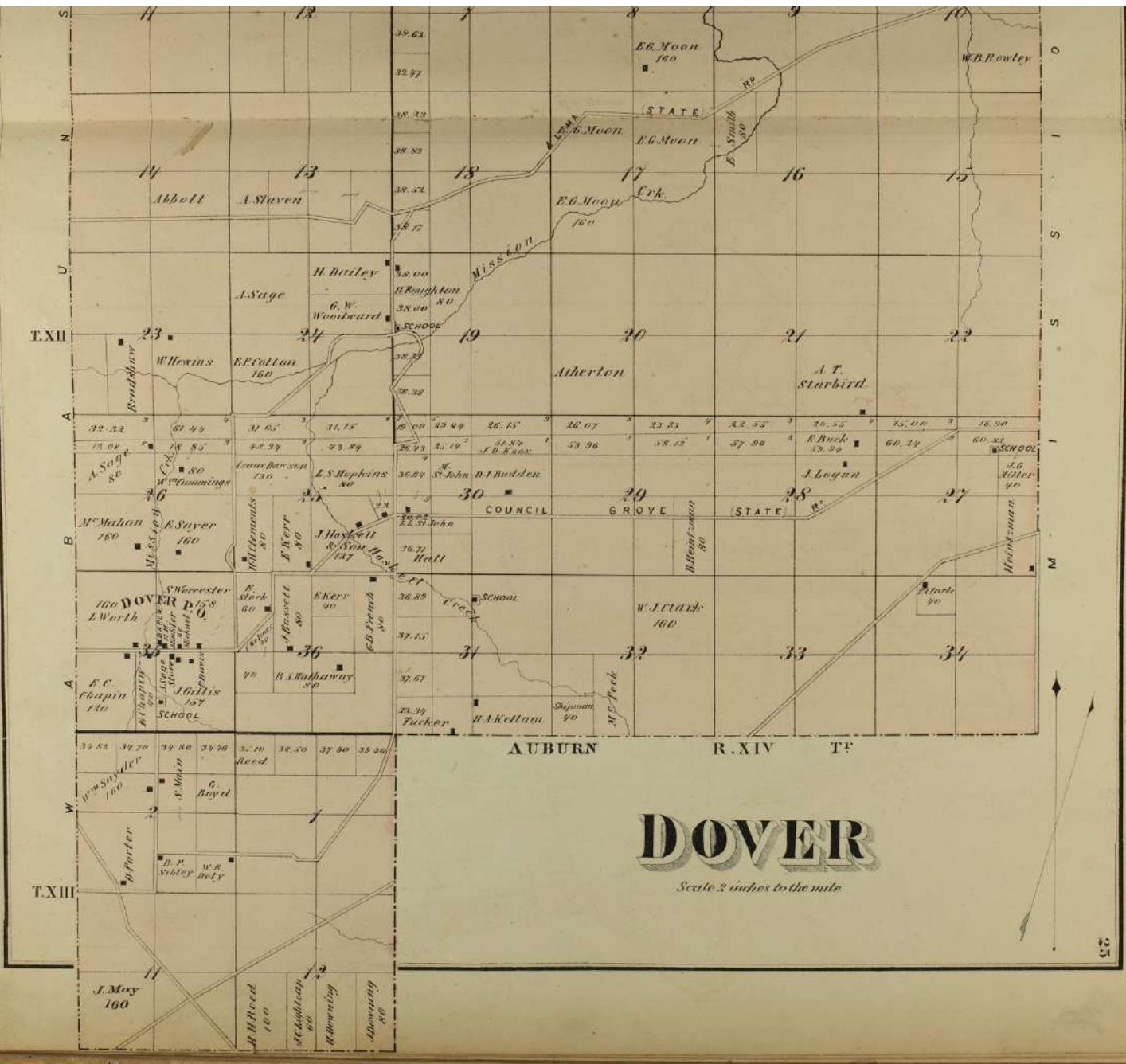

DOVER

Scale 2 inches to the rule

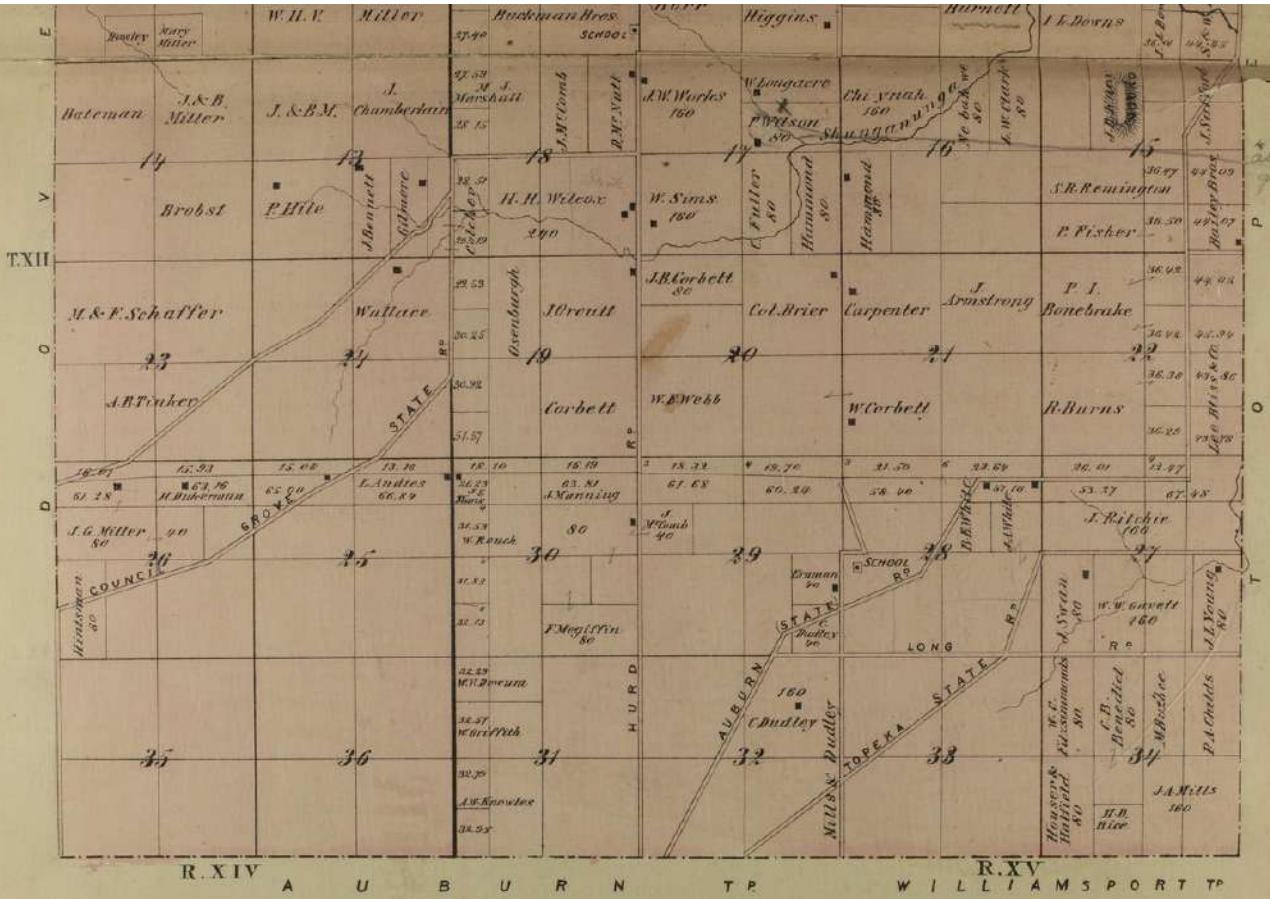

TOPEKA

Scale two inches to the mile

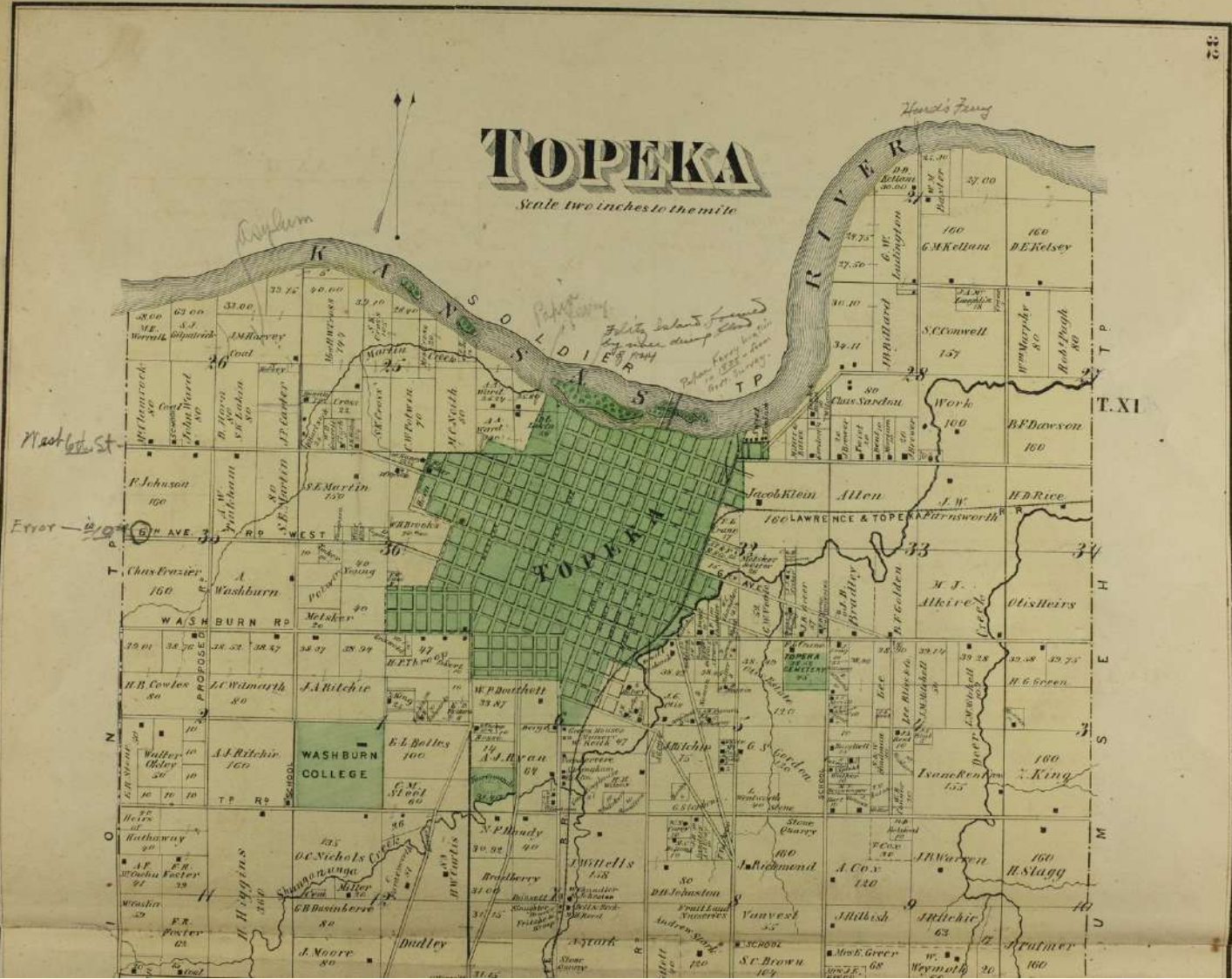

T. XI

H
S
E
M
D

North St

Erroy - 210

Map labels and owner names include:

- Streets: Washburn College, Lawrence & Topeka, Washburn Rd, West, etc.
- Owners: F. Johnson, A. Washburn, J.A. Ritchie, E.L. Bolles, A.J. Ryan, W.P. Boothell, J. Mitchell, J. Richmond, A. Cox, J.R. Warren, H. Slagg, etc.
- Other labels: Hands Ferry, Soldiers, etc.

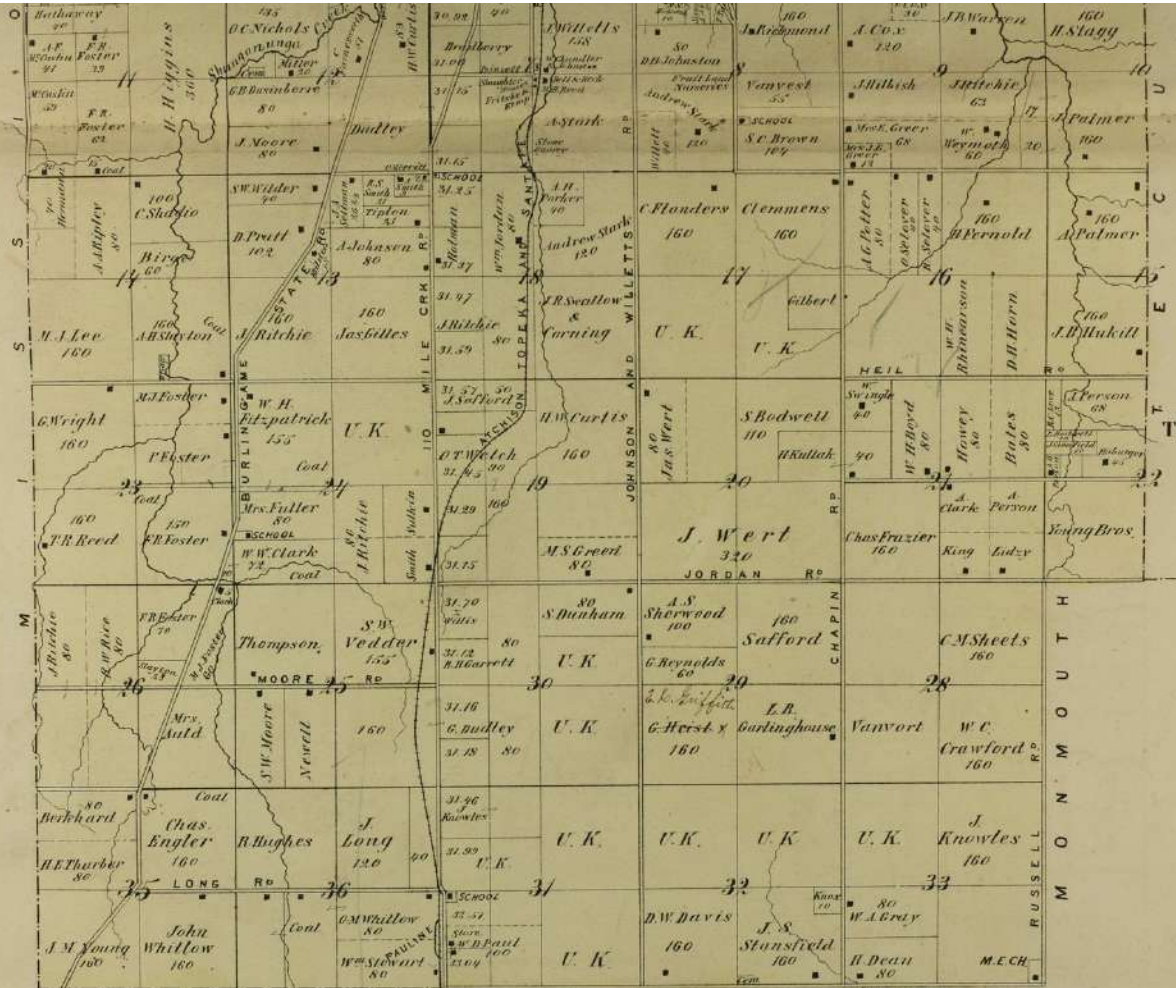

T. XII

R. XV WILLIAMS RAILROAD R. XVI

Mining Club.

MAP OF THE CITY OF TOPEKA

SHAWNEE CO.

Part of 1st Ward.

Scale 2 inches to the mile

*This locality named
by the name of "Grant land"
for Indian sold to white in 1820*



*Belonged to John R. Ellin -
2nd - late
1870s + early
1880s*

NORRIM

Water
KANSAS
RAIL ROAD ST.
SOUTH
PACIFIC RAILWAY

Cattle
Yards
ST.

Saywell

B. & T. Van Horn

Kearney Street

AVE.

KANSAS ST.

ST.

ST.

ST.

ST.

ST.

ST.

ST.

ST.

ATLANTA & S. L. R. R.

ATLANTA & S. L. R. R.

There wasn't a house on east side of Kansas Ave. one north from Gordon to Soldier creek in 1860.

Old Rolling Mills built in here during 1874-5. Burned down about 1880 for 1881.

BRIDGE KANSAS R.R.

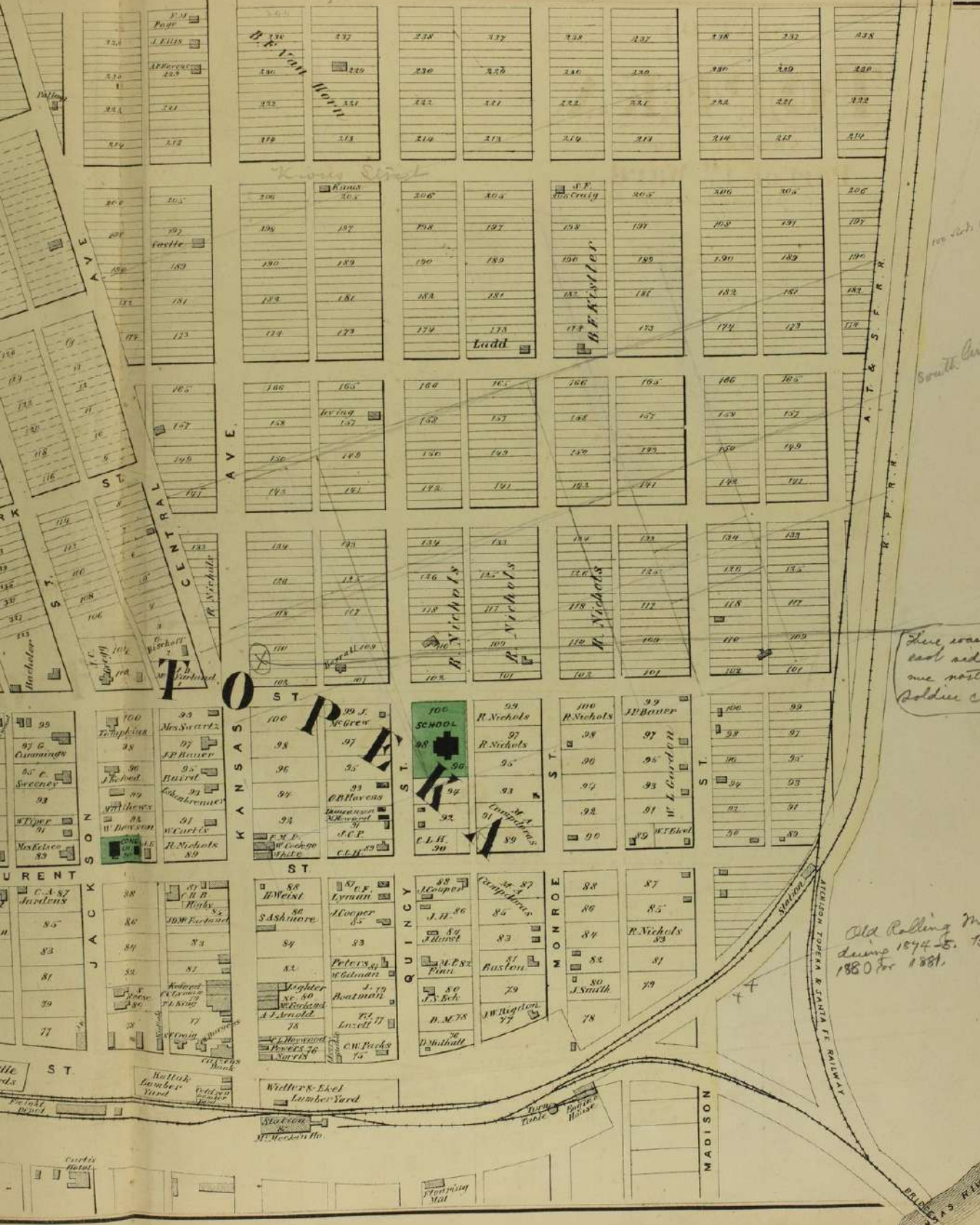

RAIL-ROAD ST.

40

1ST ST. CURTIS ST. 2ND ST.

ST.

AVE.

ST.

ST.

ST.

ST.

Freight Depot
W. Mcken House
STATION

78	77	76	75	74	73	72	71	70	69	68	67	66	65	64	63	62	61	60
W.C. Inv. Stable	W.C. Inv. Stable	W.C. Inv. Stable	W.C. Inv. Stable	W.C. Inv. Stable	W.C. Inv. Stable	W.C. Inv. Stable	W.C. Inv. Stable	W.C. Inv. Stable	W.C. Inv. Stable	W.C. Inv. Stable	W.C. Inv. Stable	W.C. Inv. Stable	W.C. Inv. Stable	W.C. Inv. Stable	W.C. Inv. Stable	W.C. Inv. Stable	W.C. Inv. Stable	W.C. Inv. Stable
E.W. Baker	E.W. Baker	E.W. Baker	E.W. Baker	E.W. Baker	E.W. Baker	E.W. Baker	E.W. Baker	E.W. Baker	E.W. Baker	E.W. Baker	E.W. Baker	E.W. Baker	E.W. Baker	E.W. Baker	E.W. Baker	E.W. Baker	E.W. Baker	E.W. Baker
E. Weinberger	E. Weinberger	E. Weinberger	E. Weinberger	E. Weinberger	E. Weinberger	E. Weinberger	E. Weinberger	E. Weinberger	E. Weinberger	E. Weinberger	E. Weinberger	E. Weinberger	E. Weinberger	E. Weinberger	E. Weinberger	E. Weinberger	E. Weinberger	E. Weinberger
E. W. Baker & Co	E. W. Baker & Co	E. W. Baker & Co	E. W. Baker & Co	E. W. Baker & Co	E. W. Baker & Co	E. W. Baker & Co	E. W. Baker & Co	E. W. Baker & Co	E. W. Baker & Co	E. W. Baker & Co	E. W. Baker & Co	E. W. Baker & Co	E. W. Baker & Co	E. W. Baker & Co	E. W. Baker & Co	E. W. Baker & Co	E. W. Baker & Co	E. W. Baker & Co



KANSAS

E. M. Crawford
CITY PARK

ST.

J. C. Patton

4TH

G. G. Gage

W

G. G. Gage

L. M. Crawford
N. P. Horton

Winchester
G. G. Gage

Capitol Mills

42	41	40	39	38	37
19	18	17	16	15	14
32	31	30	29	28	27
40	39	38	37	36	35
30	29	28	27	26	25
34	33	32	31	30	29

TYLER

TOPEKA

1	2	3	4	5	6
14	13	12	11	10	9
18	17	16	15	14	13
22	21	20	19	18	17
26	25	24	23	22	21
30	29	28	27	26	25

HARRISON

23	22	21	20	19	18
14	13	12	11	10	9
18	17	16	15	14	13
22	21	20	19	18	17
26	25	24	23	22	21
30	29	28	27	26	25

VANBUREN

19	18	17	16	15	14
28	27	26	25	24	23
32	31	30	29	28	27
36	35	34	33	32	31
40	39	38	37	36	35
44	43	42	41	40	39

JACKSON

23	22	21	20	19	18
14	13	12	11	10	9
18	17	16	15	14	13
22	21	20	19	18	17
26	25	24	23	22	21
30	29	28	27	26	25

2ND

40	39	38	37	36	35
26	25	24	23	22	21
30	29	28	27	26	25
34	33	32	31	30	29
38	37	36	35	34	33
42	41	40	39	38	37

38	37	36	35	34	33
42	41	40	39	38	37
46	45	44	43	42	41
40	39	38	37	36	35
44	43	42	41	40	39
48	47	46	45	44	43

38	37	36	35	34	33
42	41	40	39	38	37
46	45	44	43	42	41
40	39	38	37	36	35
44	43	42	41	40	39
48	47	46	45	44	43

38	37	36	35	34	33
42	41	40	39	38	37
46	45	44	43	42	41
40	39	38	37	36	35
44	43	42	41	40	39
48	47	46	45	44	43

38	37	36	35	34	33
42	41	40	39	38	37
46	45	44	43	42	41
40	39	38	37	36	35
44	43	42	41	40	39
48	47	46	45	44	43

38	37	36	35	34	33
42	41	40	39	38	37
46	45	44	43	42	41
40	39	38	37	36	35
44	43	42	41	40	39
48	47	46	45	44	43

38	37	36	35	34	33
42	41	40	39	38	37
46	45	44	43	42	41
40	39	38	37	36	35
44	43	42	41	40	39
48	47	46	45	44	43

TOPEKA

SHAWNEE CO.

Part of 1st, 2nd & 4th Ward.

Scale 4 inches to the mile

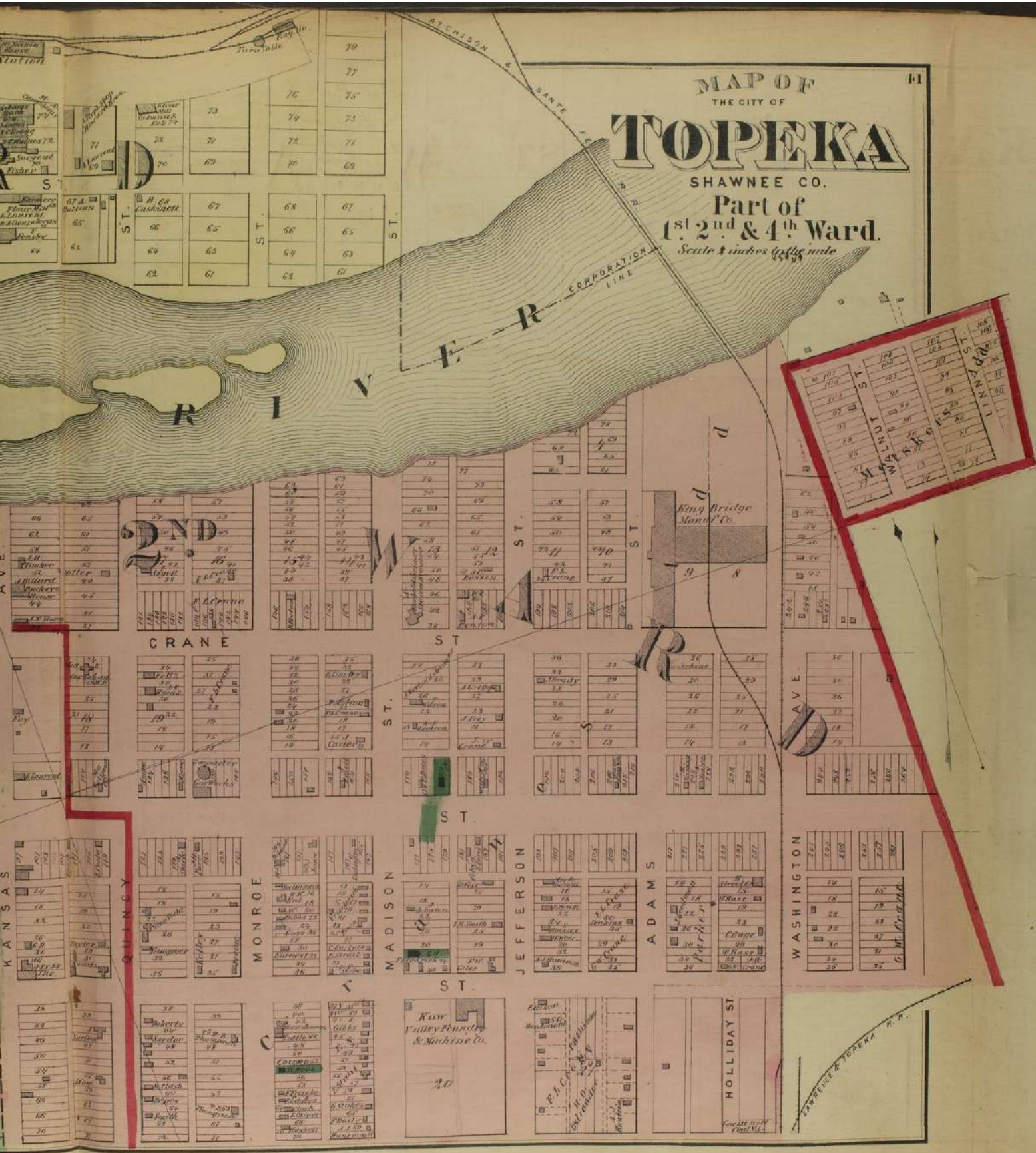

74 78 82 86 90 94 98 102 106 110	76 80 84 88 92 96 100 104 108	78 82 86 90 94 98 102 106 110	80 84 88 92 96 100 104 108	82 86 90 94 98 102 106 110	84 88 92 96 100 104 108	86 90 94 98 102 106 110	88 92 96 100 104 108	90 94 98 102 106 110	92 96 100 104 108	94 98 102 106 110	96 100 104 108	98 102 106 110	100 104 108	102 106 110	104 108	106 110	108 112	110 114	112 116	114 118	116 120	118 122	120 124	122 126	124 128	126 130	128 132	130 134	132 136	134 138	136 140	138 142	140 144	142 146	144 148	146 150	148 152	150 154	152 156	154 158	156 160	158 162	160 164	162 166	164 168	166 170	168 172	170 174	172 176	174 178	176 180	178 182	180 184	182 186	184 188	186 190	188 192	190 194	192 196	194 198	196 200	198 202	200 204	202 206	204 208	206 210	208 212	210 214	212 216	214 218	216 220	218 222	220 224	222 226	224 228	226 230	228 232	230 234	232 236	234 238	236 240	238 242	240 244	242 246	244 248	246 250	248 252	250 254	252 256	254 258	256 260	258 262	260 264	262 266	264 268	266 270	268 272	270 274	272 276	274 278	276 280	278 282	280 284	282 286	284 288	286 290	288 292	290 294	292 296	294 298	296 300	298 302	300 304	302 306	304 308	306 310	308 312	310 314	312 316	314 318	316 320	318 322	320 324	322 326	324 328	326 330	328 332	330 334	332 336	334 338	336 340	338 342	340 344	342 346	344 348	346 350	348 352	350 354	352 356	354 358	356 360	358 362	360 364	362 366	364 368	366 370	368 372	370 374	372 376	374 378	376 380	378 382	380 384	382 386	384 388	386 390	388 392	390 394	392 396	394 398	396 400	398 402	400 404	402 406	404 408	406 410	408 412	410 414	412 416	414 418	416 420	418 422	420 424	422 426	424 428	426 430	428 432	430 434	432 436	434 438	436 440	438 442	440 444	442 446	444 448	446 450	448 452	450 454	452 456	454 458	456 460	458 462	460 464	462 466	464 468	466 470	468 472	470 474	472 476	474 478	476 480	478 482	480 484	482 486	484 488	486 490	488 492	490 494	492 496	494 498	496 500	498 502	500 504	502 506	504 508	506 510	508 512	510 514	512 516	514 518	516 520	518 522	520 524	522 526	524 528	526 530	528 532	530 534	532 536	534 538	536 540	538 542	540 544	542 546	544 548	546 550	548 552	550 554	552 556	554 558	556 560	558 562	560 564	562 566	564 568	566 570	568 572	570 574	572 576	574 578	576 580	578 582	580 584	582 586	584 588	586 590	588 592	590 594	592 596	594 598	596 600	598 602	600 604	602 606	604 608	606 610	608 612	610 614	612 616	614 618	616 620	618 622	620 624	622 626	624 628	626 630	628 632	630 634	632 636	634 638	636 640	638 642	640 644	642 646	644 648	646 650	648 652	650 654	652 656	654 658	656 660	658 662	660 664	662 666	664 668	666 670	668 672	670 674	672 676	674 678	676 680	678 682	680 684	682 686	684 688	686 690	688 692	690 694	692 696	694 698	696 700	698 702	700 704	702 706	704 708	706 710	708 712	710 714	712 716	714 718	716 720	718 722	720 724	722 726	724 728	726 730	728 732	730 734	732 736	734 738	736 740	738 742	740 744	742 746	744 748	746 750	748 752	750 754	752 756	754 758	756 760	758 762	760 764	762 766	764 768	766 770	768 772	770 774	772 776	774 778	776 780	778 782	780 784	782 786	784 788	786 790	788 792	790 794	792 796	794 798	796 800	798 802	800 804	802 806	804 808	806 810	808 812	810 814	812 816	814 818	816 820	818 822	820 824	822 826	824 828	826 830	828 832	830 834	832 836	834 838	836 840	838 842	840 844	842 846	844 848	846 850	848 852	850 854	852 856	854 858	856 860	858 862	860 864	862 866	864 868	866 870	868 872	870 874	872 876	874 878	876 880	878 882	880 884	882 886	884 888	886 890	888 892	890 894	892 896	894 898	896 900	898 902	900 904	902 906	904 908	906 910	908 912	910 914	912 916	914 918	916 920	918 922	920 924	922 926	924 928	926 930	928 932	930 934	932 936	934 938	936 940	938 942	940 944	942 946	944 948	946 950	948 952	950 954	952 956	954 958	956 960	958 962	960 964	962 966	964 968	966 970	968 972	970 974	972 976	974 978	976 980	978 982	980 984	982 986	984 988	986 990	988 992	990 994	992 996	994 998	996 1000
---	---	---	---	---	---	---	-------------------------------------	-------------------------------------	-------------------------------	-------------------------------	-------------------------	-------------------------	-------------------	-------------------	------------	------------	------------	------------	------------	------------	------------	------------	------------	------------	------------	------------	------------	------------	------------	------------	------------	------------	------------	------------	------------	------------	------------	------------	------------	------------	------------	------------	------------	------------	------------	------------	------------	------------	------------	------------	------------	------------	------------	------------	------------	------------	------------	------------	------------	------------	------------	------------	------------	------------	------------	------------	------------	------------	------------	------------	------------	------------	------------	------------	------------	------------	------------	------------	------------	------------	------------	------------	------------	------------	------------	------------	------------	------------	------------	------------	------------	------------	------------	------------	------------	------------	------------	------------	------------	------------	------------	------------	------------	------------	------------	------------	------------	------------	------------	------------	------------	------------	------------	------------	------------	------------	------------	------------	------------	------------	------------	------------	------------	------------	------------	------------	------------	------------	------------	------------	------------	------------	------------	------------	------------	------------	------------	------------	------------	------------	------------	------------	------------	------------	------------	------------	------------	------------	------------	------------	------------	------------	------------	------------	------------	------------	------------	------------	------------	------------	------------	------------	------------	------------	------------	------------	------------	------------	------------	------------	------------	------------	------------	------------	------------	------------	------------	------------	------------	------------	------------	------------	------------	------------	------------	------------	------------	------------	------------	------------	------------	------------	------------	------------	------------	------------	------------	------------	------------	------------	------------	------------	------------	------------	------------	------------	------------	------------	------------	------------	------------	------------	------------	------------	------------	------------	------------	------------	------------	------------	------------	------------	------------	------------	------------	------------	------------	------------	------------	------------	------------	------------	------------	------------	------------	------------	------------	------------	------------	------------	------------	------------	------------	------------	------------	------------	------------	------------	------------	------------	------------	------------	------------	------------	------------	------------	------------	------------	------------	------------	------------	------------	------------	------------	------------	------------	------------	------------	------------	------------	------------	------------	------------	------------	------------	------------	------------	------------	------------	------------	------------	------------	------------	------------	------------	------------	------------	------------	------------	------------	------------	------------	------------	------------	------------	------------	------------	------------	------------	------------	------------	------------	------------	------------	------------	------------	------------	------------	------------	------------	------------	------------	------------	------------	------------	------------	------------	------------	------------	------------	------------	------------	------------	------------	------------	------------	------------	------------	------------	------------	------------	------------	------------	------------	------------	------------	------------	------------	------------	------------	------------	------------	------------	------------	------------	------------	------------	------------	------------	------------	------------	------------	------------	------------	------------	------------	------------	------------	------------	------------	------------	------------	------------	------------	------------	------------	------------	------------	------------	------------	------------	------------	------------	------------	------------	------------	------------	------------	------------	------------	------------	------------	------------	------------	------------	------------	------------	------------	------------	------------	------------	------------	------------	------------	------------	------------	------------	------------	------------	------------	------------	------------	------------	------------	------------	------------	------------	------------	------------	------------	------------	------------	------------	------------	------------	------------	------------	------------	------------	------------	------------	------------	------------	------------	------------	------------	------------	------------	------------	------------	------------	------------	------------	------------	------------	------------	------------	------------	------------	------------	------------	------------	------------	------------	------------	------------	------------	------------	------------	------------	------------	------------	------------	------------	------------	------------	------------	------------	------------	------------	-------------

MAP OF
THE CITY OF
TOPEKA
SHAWNEE CO.
Part of
2nd 3rd & 4th Ward.
Scale 250 feet to the inch

107 108 109 110 111 112 113 114 115 116 117 118 119 120 121 122 123 124 125 126 127 128 129 130 131 132 133 134 135 136 137 138 139 140 141 142 143 144 145 146 147 148 149 150 151 152 153 154 155 156 157 158 159 160 161 162 163 164 165 166 167 168 169 170 171 172 173 174 175 176 177 178 179 180 181 182 183 184 185 186 187 188 189 190 191 192 193 194 195 196 197 198 199 200 201 202 203 204 205 206 207 208 209 210 211 212 213 214 215 216 217 218 219 220 221 222 223 224 225 226 227 228 229 230 231 232 233 234 235 236 237 238 239 240 241 242 243 244 245 246 247 248 249 250 251 252 253 254 255 256 257 258 259 260 261 262 263 264 265 266 267 268 269 270 271 272 273 274 275 276 277 278 279 280 281 282 283 284 285 286 287 288 289 290 291 292 293 294 295 296 297 298 299 300 301 302 303 304 305 306 307 308 309 310 311 312 313 314 315 316 317 318 319 320 321 322 323 324 325 326 327 328 329 330 331 332 333 334 335 336 337 338 339 340 341 342 343 344 345 346 347 348 349 350 351 352 353 354 355 356 357 358 359 360 361 362 363 364 365 366 367 368 369 370 371 372 373 374 375 376 377 378 379 380 381 382 383 384 385 386 387 388 389 390 391 392 393 394 395 396 397 398 399 400 401 402 403 404 405 406 407 408 409 410 411 412 413 414 415 416 417 418 419 420 421 422 423 424 425 426 427 428 429 430 431 432 433 434 435 436 437 438 439 440 441 442 443 444 445 446 447 448 449 450 451 452 453 454 455 456 457 458 459 460 461 462 463 464 465 466 467 468 469 470 471 472 473 474 475 476 477 478 479 480 481 482 483 484 485 486 487 488 489 490 491 492 493 494 495 496 497 498 499 500 501 502 503 504 505 506 507 508 509 510 511 512 513 514 515 516 517 518 519 520 521 522 523 524 525 526 527 528 529 530 531 532 533 534 535 536 537 538 539 540 541 542 543 544 545 546 547 548 549 550 551 552 553 554 555 556 557 558 559 560 561 562 563 564 565 566 567 568 569 570 571 572 573 574 575 576 577 578 579 580 581 582 583 584 585 586 587 588 589 590 591 592 593 594 595 596 597 598 599 600 601 602 603 604 605 606 607 608 609 610 611 612 613 614 615 616 617 618 619 620 621 622 623 624 625 626 627 628 629 630 631 632 633 634 635 636 637 638 639 640 641 642 643 644 645 646 647 648 649 650 651 652 653 654 655 656 657 658 659 660 661 662 663 664 665 666 667 668 669 670 671 672 673 674 675 676 677 678 679 680 681 682 683 684 685 686 687 688 689 690 691 692 693 694 695 696 697 698 699 700 701 702 703 704 705 706 707 708 709 710 711 712 713 714 715 716 717 718 719 720 721 722 723 724 725 726 727 728 729 730 731 732 733 734 735 736 737 738 739 740 741 742 743 744 745 746 747 748 749 750 751 752 753 754 755 756 757 758 759 760 761 762 763 764 765 766 767 768 769 770 771 772 773 774 775 776 777 778 779 780 781 782 783 784 785 786 787 788 789 790 791 792 793 794 795 796 797 798 799 800 801 802 803 804 805 806 807 808 809 810 811 812 813 814 815 816 817 818 819 820 821 822 823 824 825 826 827 828 829 830 831 832 833 834 835 836 837 838 839 840 841 842 843 844 845 846 847 848 849 850 851 852 853 854 855 856 857 858 859 860 861 862 863 864 865 866 867 868 869 870 871 872 873 874 875 876 877 878 879 880 881 882 883 884 885 886 887 888 889 890 891 892 893 894 895 896 897 898 899 900 901 902 903 904 905 906 907 908 909 910 911 912 913 914 915 916 917 918 919 920 921 922 923 924 925 926 927 928 929 930 931 932 933 934 935 936 937 938 939 940 941 942 943 944 945 946 947 948 949 950 951 952 953 954 955 956 957 958 959 960 961 962 963 964 965 966 967 968 969 970 971 972 973 974 975 976 977 978 979 980 981 982 983 984 985 986 987 988 989 990 991 992 993 994 995 996 997 998 999 1000

COLLEGE
OF THE
SISTERS OF BETHANY

4 TH ST. Address ranges 74-107 on left, 110-143 on right.

5 TH ST. Address ranges 110-143 on left, 144-177 on right.

6 TH ST. Address ranges 144-177 on left, 178-211 on right.

7 TH ST. Address ranges 178-211 on left, 212-245 on right.

8 TH ST. Address ranges 212-245 on left, 246-279 on right.

9 TH ST. Address ranges 246-302 on left.

COLLEGE OF THE SISTERS OF BETHANY

9 TH ST. Address ranges 280-302 on right.

Vertical text 'S T.' and 'AVE.' labels on the left side of the 9th street grid.

Large green advertisement for the College of the Sisters of Bethany, featuring the college name and logo.

Vertical text 'S T.' and 'AVE.' labels on the right side of the 9th street grid.

72	73	74	75	76	77	78	79	80	81	82	83	84	85	86	87	88	89	90	91	92	93	94	95	96	97	98	99	100	
...

110	111	112	113	114	115	116	117	118	119	120	121	122	123	124	125	126	127	128	129	130	131	132	133	134	135	136	137	138	139	140
...

140	141	142	143	144	145	146	147	148	149	150	151	152	153	154	155	156	157	158	159	160	161	162	163	164	165	166	167	168	169	170
...

180	181	182	183	184	185	186	187	188	189	190	191	192	193	194	195	196	197	198	199	200	201	202	203	204	205	206	207	208	209	210
...

210	211	212	213	214	215	216	217	218	219	220	221	222	223	224	225	226	227	228	229	230	231	232	233	234	235	236	237	238	239	240
...

240	241	242	243	244	245	246	247	248	249	250	251	252	253	254	255	256	257	258	259	260	261	262	263	264	265	266	267	268	269	270
...

280	281	282	283	284	285	286	287	288	289	290	291	292	293	294	295	296	297	298	299	300	301	302	303	304	305	306	307	308	309	310
...

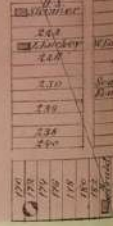
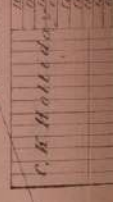
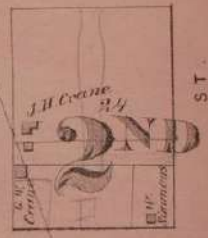

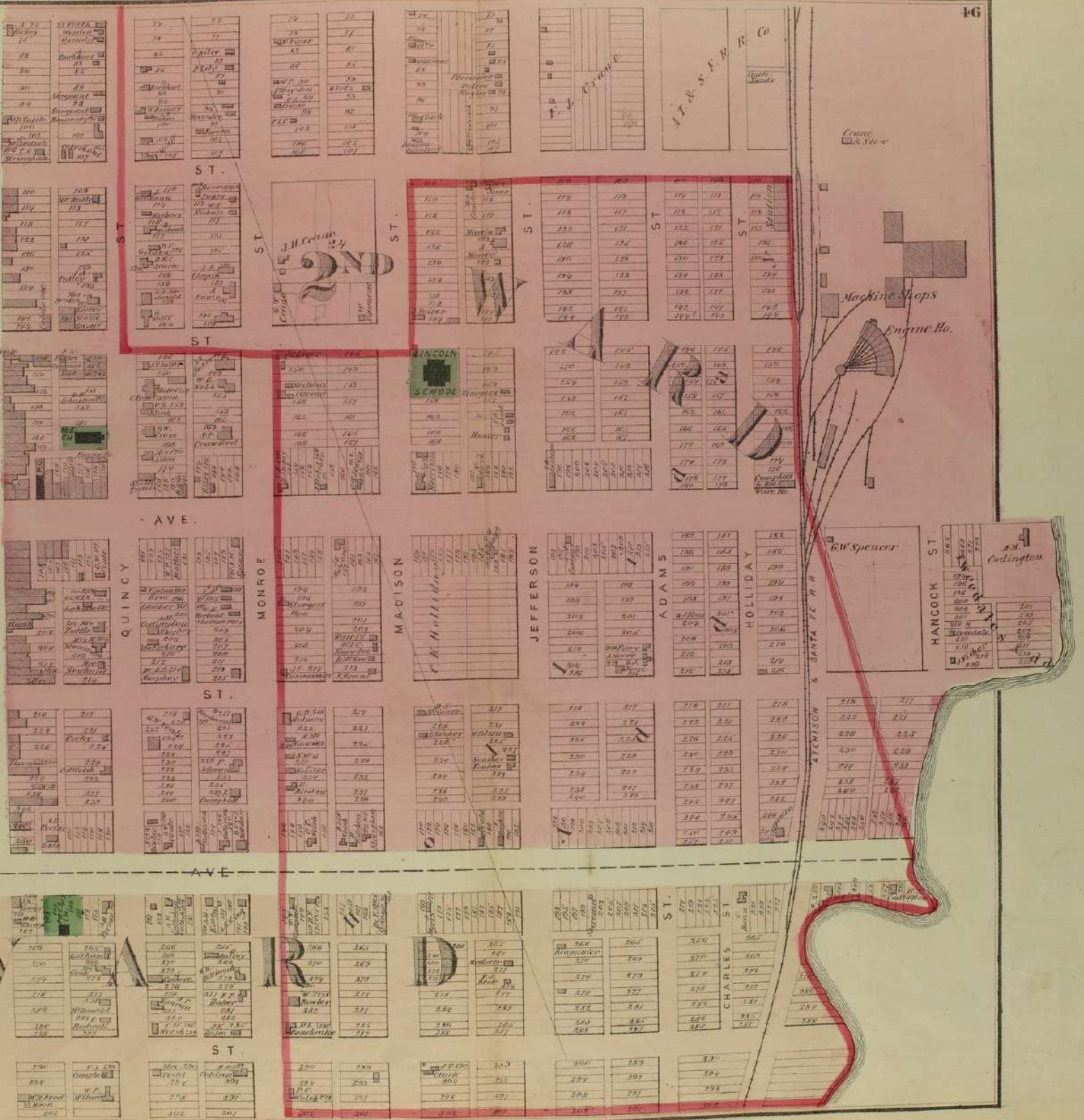

SISTERS OF BETHANY

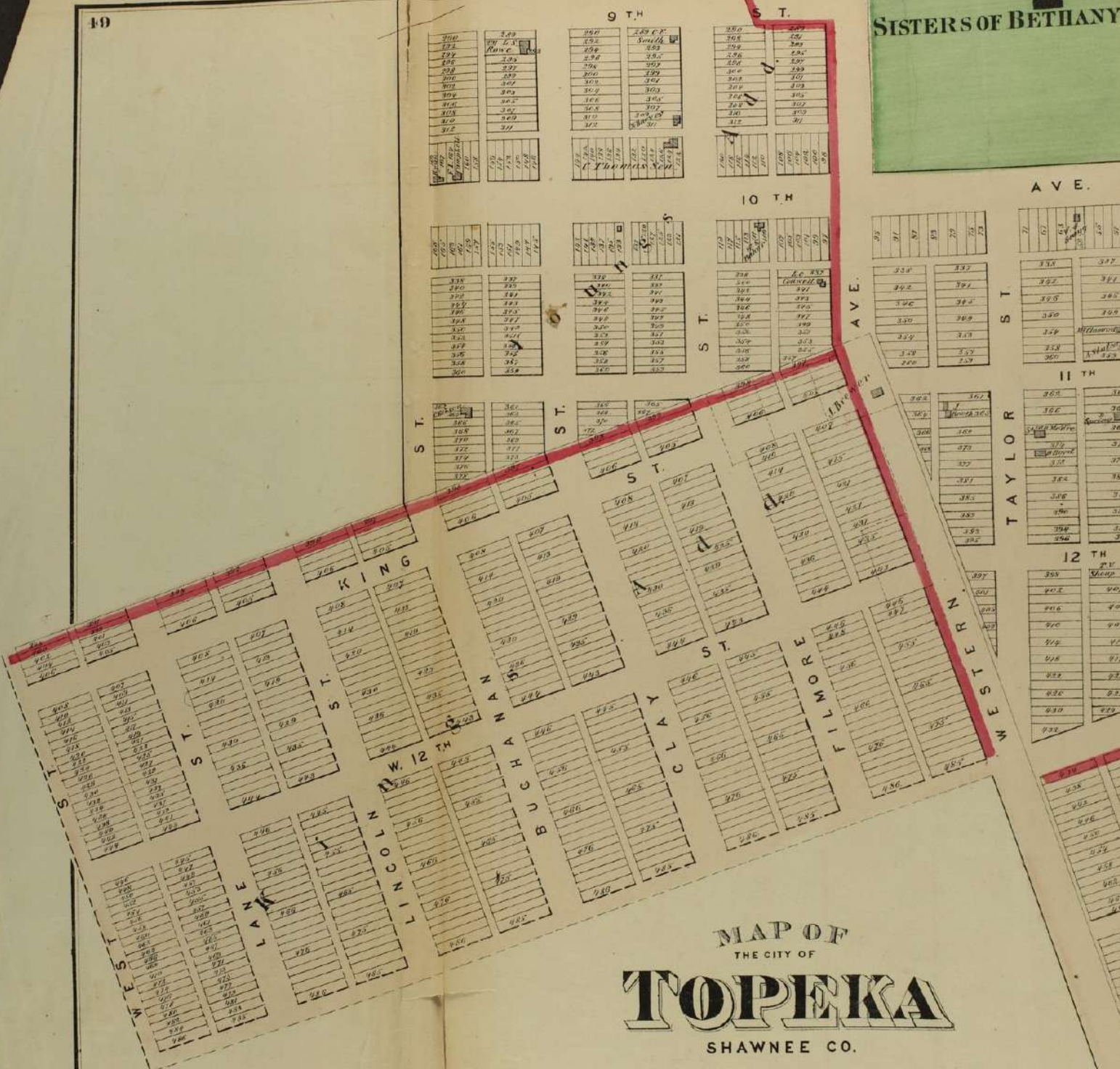

MAP OF
THE CITY OF
TOPEKA

SHAWNEE CO.

Part of 3rd Ward.

Scale 250 feet to the inch

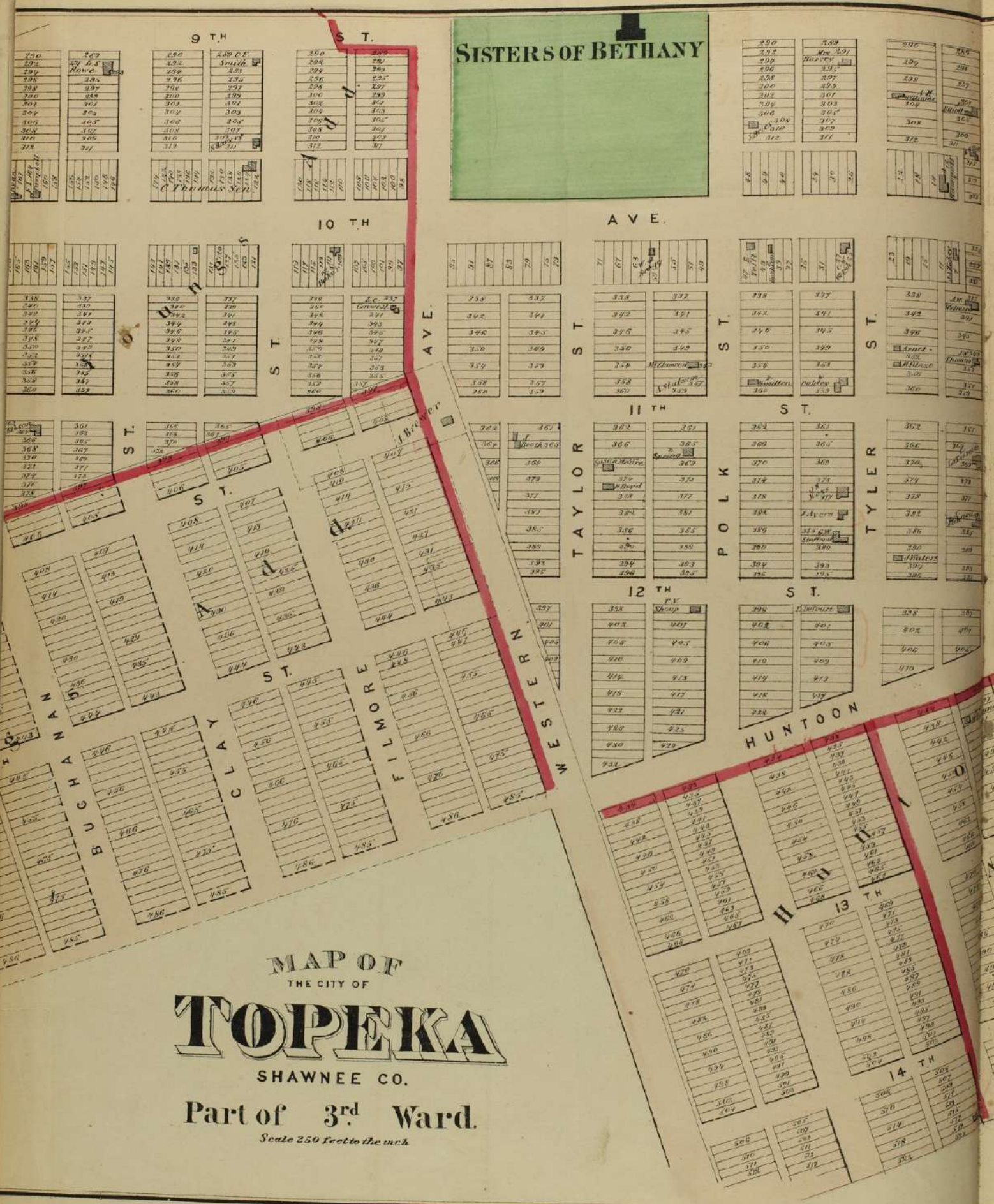

SISTERS OF BETHANY

9 TH ST.

10 TH ST.

AVE.

11 TH ST.

S T.

12 TH ST.

S T.

HUNTOON

13 TH ST.

14 TH ST.

MAP OF
THE CITY OF

TOPEKA

SHAWNEE CO.

Part of 3rd Ward.

Scale 250 feet to the inch.

TECUMSEH

Scale two inches to the mile



54

34

160

160

160

160

160

156

160

160

160

160

160

60

80

80

80

80

80

160

160

160

35

80

160

160

160

80

80

80

80

160

160

160

80

80

80

80

80

80

160

160

160

160

36

80

160

160

160

80

80

80

80

160

160

160

160

160

80

80

80

80

160

160

160

160

37

80

160

160

160

80

80

80

80

160

160

160

160

80

80

80

80

80

160

160

160

160

38

80

160

160

160

80

80

80

80

160

160

160

160

80

80

80

80

80

160

160

160

160

39

80

160

160

160

80

80

80

80

160

160

160

160

80

80

80

80

80

160

160

160

160

40

80

160

160

160

80

80

80

80

160

160

160

160

80

80

80

80

80

160

160

160

160

41

80

160

160

160

80

80

80

80

160

160

160

160

80

80

80

80

80

160

160

160

160

42

80

160

160

160

80

80

80

80

160

160

160

160

80

80

80

80

80

160

160

160

160

R XVI

M O N M O U T H T P.

AUBURN

Scale two inches to the mile



D O Z E R T P.

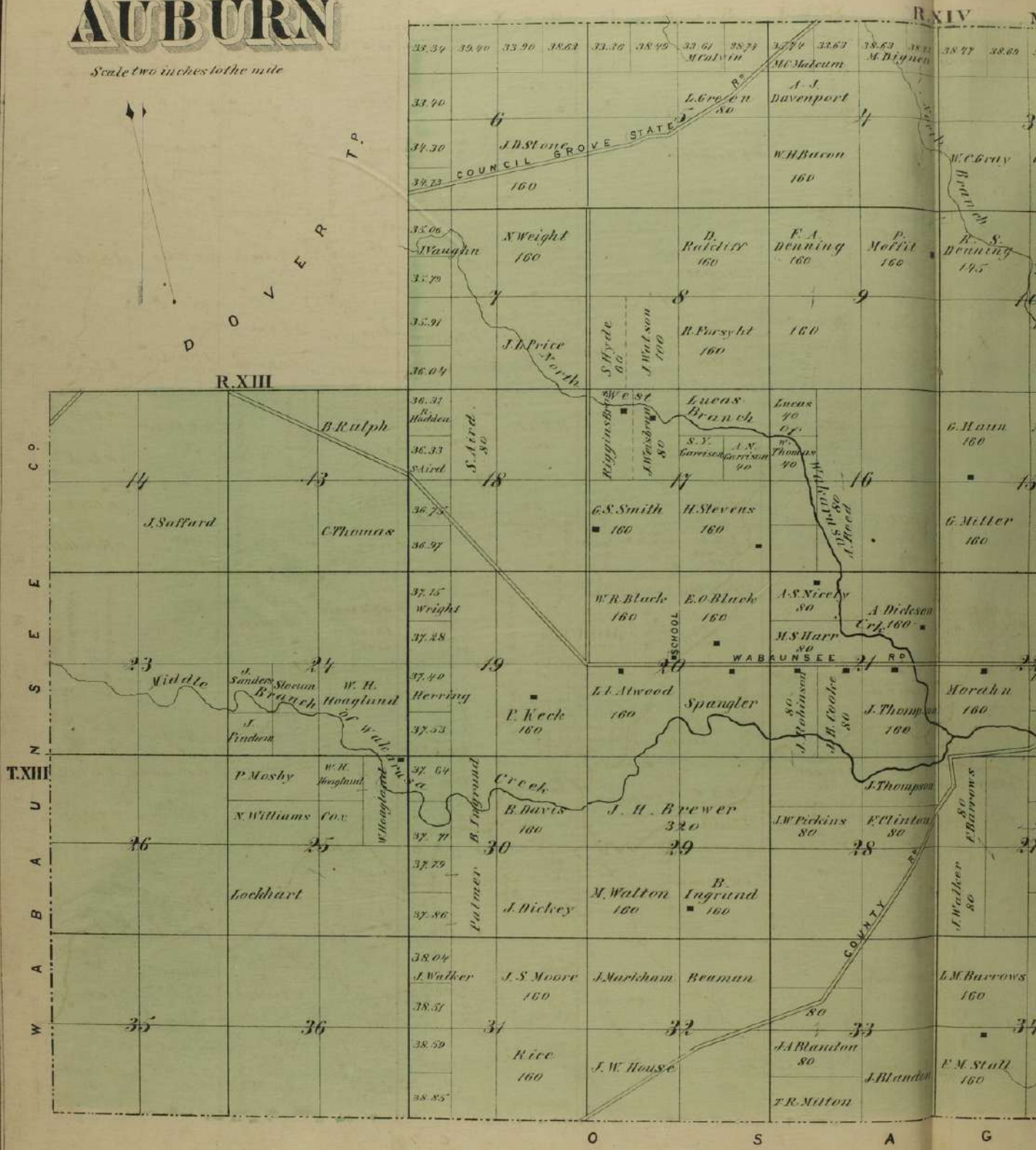

R. XIV M I S S I O N T E R. XV

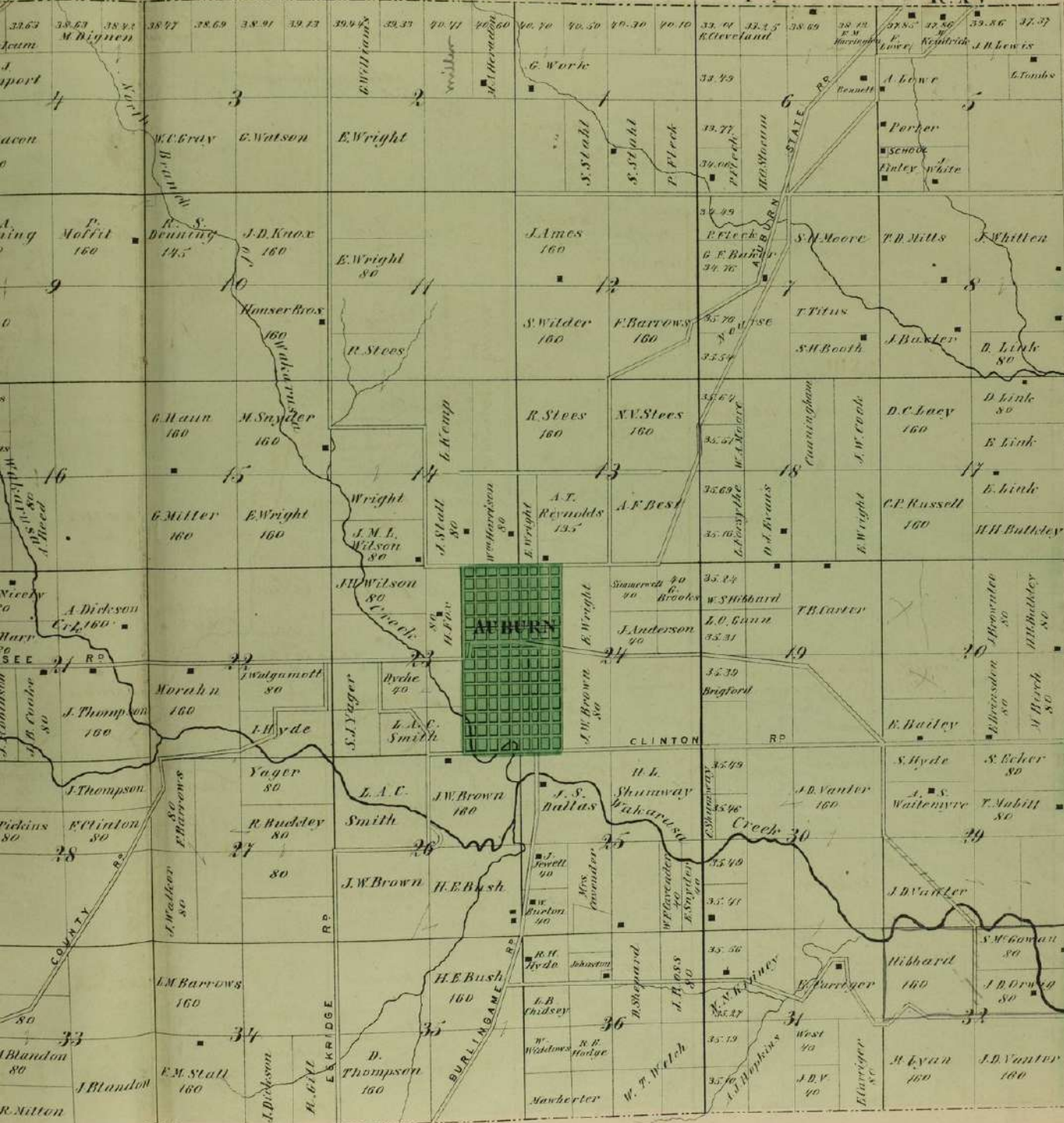

T P R T O R S P O R S I A M S I L L I W

WILLIAMSPORT

Scale two inches to the mile

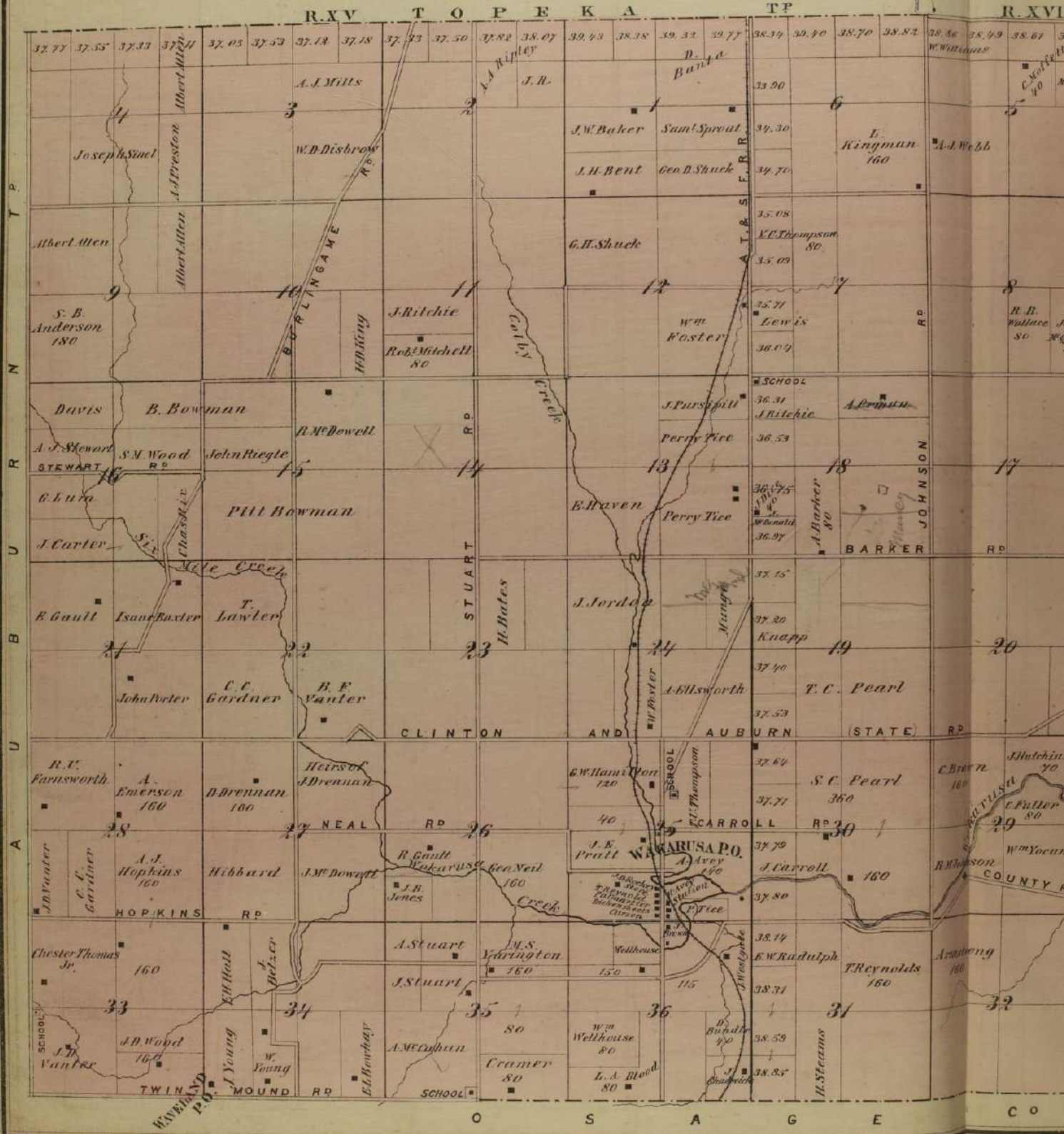

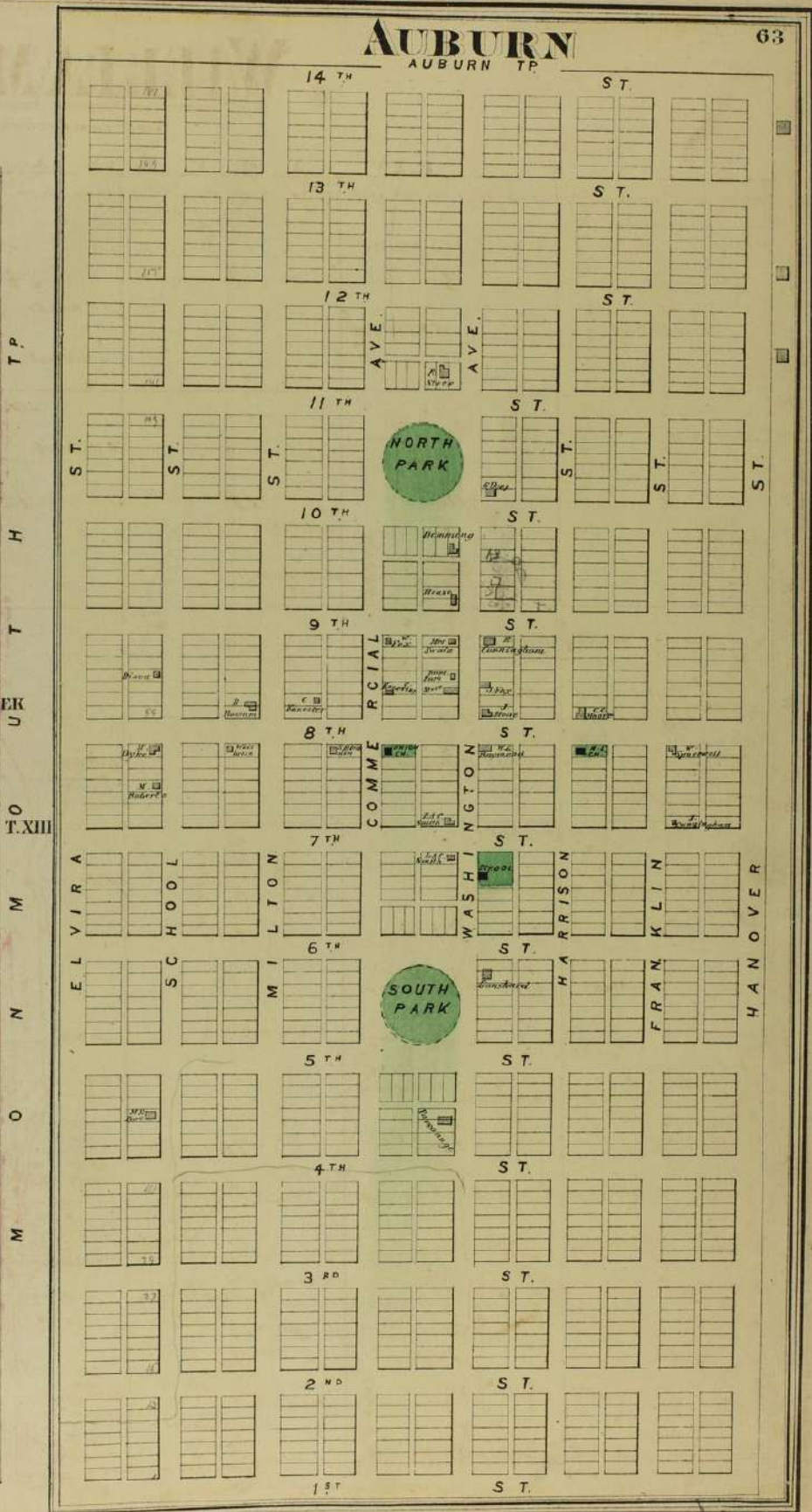
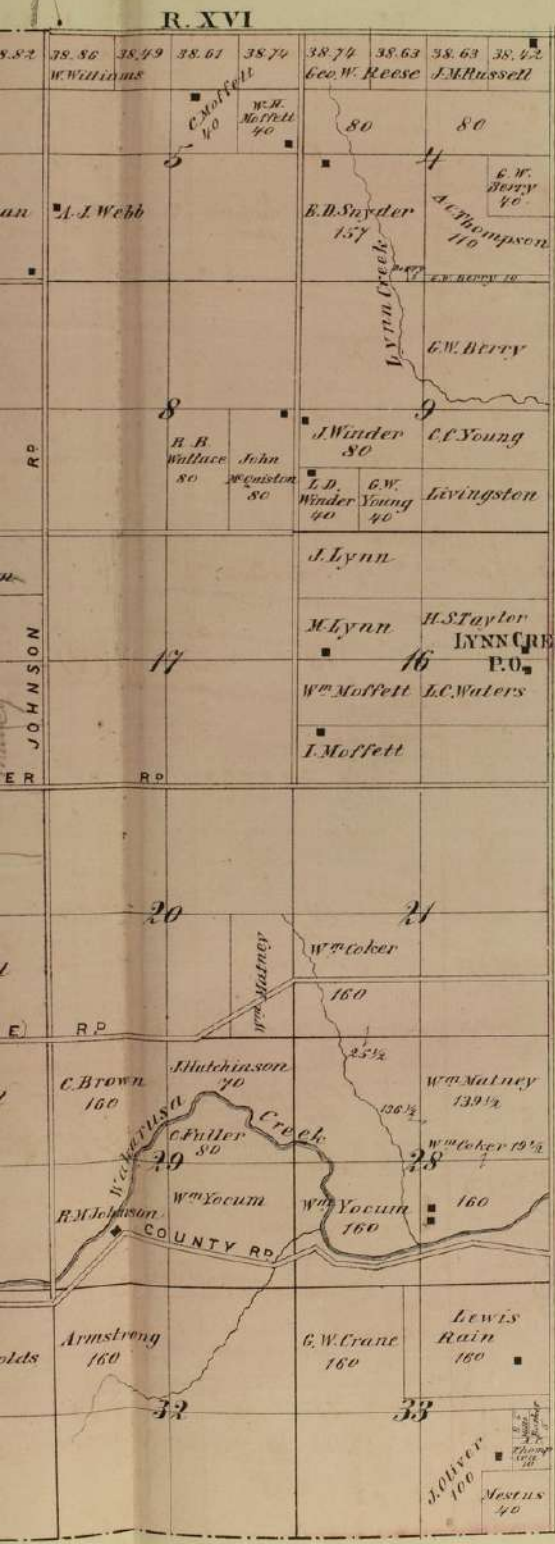

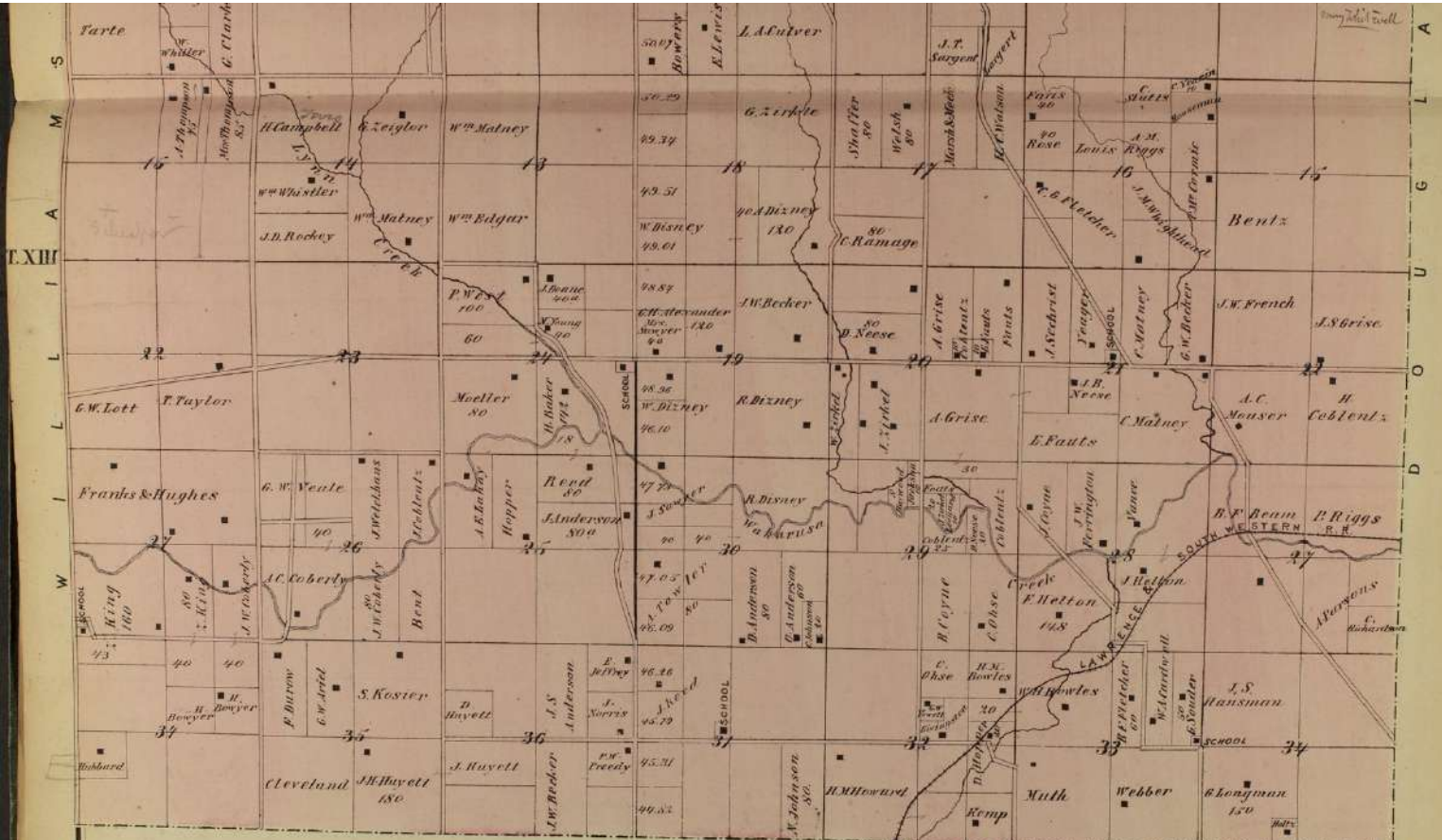

MONMOUTH

Scale two inches to the mile

SHAWNEE

GOODYEAR