

PLAT 800

OF

DONIPHAN

COUNTY

KANSAS.

COMPILED FROM COUNTY RECORDS AND ACTUAL SURVEYS.

PUBLISHED BY THE

NORTHWEST PUBLISHING CO.

MINNEAPOLIS, MINN.

1904

Printed by
HARRY ANGUS
AT 1001 10th St.

1625788

PLAT Book of Doniphan County, Kansas. Compiled
from County Records and actual Surveys. Min-
neapolis, Minn., Northwest Pub., Co., 1904.
3-56p. illus., maps. 45cm.

Sh A XSh Cf GrSh

ICN 68
M MSh W WSh Case G

TABLE OF CONTENTS

DONIPHAN COUNTY, KANSAS.

CIVIL TOWNSHIP MAPS.

	PAGE		PAGE
BIRCH OAK	12, 13, 24, 25	UNION	26
CENTER	8, 12, 17, 20	WAYNE	30, 32
IOWA	4, 5, 8	WOLF RIVER	16, 17, 30
MARION	20, 21, 32, 36	WASHINGTON	20, 24, 25

CONGRESSIONAL TOWNSHIPS.

TOWNSHIP	SOUTH	RANGE	EAST	PAGE	TOWNSHIP	SOUTH	RANGE	EAST	PAGE
1	20	19	20	4	3	21	21	20	20
2	19	19	20	5	3	22	21	21	24
2	20	19	20	6	3	23	21	21	25
2	21	19	20	7	4	19	21	21	26
2	22	19	20	8	4	20	21	21	27
3	19	19	20	9	4	21	21	21	28
3	20	19	20	10	4	22	21	21	29
				11	4	23	21	21	30
				12	5	21	21	21	31

CITIES AND TOWNS.

	PAGE		PAGE
BRENNER	31	LEONA	22
BENDENA (ALBENS)	22	MORAY (East Norway)	22
DONIPHAN	34 and 35	PALERMO	37
DENTONVILLE	27	PURCELL	27
ELWOOD	21	SEVERANCE	23
GEARY CITY	33	TROY	18 and 19
HIGHLAND	14 and 15	TROY JUNCTION (Maynari)	35
HIGHLAND STATION	30	WATENA	28 and 29
IOWA POINT	10 and 11	WHITE CLOUD	6 and 7

MISCELLANEOUS.

	PAGE		PAGE
OUTLINE MAP OF DONIPHAN COUNTY	3	SYSTEM OF GOVERNMENTAL SURVEYS	51
TABLE OF EXPLANATIONS	3	PRINCIPAL MERIDIANS AND BASE LINES	52 and 53
STATE MAP OF KANSAS	10 and 11	STANDARD TIME BELTS	52 and 53
UNITED STATES MAP	11 and 12	ROAD LAWS OF VARIOUS STATES	54
MAP OF THE WORLD	18 and 19	PATRONS' DIRECTORY	55 and 56

EXPLANATION

- Section line
- Range or lot line
- Water Course
- Railroad
- Creeks & Springs
- Houses
- Churches
- School Houses
- Adjoint lands owned by some parts connected by a track, thus
- Post Office
- Coal, Iron or Zinc Mine
- County Bridge

OUTLINE MAP OF
Doniphan County
 Scale 1/2 Inch to one Mile.
 1904
 KANSAS

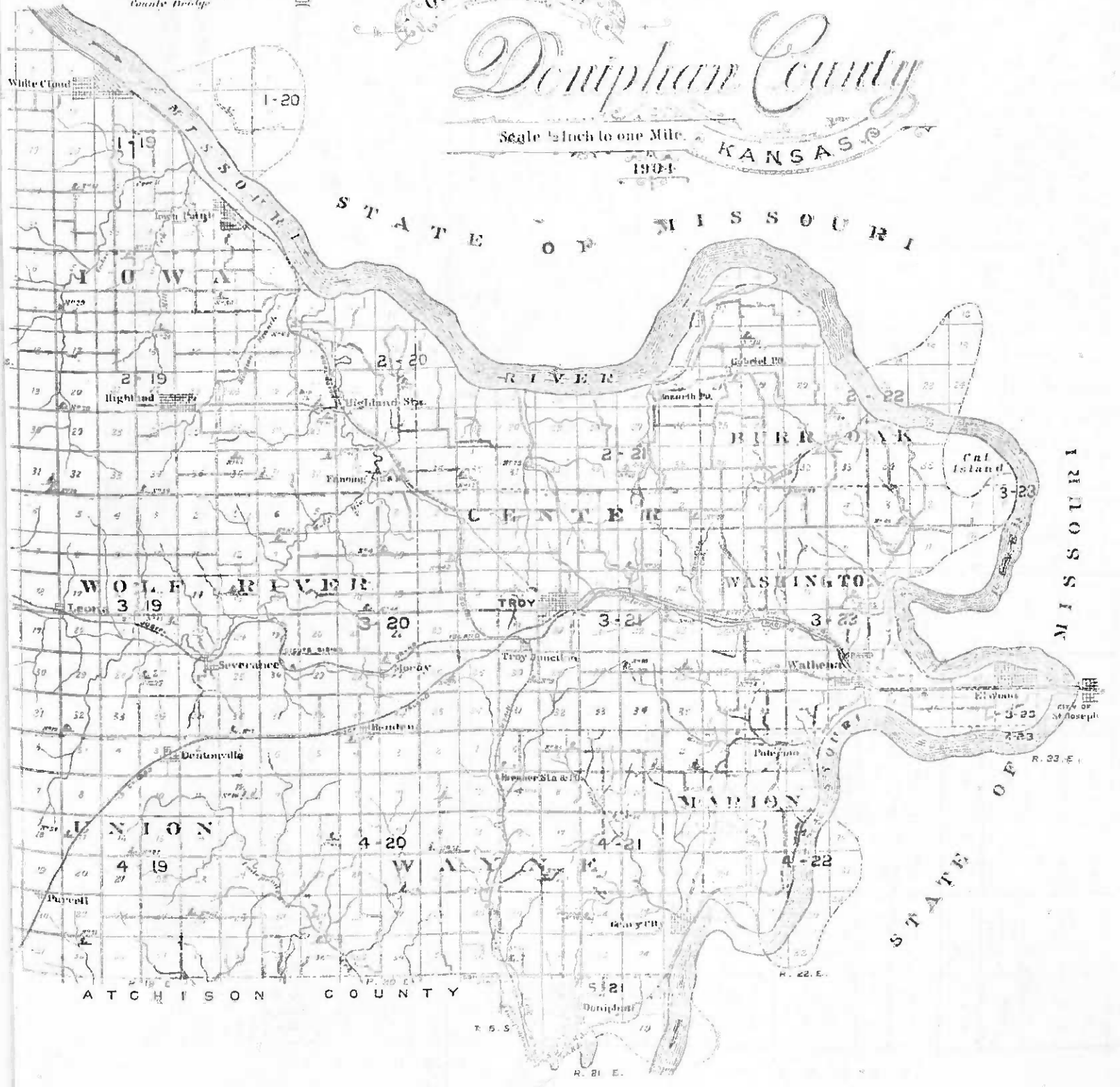

TOWNSHIP 1 SOUTH RANGES 19 & 20 EAST

Scale 2 Inches to the Mile.

of the 6th Principal Meridian.

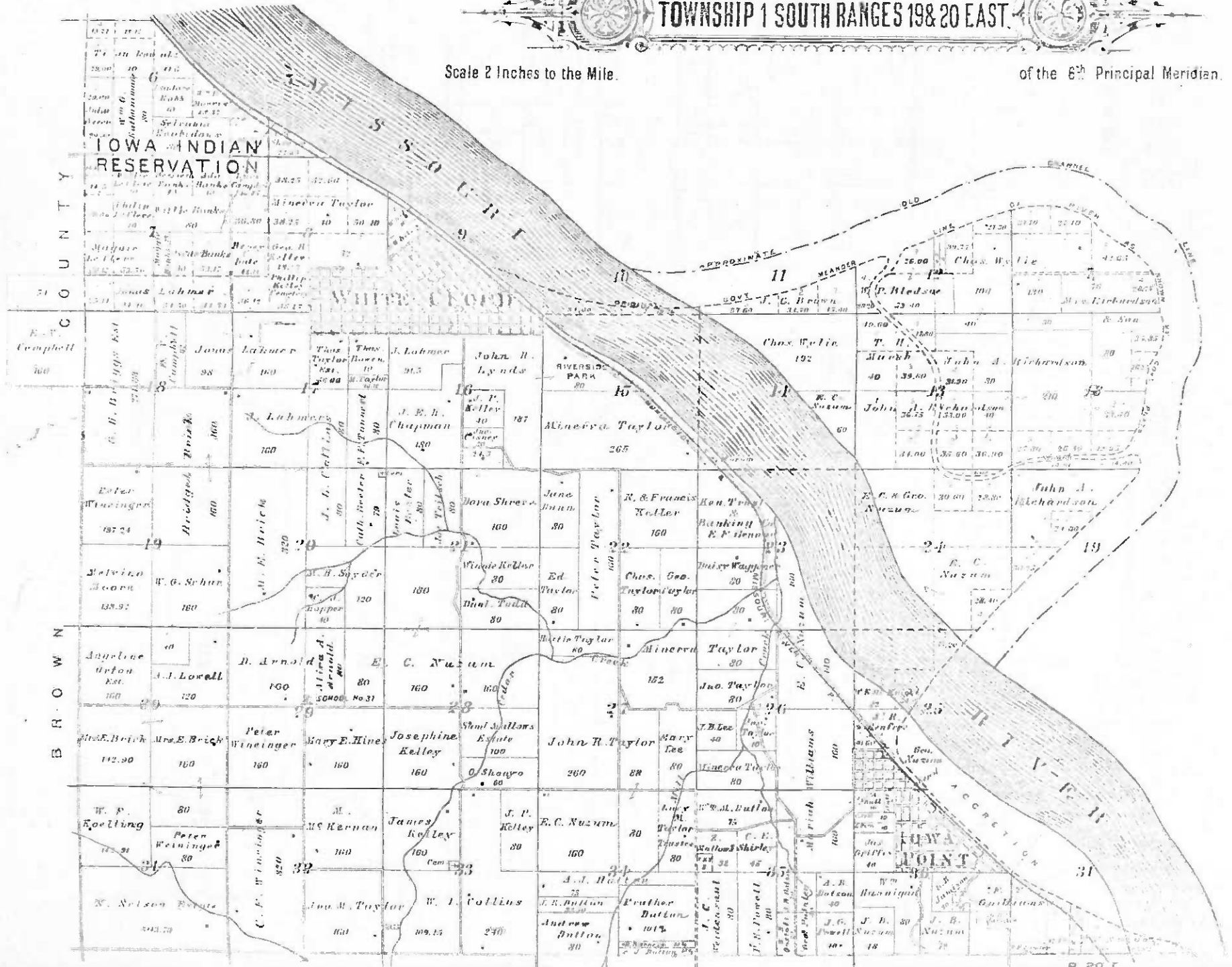

TOWNSHIP 2 SOUTH RANGE 19 EAST

5

Scale 2 Inches to the Mile.

of the 6th Principal Meridian.

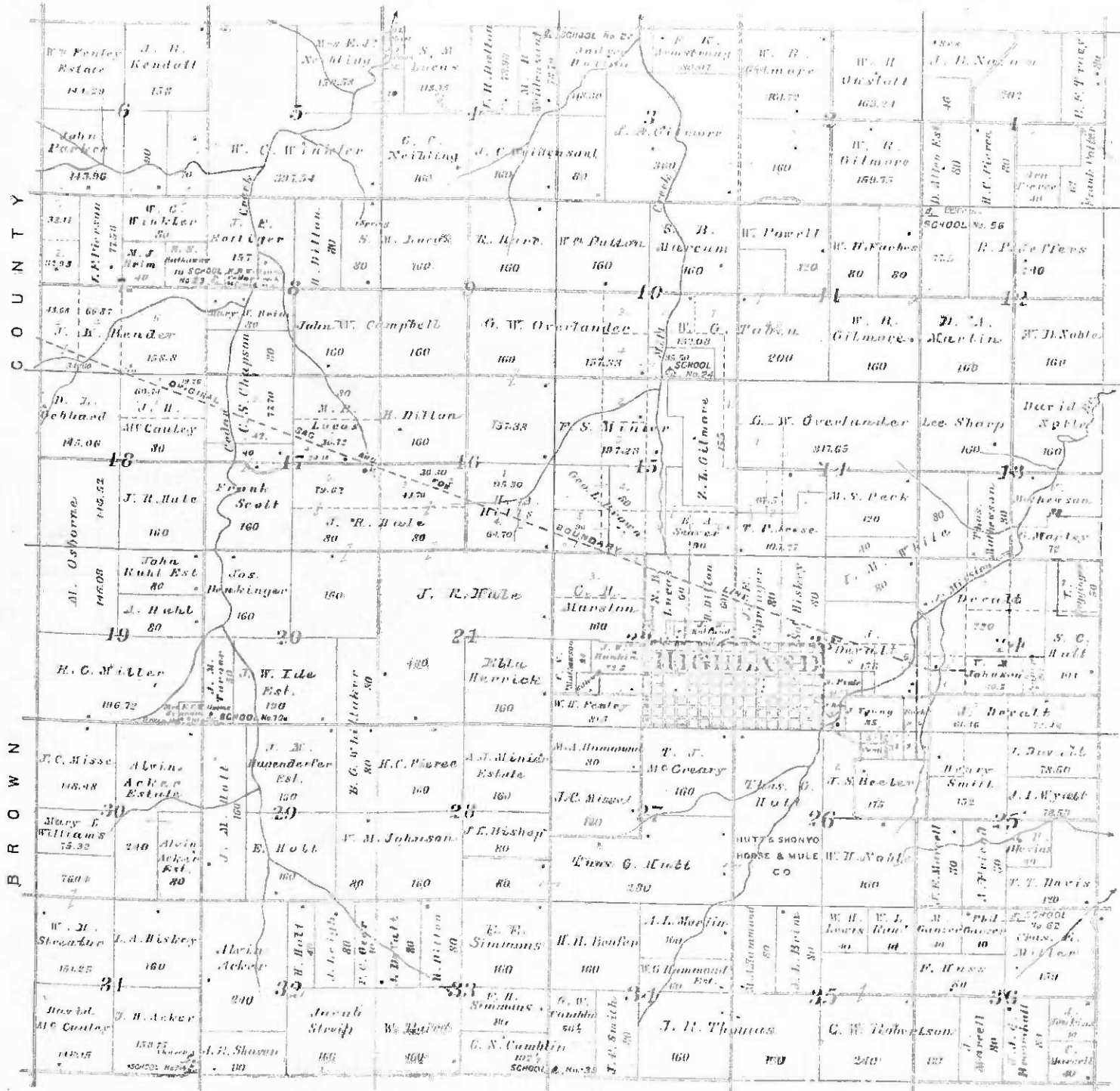

WHITE CLOUD

LOCATED IN IOWA TWP.

Scale 300 ft to 1 Inch

Albion Taylor

2370

Joseph White

Nicholas White



Thomas Taylor Est.

Thomas Bowen

J. Labrey

John H. Lynds

TOWNSHIP 2 SOUTH RANGE 20 EAST

Scale 2 Inches to the Mile.

of the 6th Principal Meridian.



HIGHLAND STATION

Scale 300 Ft. to 1 Inch.

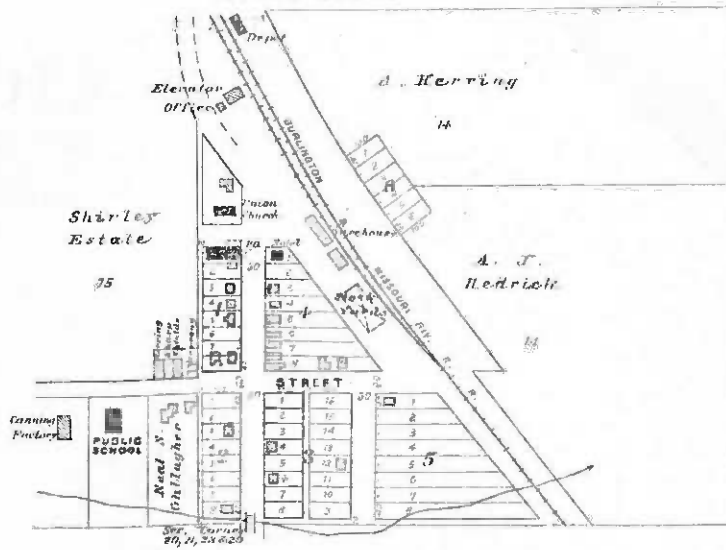

IOWA POINT

LOCATED IN IOWA TWP

Scale 300ft. to 1 Inch

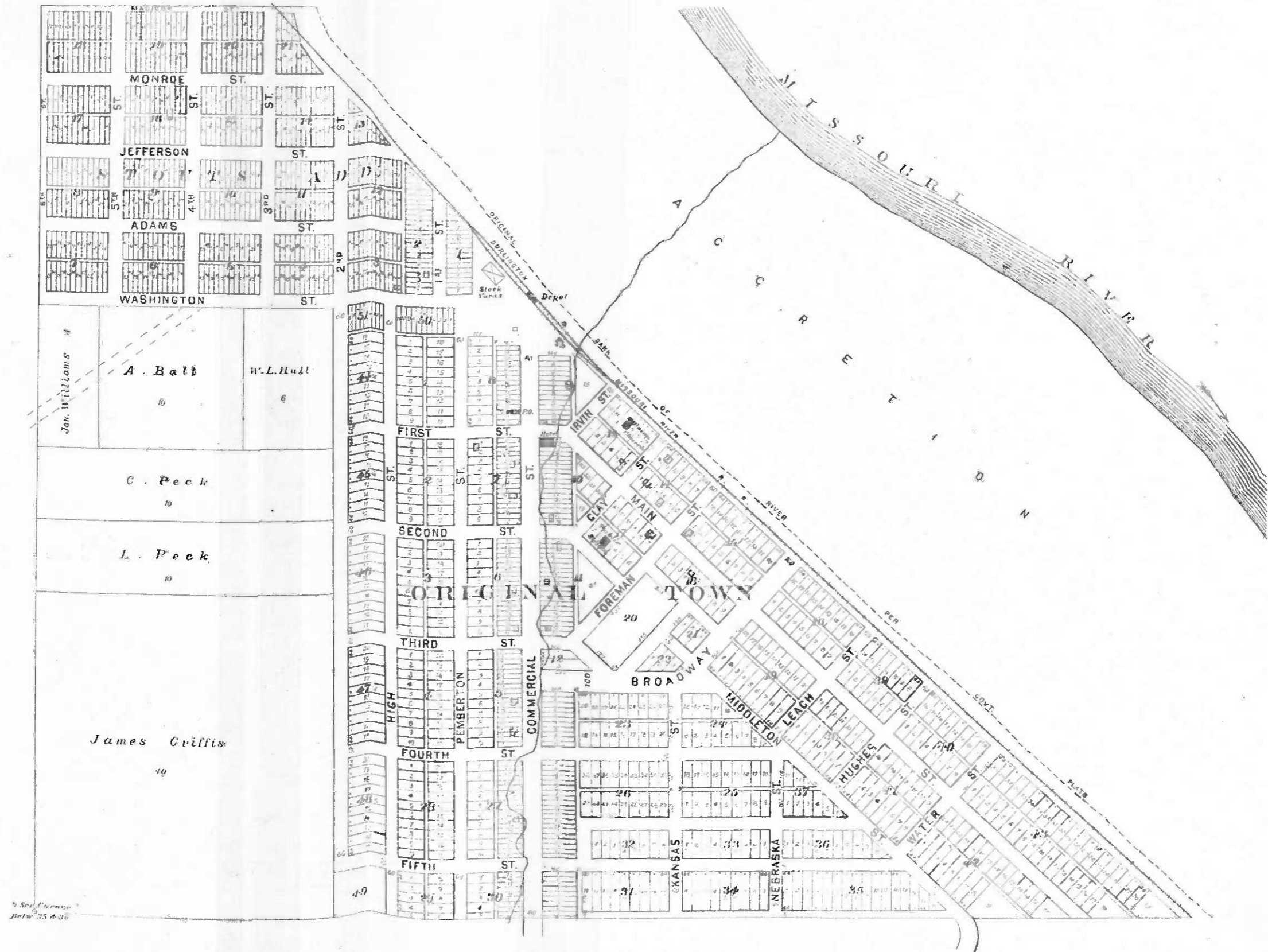

TOWNSHIP 2 SOUTH RANGE 21 EAST.

Scale 2 Inches to the Mile.

of the 6th Principal Meridian.

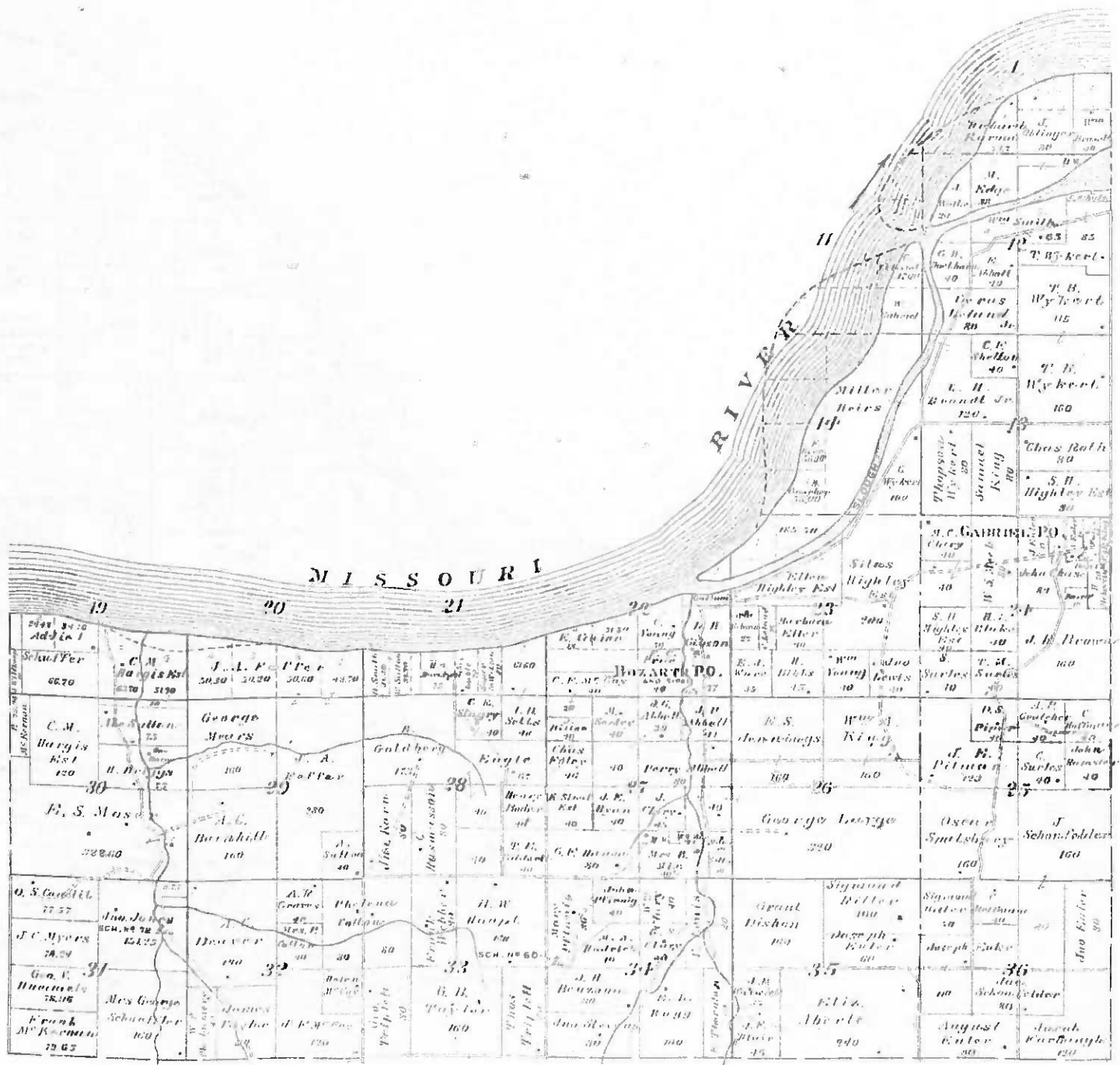

TOWNSHIP 2 SOUTH RANGE 22 EAST

Scale 2 Inches to the Mile.

of the 6th Principal Meridian.

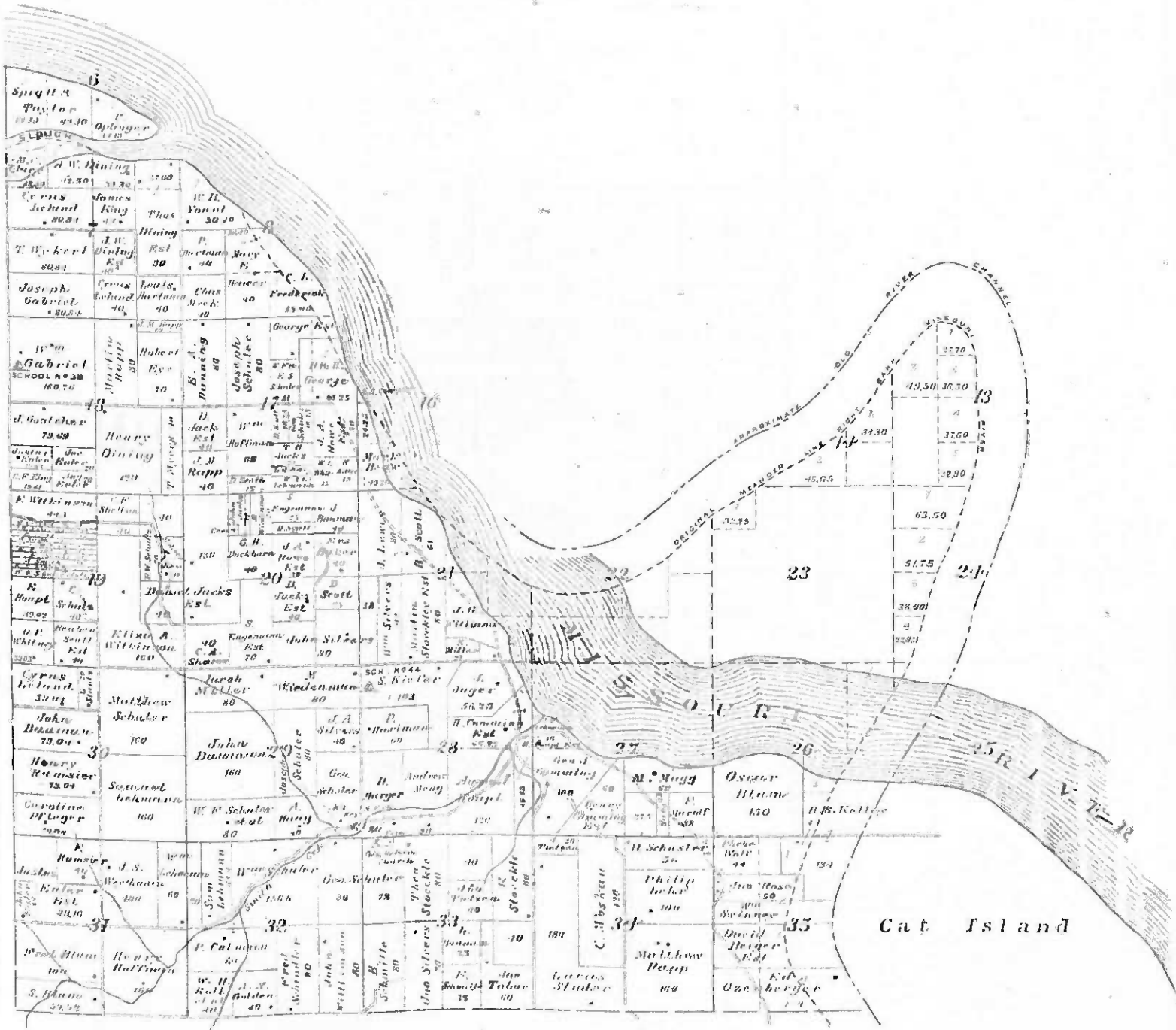

HIGHLAND

LOCATED IN IOWA TWP.
Scale 300 ft to 1 Inch.



TOWNSHIP 3 SOUTH RANGE 19 EAST

Scale 2 Inches to the Mile

of the 6th Principal Meridian.

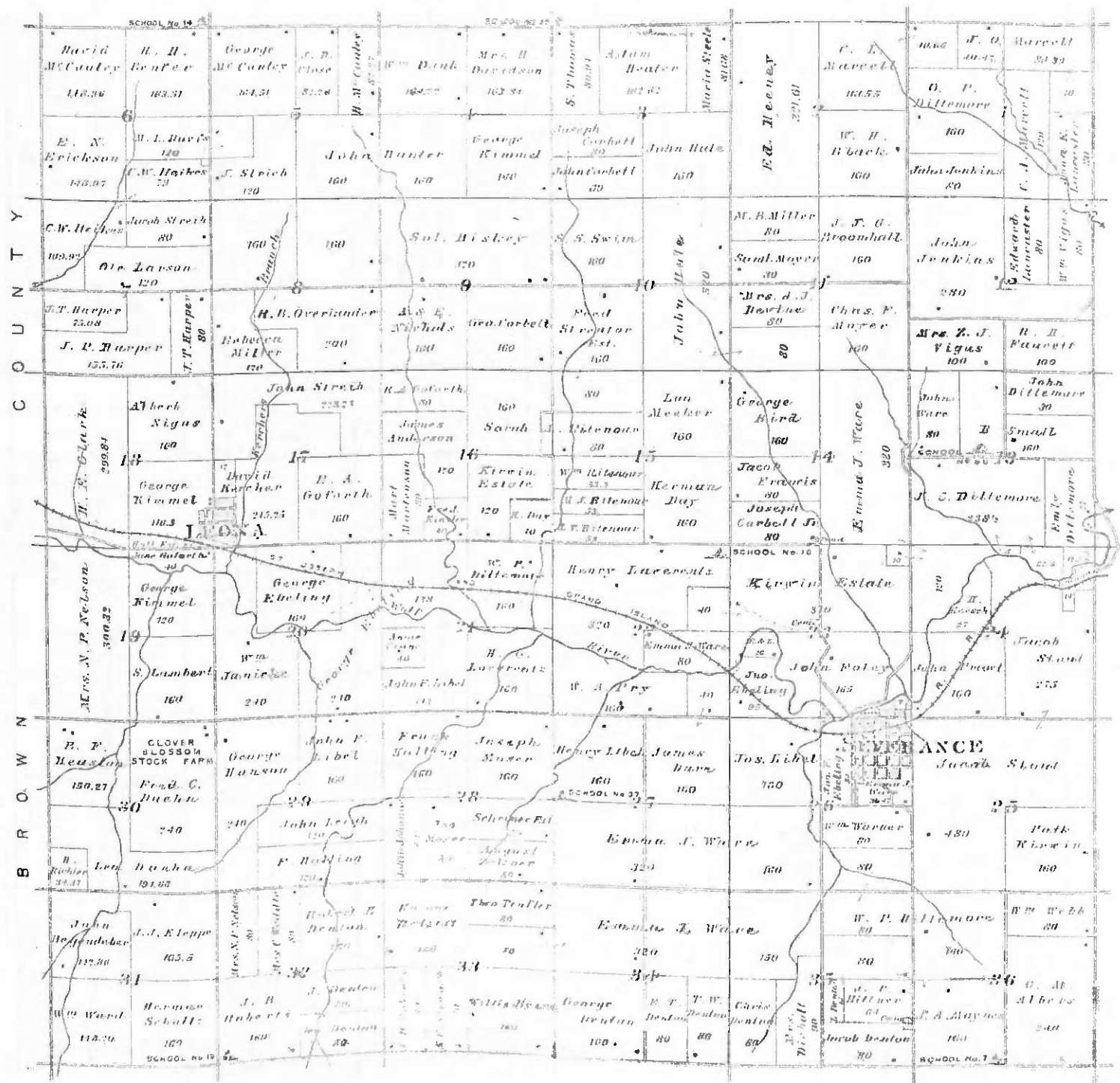

TOWNSHIP 3 SOUTH RANGE 20 EAST

Scale 2 Inches to the Mile.

of the 6th Principal Meridian.

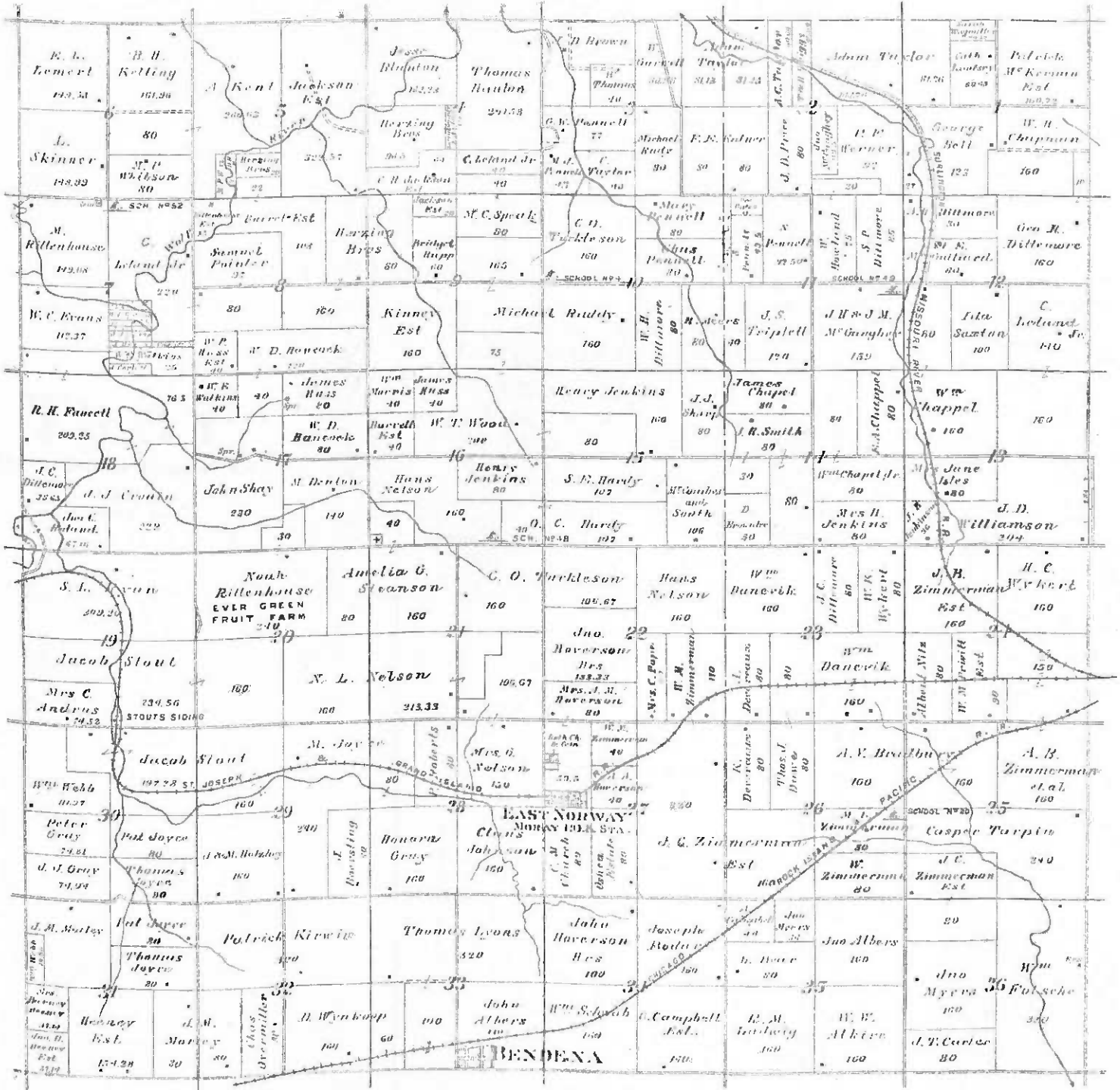



TROY
 County Seat of Doniphan Co.
 KANSAS
 Scale 300 Ft. to 1 Inch.

F. Miller
 F. J. Kotelnik
 Cyrus Belmont Jr.

I. A. Profile
 J. D. Maples
 James Stanton
 J. A. Saxton

R. B. Castle
 John Deveraux
 Joseph Hayton Estate
 H. M. Hyers
 John Olliver
 W. Reader

TOWNSHIP 3 SOUTH RANGE 21 EAST.

Scale 2 Inches to the Mile.

of the 6th Principal Meridian.

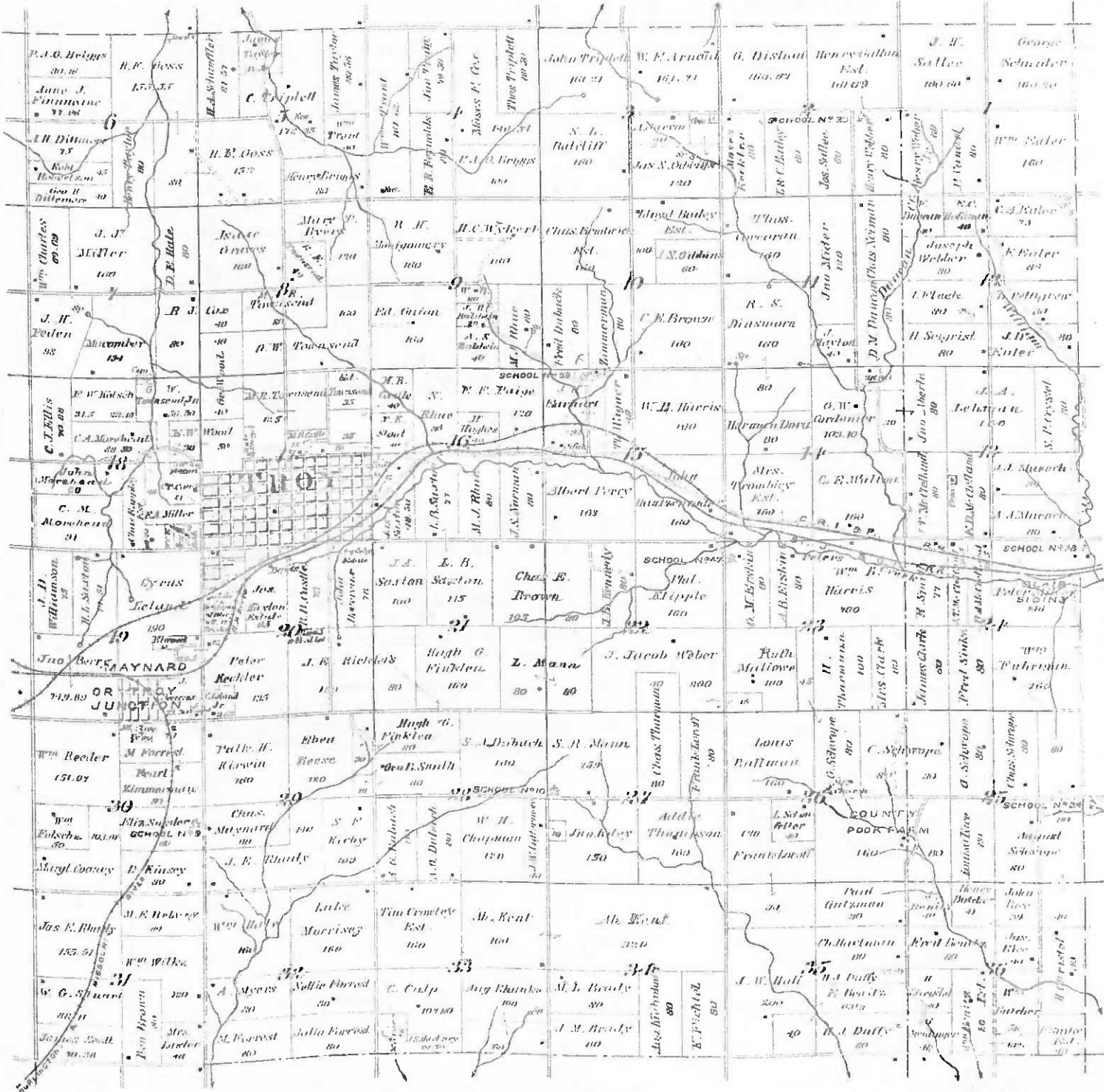

ELWOOD

LOCATED IN WASHINGTON TWP.

Scale 400 feet to one inch

MISSOURI

REVER



15TH ST
14TH ST
13TH ST
12TH ST
11TH ST
10TH ST
9TH ST
8TH ST
7TH ST
6TH ST
5TH ST
4TH ST
3TH ST
2TH ST
1ST ST

15TH ST
14TH ST
13TH ST
12TH ST
11TH ST
10TH ST
9TH ST
8TH ST
7TH ST
6TH ST
5TH ST
4TH ST
3TH ST
2TH ST
1ST ST

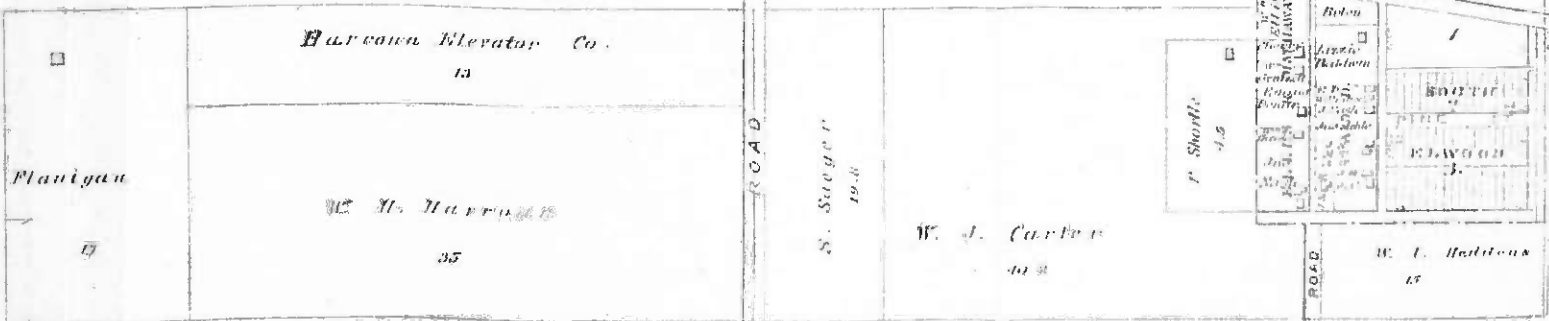

15TH ST
14TH ST
13TH ST
12TH ST
11TH ST
10TH ST
9TH ST
8TH ST
7TH ST
6TH ST
5TH ST
4TH ST
3TH ST
2TH ST
1ST ST

Flanigan

Harcourt Elevator Co.

W. M. Harris

S. Steeger

W. J. Carter

F. Shortle

W. L. Hadden

15TH ST
14TH ST
13TH ST
12TH ST
11TH ST
10TH ST
9TH ST
8TH ST
7TH ST
6TH ST
5TH ST
4TH ST
3TH ST
2TH ST
1ST ST

EAST NORWAY

MORAY R.O. STA.

Scale 300 Ft. to 1 Inch.



BENDENA

FORMERLY ALBERS

Scale 300 Ft. to 1 Inch.

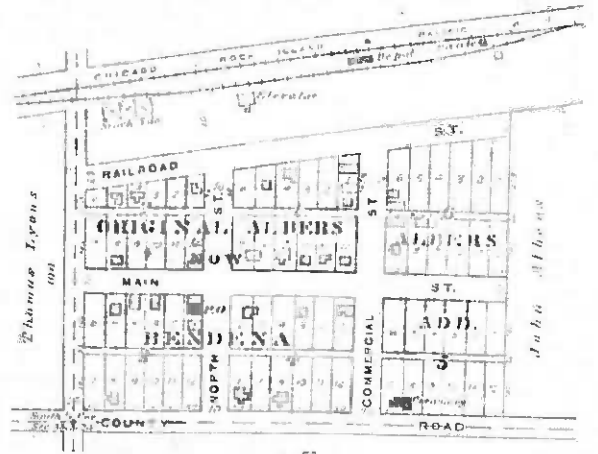

LEONA

Scale 300 Ft. to 1 Inch.

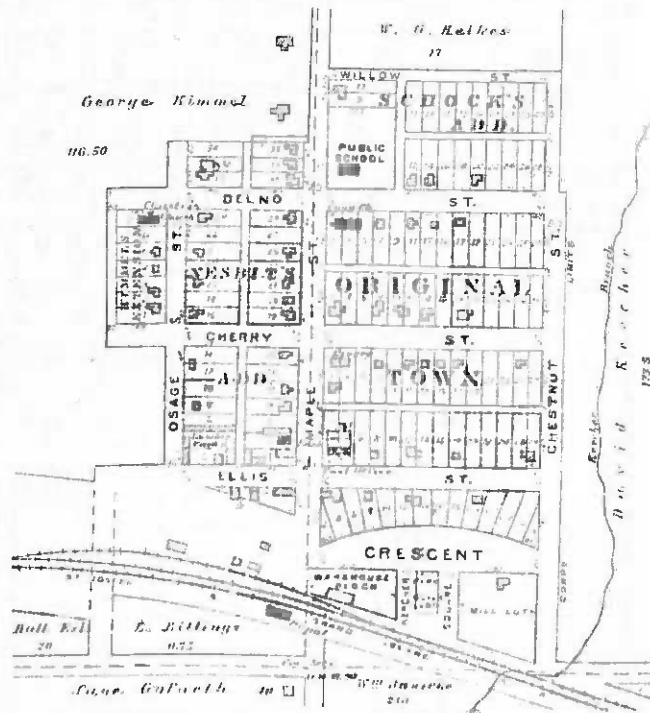

SEVERANCE

Scale - 800 Feet to 1 Inch.



24-25

TOWNSHIP 3 SOUTH RANGES 22 & 23 EAST

Scale 2 Inches to the Mile.

of the 6th Principal Meridian.

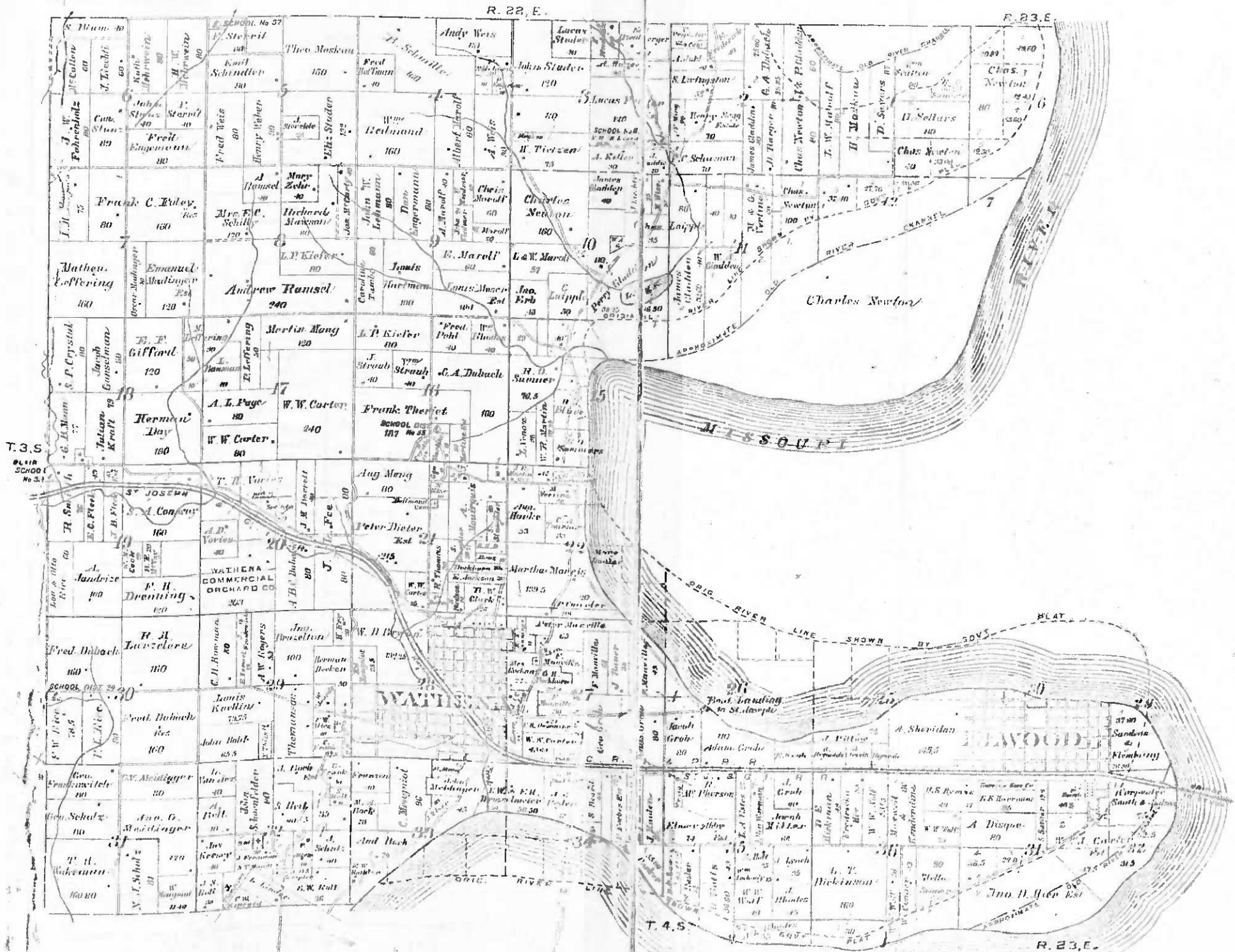

TOWNSHIP 4 SOUTH RANGE 19 EAST

Scale 2 Inches to the Mile.

of the 6th Principal Meridian.

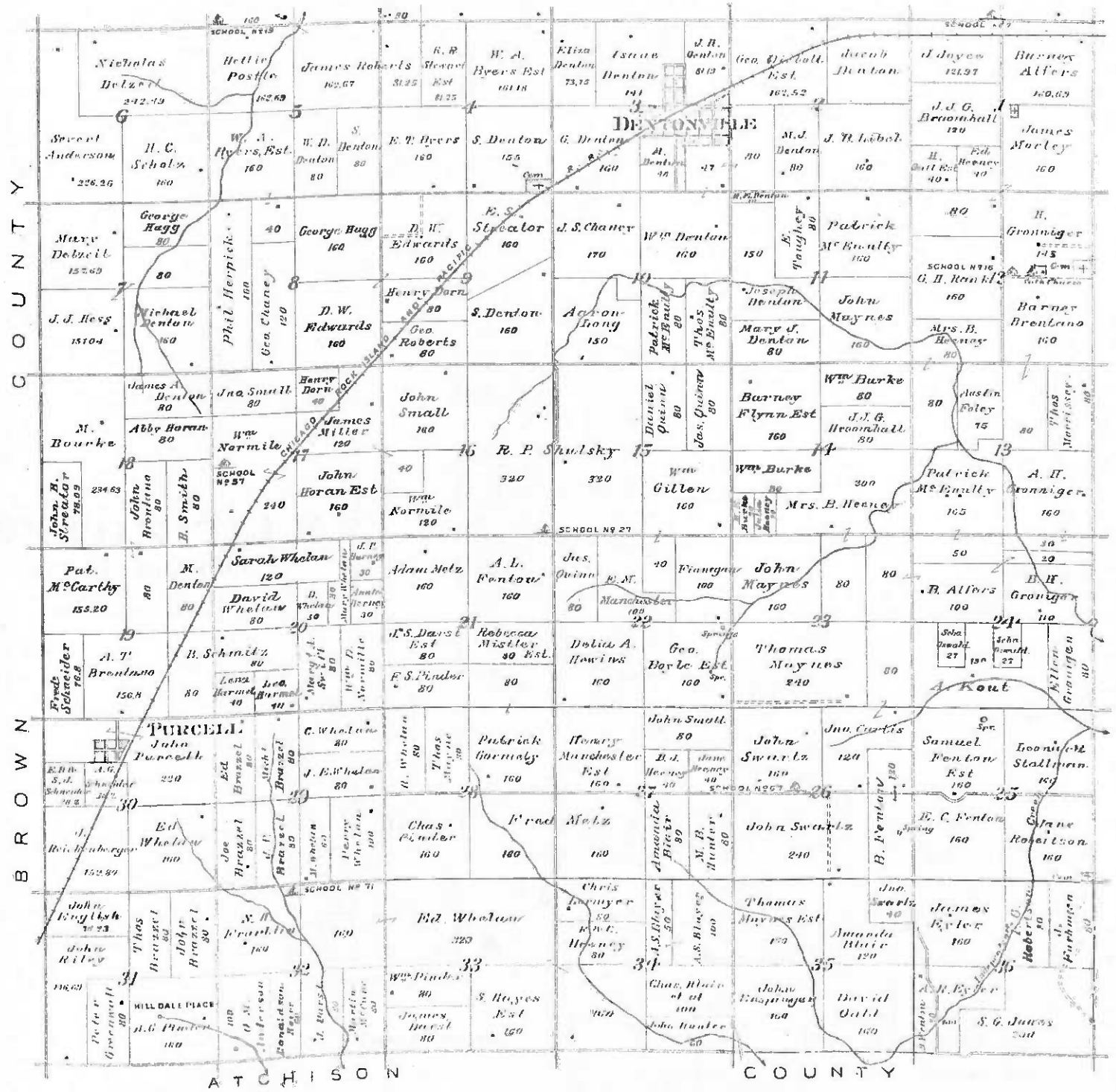

PURCELL

LOCATED IN UNION TWP.
Scale 300 feet to 1 inch.

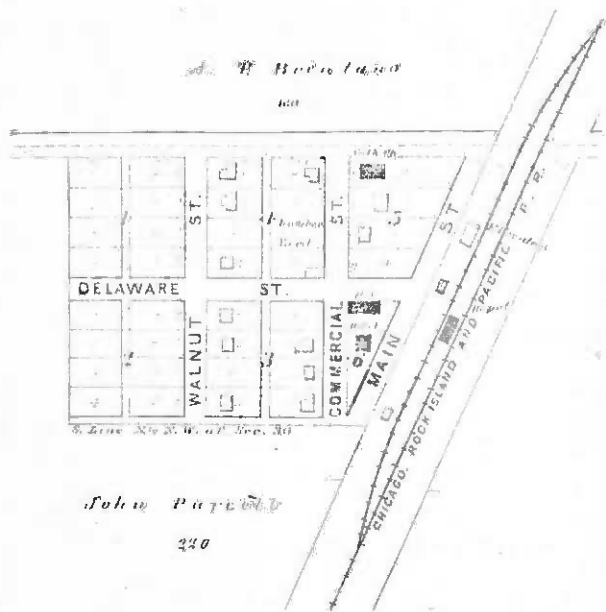

DENTONVILLE

Platted as DENTON
UNION TWP.
Scale 300 feet to one inch

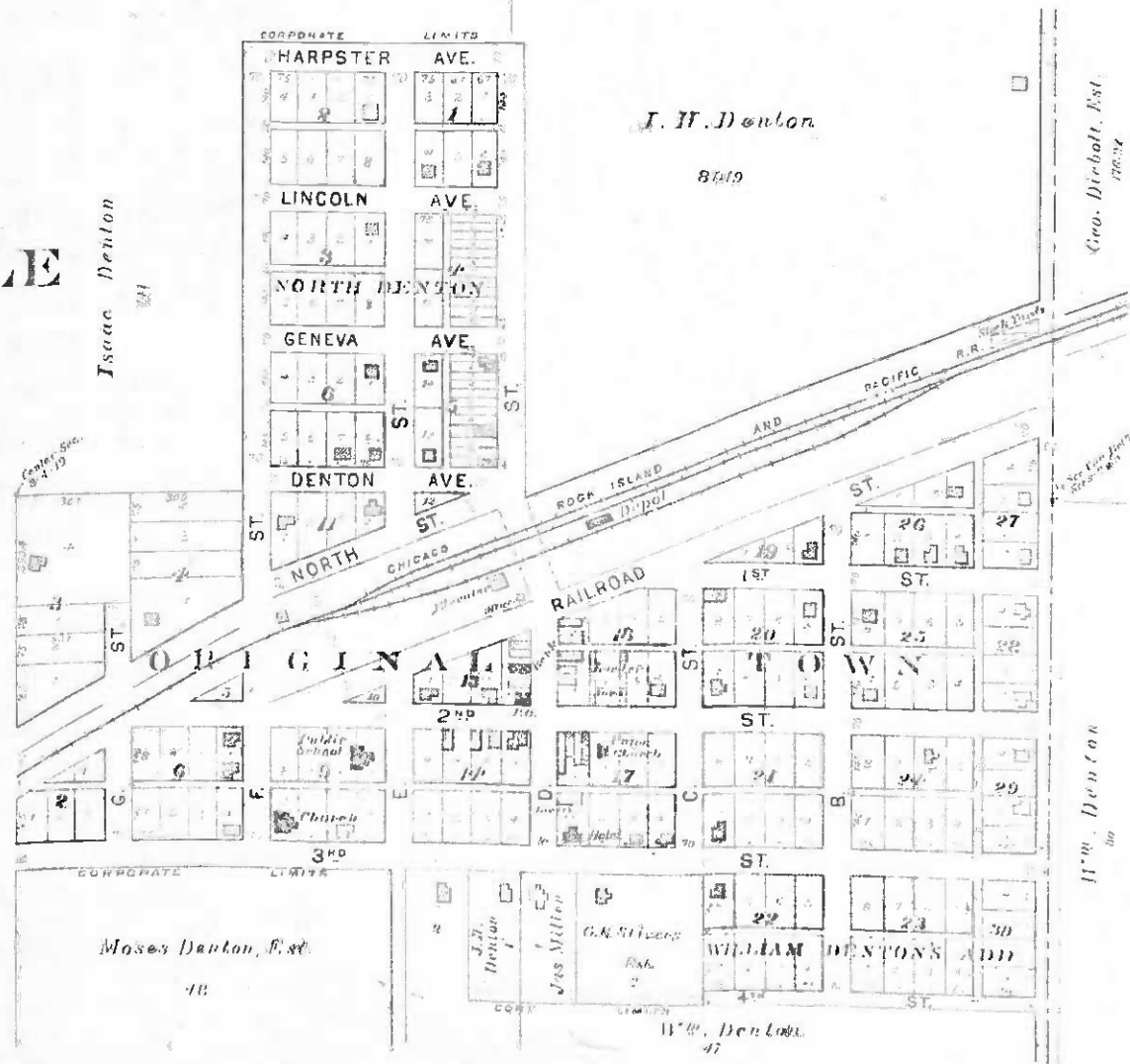

WATHENA

LOCATED IN WASHINGTON TWP.
Scale 300 feet to one inch.

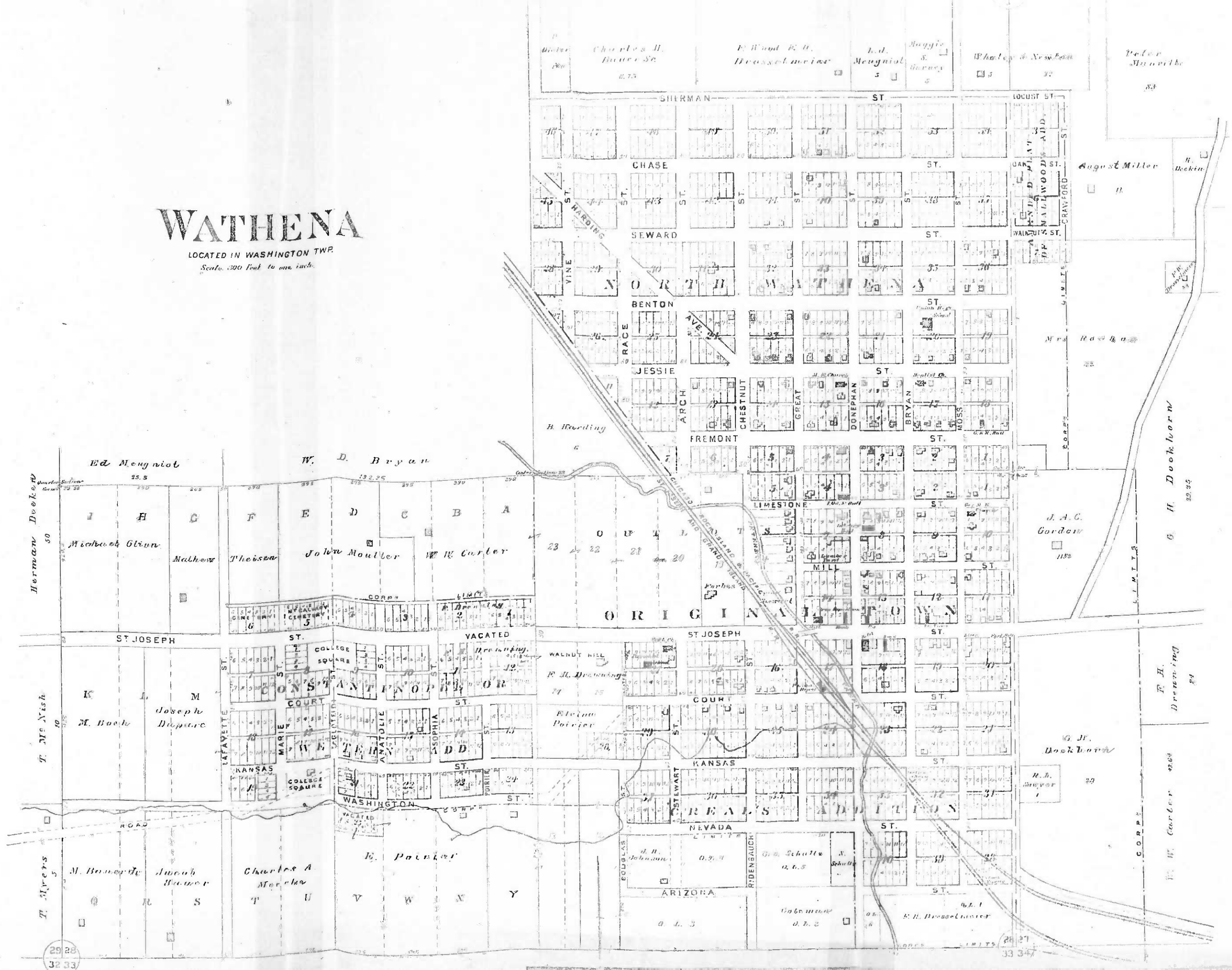

BRENNER
POST OFFICE & STATION
 LOCATED IN WAYNE TWP.
 Scale 300 ft. to an Inch.

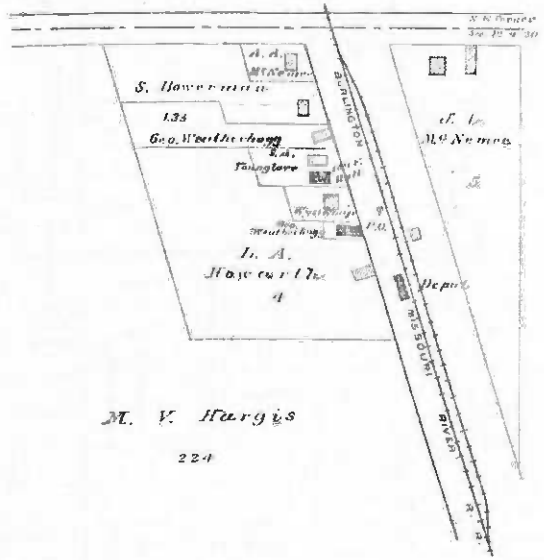

M. V. Hargis
 224

Scale 2 inches to the Mile.

of the 6th Principal Meridian



GEARY CITY

LOCATED IN WAYNE TWP.
Scale 300 Ft. to 1 Inch.

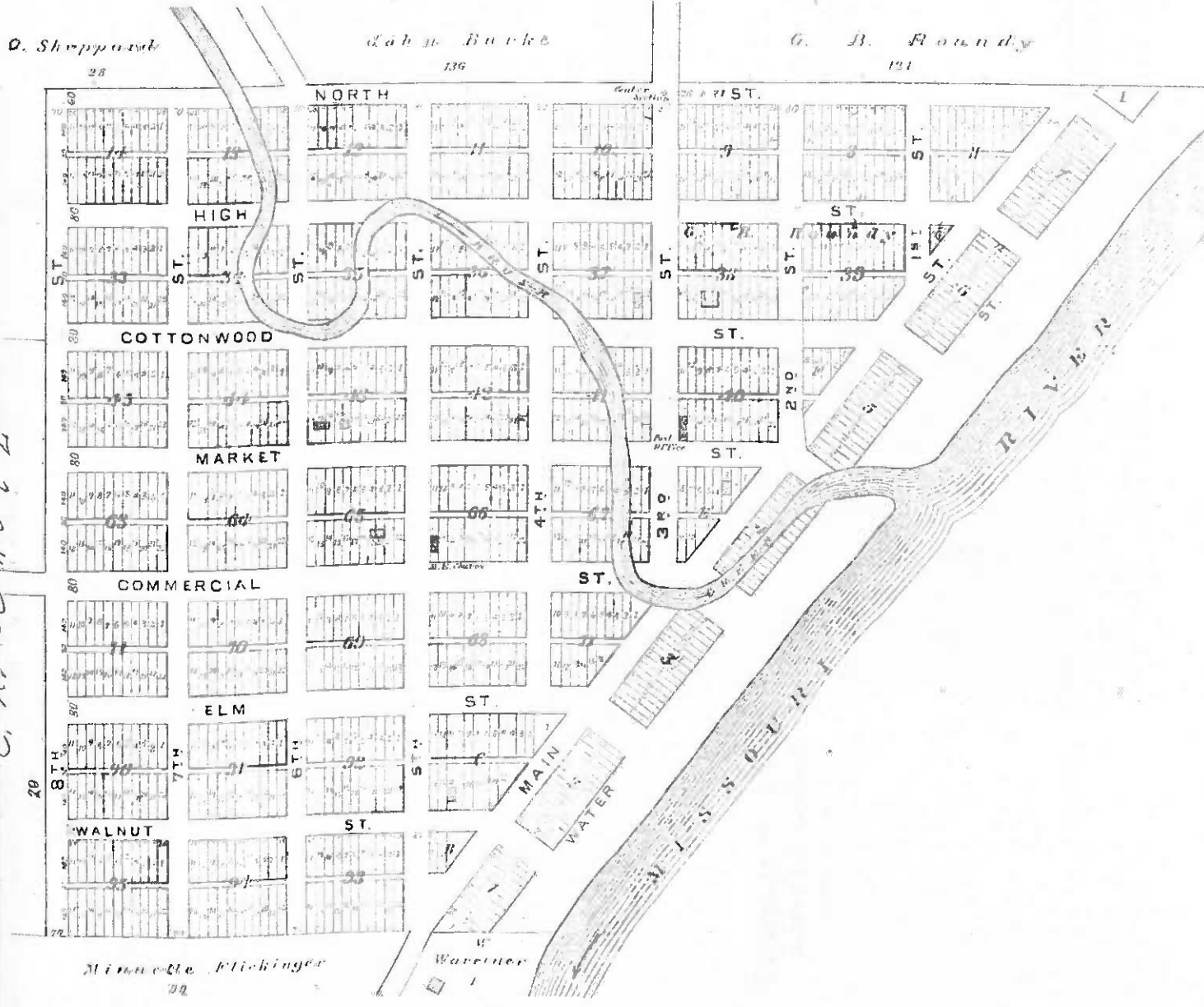

C. A. SCANZONI

Minnick Flickinger
79

Warener

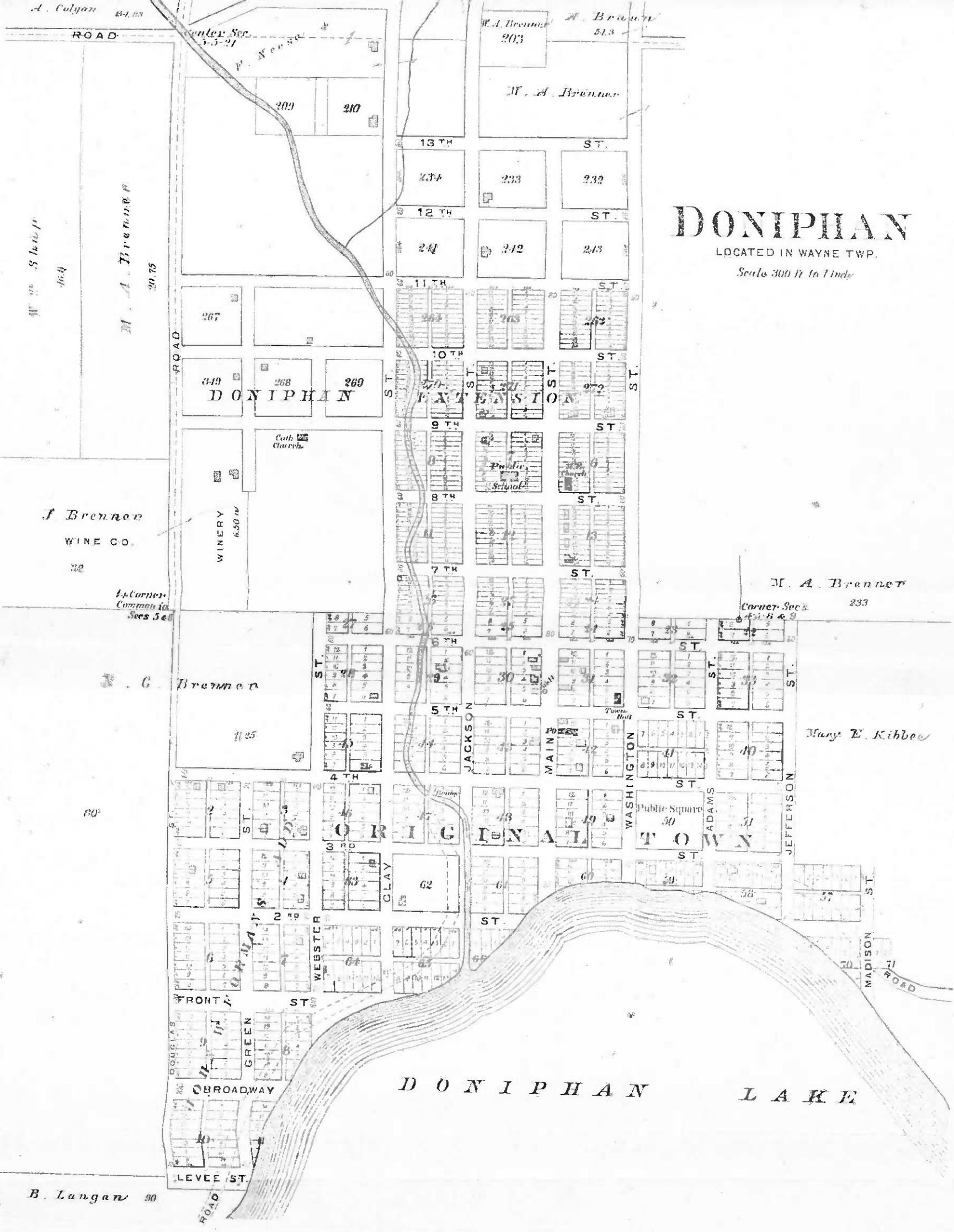

DONIPHAN
 LOCATED IN WAYNE TWP.
 Scale 300 ft to 1 inch

TROY JUNCTION
 PLATTED AS MAYNARD
 Scale 300 ft. to 1 inch



1875788

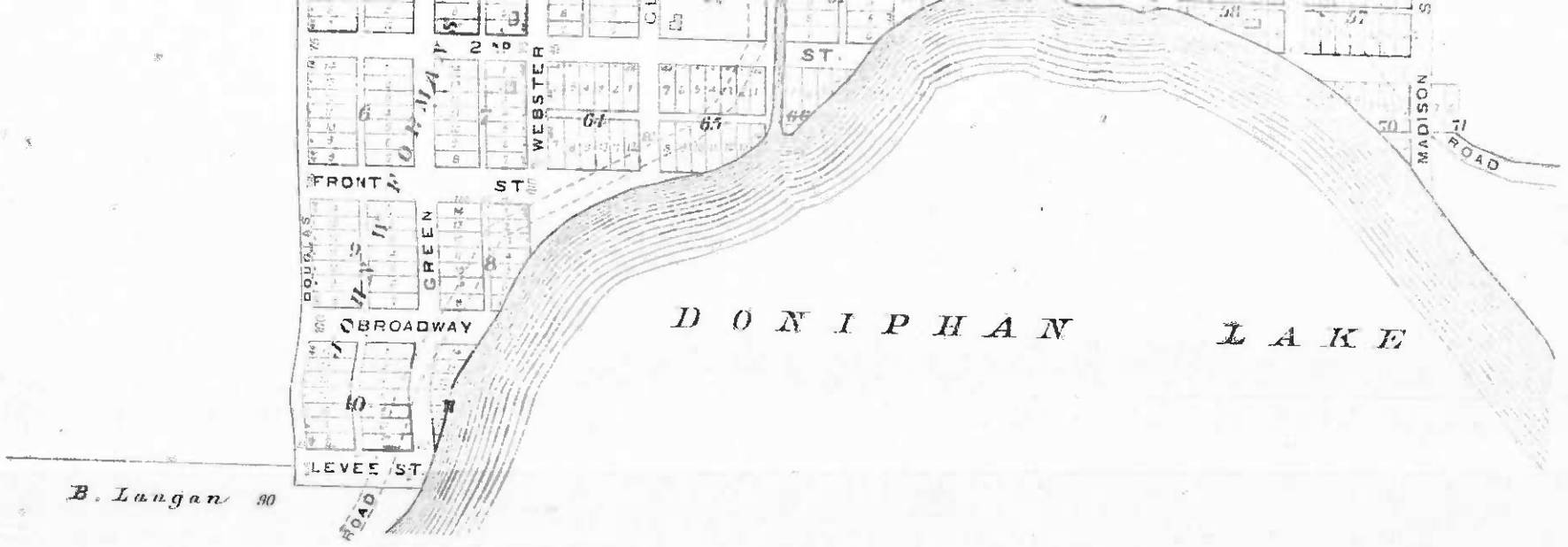

B. Langan 80



TROY JUNCTION
 PLATTED AS MAYNARD
 Scale 300 ft. to 1 inch

1875788

34-35

TOWNSHIP 4 SOUTH RANGE 22 EAST

Scale 2 Inches to the Mile.

of the 6th Principal Meridian

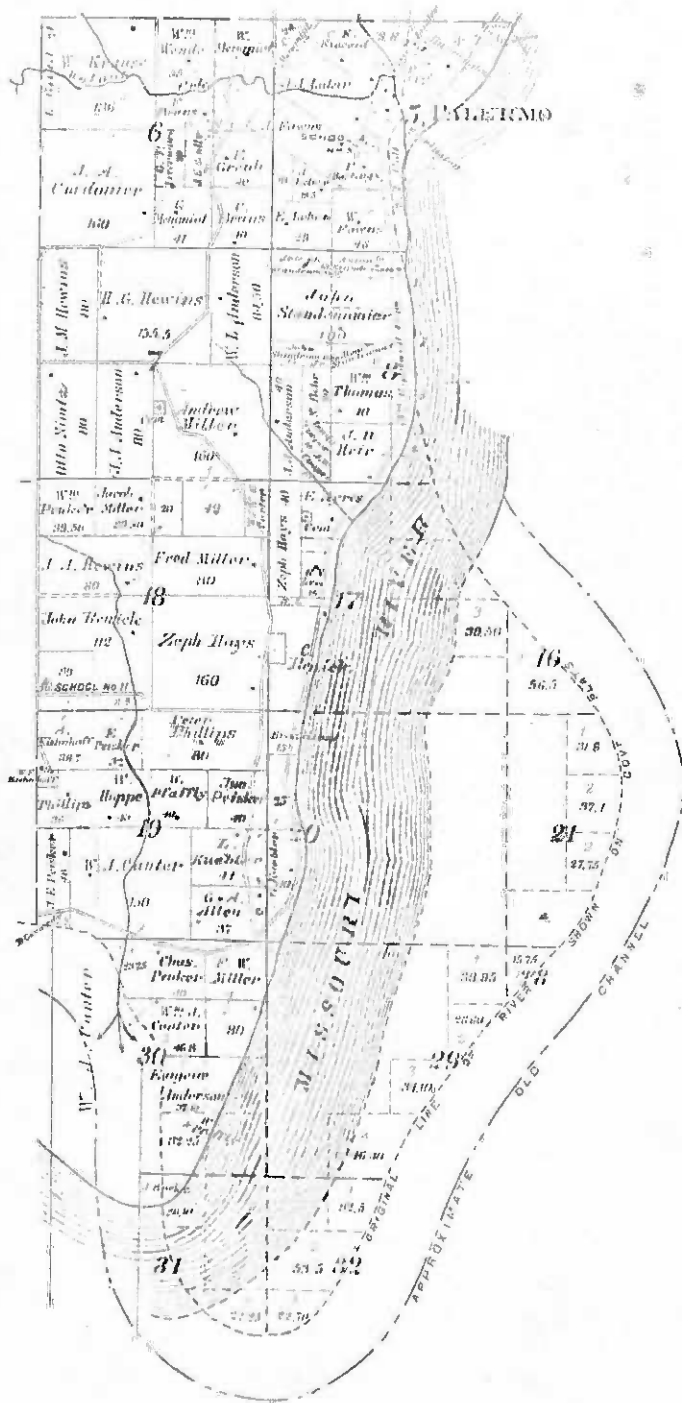

PALERMO

LOCATED IN MARION TWP

Section 460 6th 1st 1840

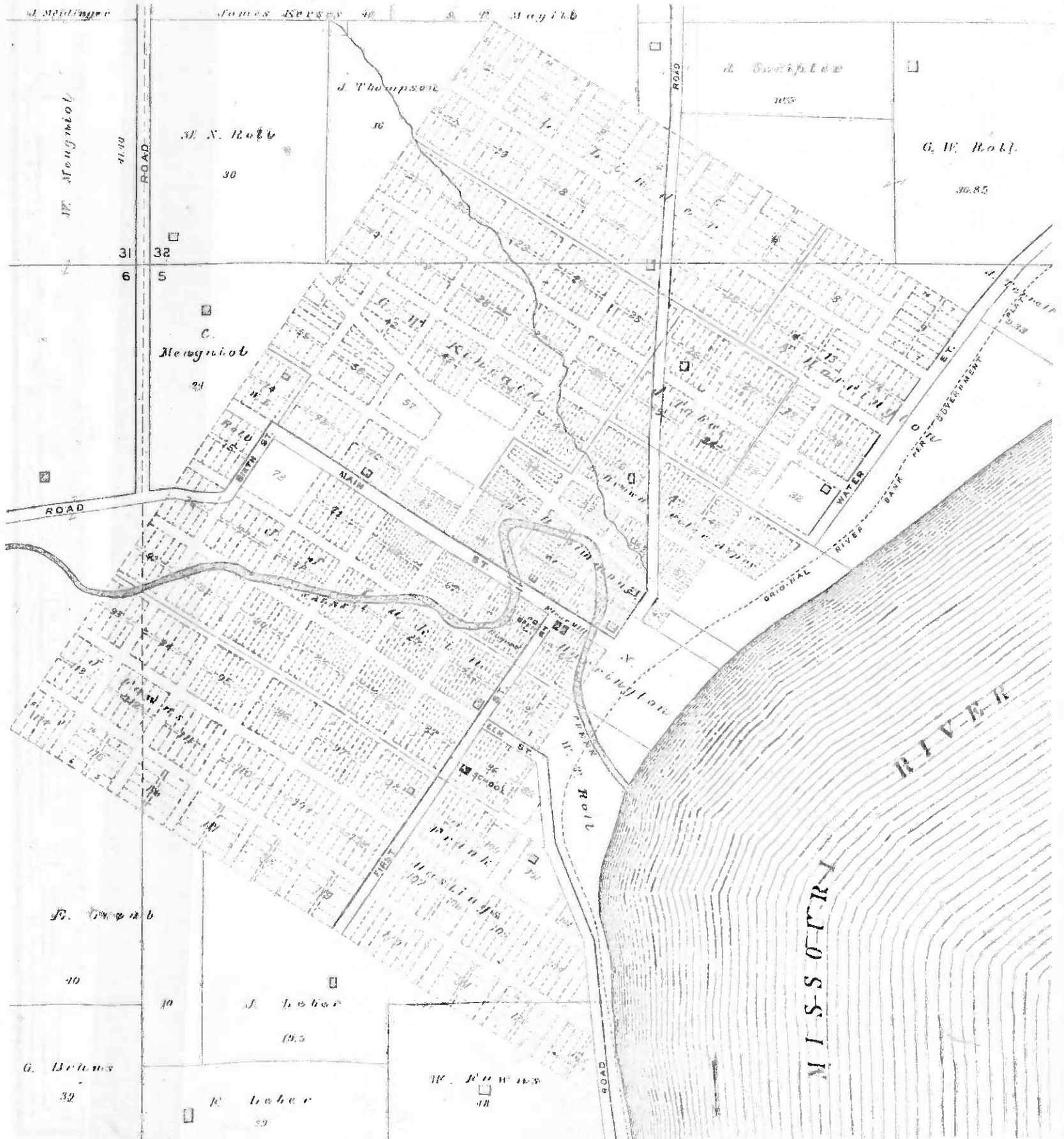

KANSAS

Published by GEO. F. CRAM, Chicago, Ill.

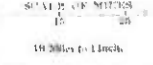

Scale
10 Miles
16 Kilometers

Electric Railroads
Michigan Eastern Light & Power
Electric Railways Light & Power
Four Seasons Consolidated Supply
Hill Island Street
Kansas City Transportation
Lawrence & Southern
Lawrence, Kan. & Western, Inc.
Missouri, Kansas & Texas
Missouri Pacific
St. Joseph and Eastern W. Ry. Co.
St. Louis, Iron Mountain & Southern Ry. Co.
St. Louis and North Western Ry. Co.
Union Pacific

Electric Light & Power
Electric Railways Light & Power
Four Seasons Consolidated Supply
Hill Island Street
Kansas City Transportation
Lawrence & Southern
Lawrence, Kan. & Western, Inc.
Missouri, Kansas & Texas
Missouri Pacific
St. Joseph and Eastern W. Ry. Co.
St. Louis, Iron Mountain & Southern Ry. Co.
St. Louis and North Western Ry. Co.
Union Pacific

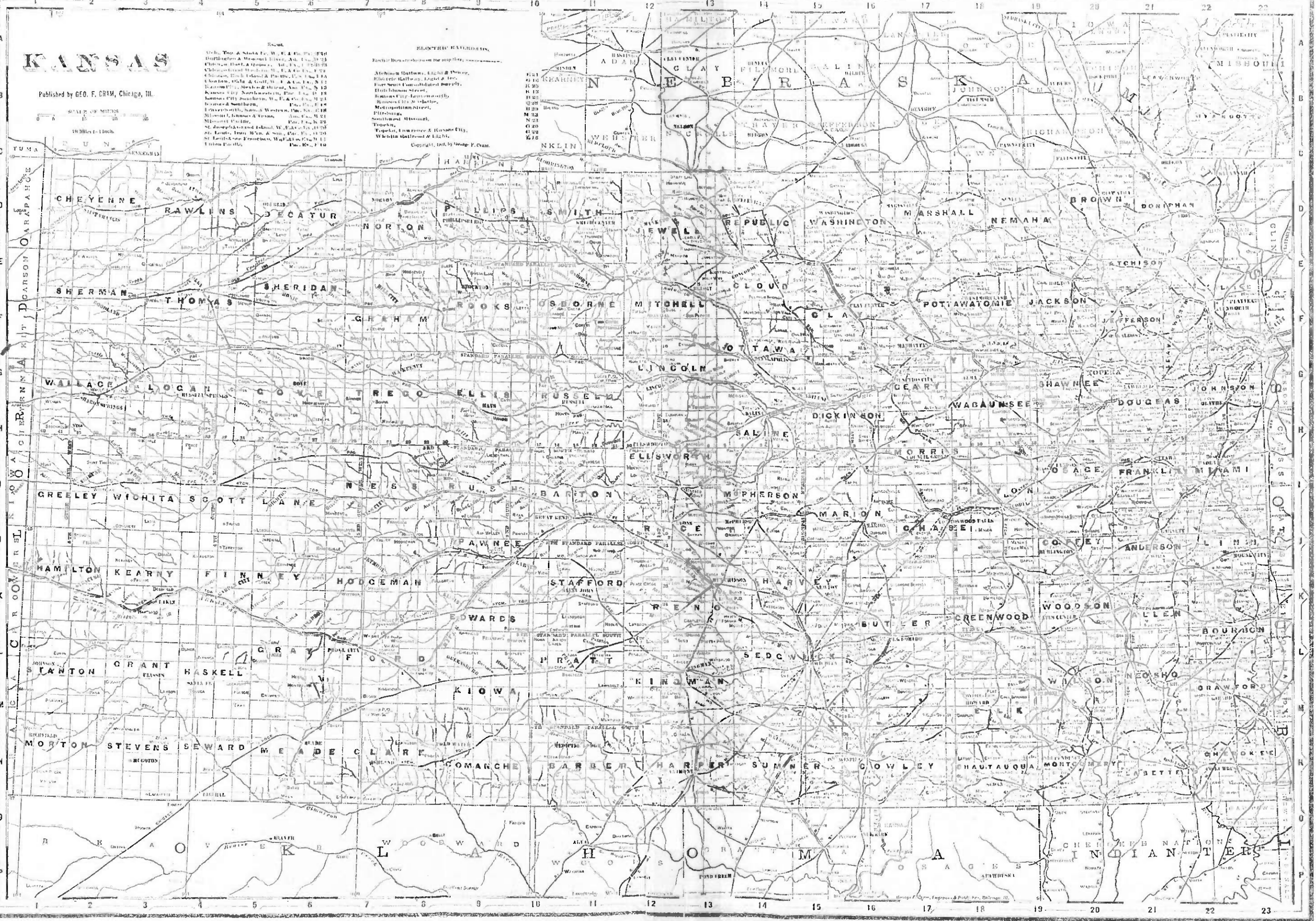

CHEYENNE RAWLINS DECATUR PHILLIPS SMITH JEWELL REPUBLIC WASHINGTON MARSHALL NEMAH BROWN DONIPHAN
SHERMAN THOMAS SHERIDAN NORTON ROKS OSBORNE MITCHELL CLOUD POTTAWATOMIE JACKSON
WALLACE LOCAN COVETT REGO ELLIS RUSSELL LINCOLN TOTTAWA GEARY WABAUWSEE SHAWNEE DOUGLAS JOHNSON
GREGLEY WICHITA SCOTT LANE NESS RUS BARTON ELLISWORTH MORRIS LYON MOSAGE FRANKLIN MIAMI
HAMILTON KEARNY FINNEY HODGEMAN PAWNEE STAFFORD HARVE MARION CHASBE LYON COFFEY ANDERSON LINN
STANTON GRANT HASKELL EDWARDS RENO BUTLER GREENWOOD WOODSON ALLEN BOURBON
MORTON STEVENS SEWARD WEADE CLARE KIOWA KINGMAN SEDGWICK WILSON NEOSHO CRAWFORD
COMANCHE BARBER HARPER SUMNER COWLEY CHAUTAQUA MONTGOMERY LA BETTE
MORTON STEVENS SEWARD WEADE CLARE KIOWA KINGMAN SEDGWICK WILSON NEOSHO CRAWFORD
COMANCHE BARBER HARPER SUMNER COWLEY CHAUTAQUA MONTGOMERY LA BETTE

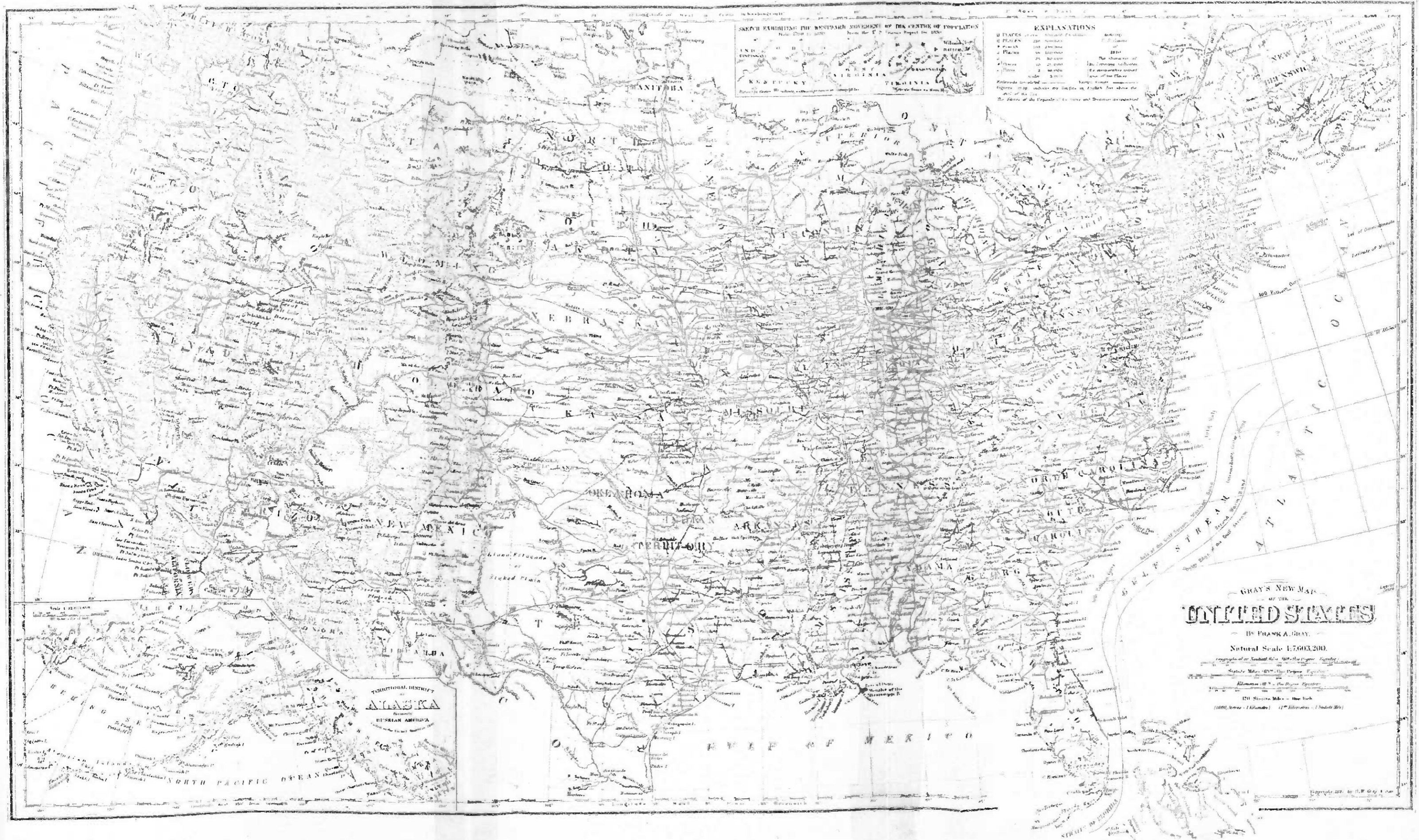

EXPLANATIONS

0 PLACES	250	500000
1 PLACES	1000	1000000
2 PLACES	2500	2500000
3 PLACES	5000	5000000
4 PLACES	10000	10000000
5 PLACES	25000	25000000
6 PLACES	50000	50000000
7 PLACES	100000	100000000
8 PLACES	250000	250000000
9 PLACES	500000	500000000
10 PLACES	1000000	1000000000

Population indicated by figures in the circles in the sketch above the map.

The center of the population in 1790 was at the point marked with a cross.

GRAY'S NEW MAP
OF THE
UNITED STATES
BY PHOENIX GRAY.
Natural Scale 1:7,603,200.

Copyright of the United States, 1900, by Phoenix Gray.
Scale Map - 1:7,603,200. Paper - 100%.

Illustrations by W. H. R. Gray.

1211 Street, New York.
(1000, New York - 1000, New York) (1000, New York - 1000, New York)

Scale 1:7,603,200

TERMINAL DISTRICT OF
ALASKA
RUSSIAN AMERICA

NORTH PACIFIC OCEAN

WESTERN HEMISPHERE

EASTERN HEMISPHERE

TIME DIAGRAM

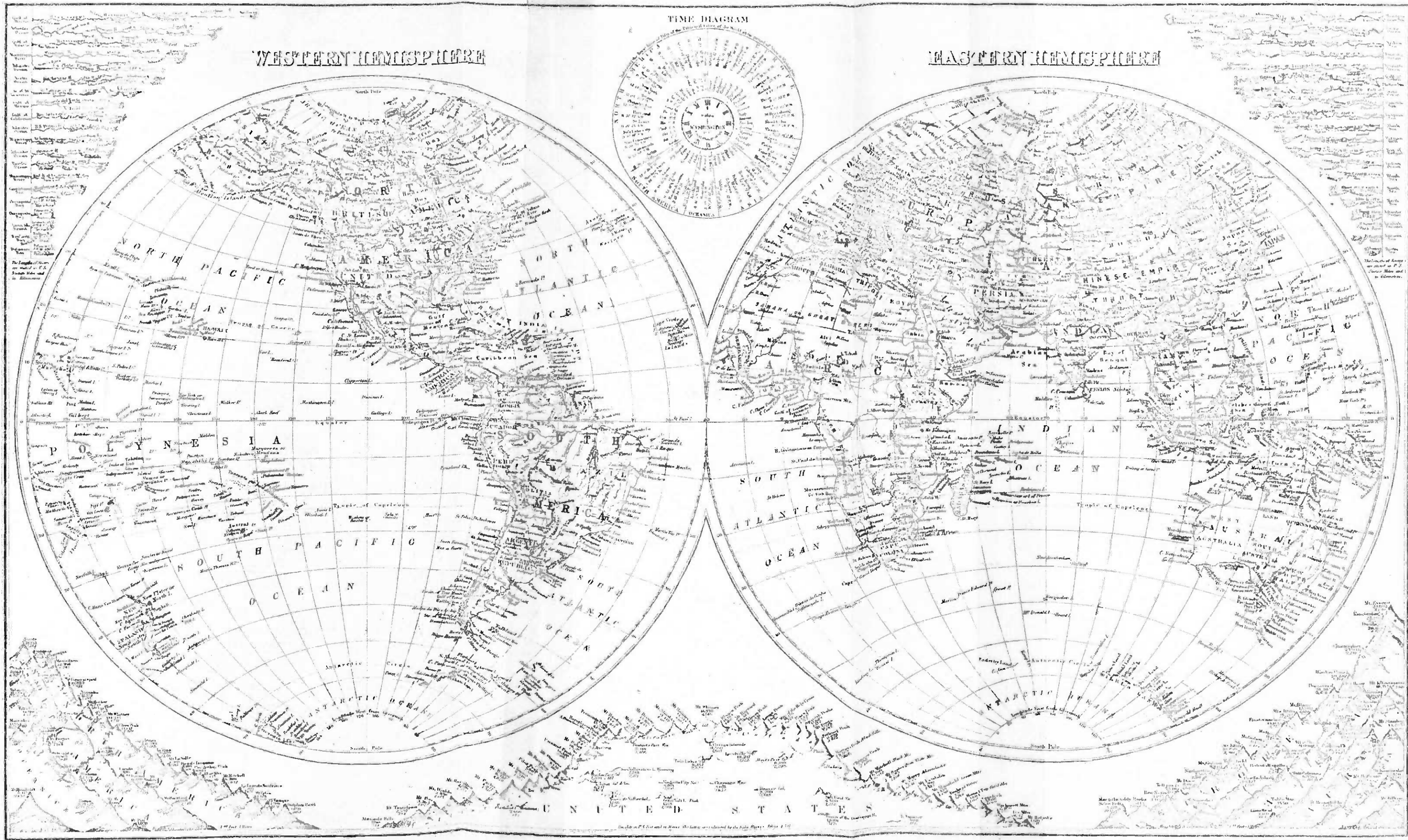

UNITED STATES

Small text at the bottom left corner, likely a copyright or publication notice.

Small text at the bottom right corner, likely a copyright or publication notice.

THE SYSTEM OF GOVERNMENT SURVEYS.

Outline from Reports and Instructions of the U. S. General Land Office.

The present system of surveying Government lands, termed the "Land System of the United States," has developed from an ordinance introduced in the Continental Congress May 7, 1784, termed "An Ordinance for ascertaining the mode of locating and disposing of lands in the Western Territory," and adopted by an act of Congress passed May 7, 1785. It had no precedent in the theory or practice of any pre-existing government, being the result of the highest order of statesmanship, and exhibiting a profound knowledge of engineering science in minute details. With a few unimportant changes, it has been adopted by the Dominion of Canada. The ordinance provided for townships six miles square, containing thirty-six sections one mile square. The region embraced by the survey under this law forms a part of the present State of Ohio, and is usually styled "Old Seven Ranges." The townships, six miles square, were laid out in ranges extending northward from the Ohio River, the townships being numbered from south to north, and the ranges from east to west. In these initial surveys only the section lines of the townships were surveyed, and mile corners were established on the township lines, but the plats were marked by subdivisions into sections of one mile square. The sections were numbered from one to thirty-six, commencing with number one in the southeast corner of the township, and running from south to north in each tier to number thirty-six in the northwest corner of the township. These first public surveys were made under the direction of the geographer of the United States.

The act of Congress approved May 18, 1790, provided for the appointment of a surveyor-general, and directed the survey of the lands north-west of the Ohio River and above the mouth of the Kentucky River, "in which the titles of the Indian tribes have been extinguished," "Under this law one-half of the townships surveyed were subdivided into sections by running through the same, east and west, parallel lines at the end of every two miles, and by making a corner on each of said lines at the end of every mile," and it further provided that "the sections shall be numbered, respectively, beginning with the number one in the northwest section, and proceeding west and east alternately, through the townships, with progressive numbers till the thirty-sixth be completed." This method of numbering the sections is still in use, and can be seen by reference to Diagram No. 2, on reverse page.

The act of Congress, approved February 11, 1807, directs the subdivision of the public lands into quarter sections, and provides that all the corners marked in the public surveys shall be established at the proper corners of sections or subdivisions of sections which they were intended to designate, and that corners of half and quarter sections not needed shall be placed as nearly as possible equidistant from those two corners which stand on the same line.

The act of Congress, approved April 25, 1812, provided "That there shall be established in the Department of the Treasury an office to be denominated the General Land Office, the chief officer of which shall be called the Commissioner of the General Land Office, whose duty it shall be, under the direction of the head of the department, to superintend, execute, and perform all such surveys and things touching or respecting the public lands of the United States and other lands patented or granted by the United States, as have heretofore been directed by law to be done or performed in the office of the Secretary of State, of the Secretary and Register of the Treasury, and of the Secretary of War, or which shall hereafter by law be assigned to the said office."

The act of Congress, approved July 1, 1836, provided for the reorganization of the General Land Office, and that the executive duties of said office shall be subject to the supervision and control of the commissioner of the General Land Office under the direction of the President of the United States. The repealing clause is: "That such provisions of the act of the twenty-fifth of April, in the year one thousand eight hundred and twelve, entitled 'An act for the establishment of a General Land Office in the Department of the Treasury,' and of all acts amendatory thereof as are inconsistent with the provisions of this act, be and the same are hereby repealed."

From the wording of this act, it would appear that the control of the General Land Office was removed from the Treasury Department, and that the Commissioner reported directly to the President; but as a matter of fact the Secretary of the Treasury still had supervisory control, for the act of Congress, approved March 2, 1837, by which the Department of the Interior was established, provided "That the Secretary of the Interior shall perform all the duties in relation to the General Land Office, of supervision and appeal, now discharged by the Secretary of the Treasury." By this act the General Land Office was transferred to the Department of the Interior, where it still remains.

THE RECTANGULAR SYSTEM OF SURVEYS.

The public lands of the United States were originally surveyed into rectangular tracts bounded by lines conforming to the cardinal points. The principal lines are designated as meridian, base, township, range, and section lines, and the bodies of land thus formed are known as townships, sections, and lots. The first recorded use of the terms "township," and "section," as applied to the public lands of the United States, is in an ordinance reported by Congress April 25, 1785. In Diagram No. 2, representing an entire township, each "section" and "lot" is plainly indicated.

INITIAL POINTS.

Initial points from which the lines of the public surveys are to be extended must be established whenever necessary under such special instructions as may be prescribed in each case, by the Commissioner of the General Land Office. The location of such initial points must be marked with care and due consideration for their permanency and easy identification, and must be established astronomically. The initial point having been established, the lines of the public survey are to be extended therefrom as follows:

PRINCIPAL MERIDIAN AND BASE LINES.

An extended north and south and east and west line on the initial point by the use of solar instruments or transit, as they may be directed by the Surveyor-General. In order to check errors in measurement, two sets of observations, extending independently of each other, must be employed, and the proper corrections established. Typical meridians are identified by number or name. Each has its own base line, and these two lines form the basis or foundation for surveys of all lands within the territory contained by them.

Old public surveys are controlled by several initial points, and by the first principal meridian coincident with the eastern boundary between Ohio and Indiana. Indiana surveys are controlled by the second principal meridian. Illinois surveys are controlled by the second, third, and fourth principal meridians. Wisconsin by the fourth principal meridian. Minnesota by the fourth and fifth principal meridians. The Dakotas by the fifth and sixth principal meridians, the Black Hills meridian. Iowa, Missouri, and Arkansas by the fifth principal meridian. Kansas, Nebraska, and the greater portion of Colorado and Wyoming by the sixth principal meridian. Michigan by the Michigan meridian, Florida by the Tallahassee meridian, Alabama by the Huntsville and St. Stephens meridians, Mississippi by the St. Stephens, Choctaw, and Washington meridians. Louisiana, east of the Mississippi River, by the St. Helena meridian, and on the west by the Louisiana meridian. New Mexico by the New Mexico meridian, Arizona by the Gila and Salt River meridians. Utah by the Great Salt Lake meridian, Nevada by the Mount Diablo meridian, Idaho by the Boise meridian, Montana by the Montana meridian, California by the Mount Diablo, the San Bernardino, and the Humboldt meridians. Oregon and Washington by the Willamette meridian.

TOWNSHIPS AND RANGES.

Township lines are run east and west parallel with and six miles from the base line and from each other, and the spaces between these lines are known as townships north or south, and designated by numbers according to their numerical distance from the base line. Range lines are run north and south on a true meridian, six miles from and parallel, as near as may be, with the principal meridian, and the spaces between them are known as ranges, and are described as east or west of the principal meridian, and consecutively numbered from that line.

Diagram No. 1, on reverse page, will illustrate the system of numbering townships and ranges, north and south and east and west from the principal meridians and base lines, numbering east or west until they reach the next meridian, and north or south until they reach the next base line.

Thus, any certain township or range can readily be found within the territory embraced by this system if the numbers of the same are known referring to principal meridian and base line.

The bodies of land six miles square, formed by the intersection of the township and range lines, are called

CONGRESSIONAL TOWNSHIPS.

and contain, as near as may be, 3,600 acres. Congressional townships are described and located as being north or south of the base line and east or west of the principal meridian from which that particular survey is made. Town townships are north, range those west of the fifth principal meridian, would be the first township north of the base line and in the third range west from the principal meridian. The law requires that the lines of the public surveys shall be governed by the true meridian, and that the townships shall be six miles square, two thirds involving, in consequence, a mathematical impossibility, for, strictly to conform to the law, necessarily forms the township out of square by reason of the convergence of the meridians, and hence, by adhering to the true meridian results the necessity of departing from the strict requirements of law, as respects the precise area of townships and the subdivision parts thereof, the townships assuming something of a trapezoidal form, which obviously develops itself more and more as such the higher the latitude of the surveys.

For that reason standards and auxiliaries, which are also called section lines, and auxiliary or guide meridians are run from them to flow, and are designated by number, and as north, south, east, or west, as the case may be, from their respective base lines and principal meridians; parallels and auxiliaries are now run at intervals of twenty-four miles, dividing the country into tracts of twenty-four miles square, or sixteen townships.

Congressional townships are subdivided into thirty-six tracts, called

SECTIONS.

each containing, as near as may be 360 acres. The thirty-six sections into which a township is subdivided are numbered, commencing with number one at the southeast angle of the township, and proceeding west to number six, and thence proceeding east to number twelve, and so on, alternately, until they number thirty-six in the southeast angle. In all cases of surveys of fractional townships, the sections should bear the same number as they would if the township was full. In all cases where the exterior lines of the township thus subdivided into sections or half sections shall exceed, or shall not exceed, six miles, the excess or deficiency shall be specially noted, and noted to be subtracted from the western or northern ranges of sections or half sections in such township, according as the case may be. In running the lines from east to west, or from south to north, the sections and half sections bounded on the northern and western lines of such townships shall be sold as including only the quantity expressed in the returns and plats respectively, and all others as containing the complete land quantity.

Diagram No. 2, on the reverse page, shows an entire Congressional Township subdivided and numbered by sections, and showing excess or deficiency in area on the north and west sides of the township.

Sections are divided into quarters by straight lines run from the established quarter section corners. Quarter section surveys are the opposite corresponding corners, and the point of intersection of the lines so run will be the corner points to the several quarter sections, or, in other terms, the local corner of the section; these quarter sections are designated as northeast quarter, northwest, southwest, or southeast, according to their location with regard to their common corner.

In the subdivision of quarter sections, the quarter quarter corners are to be placed at points equidistant between the sections and quarter section corners and between the quarter corners, and the common angle of the section, except on the last half mile of the lines closing on the north or west boundaries of a township, where they should be placed at twenty chains, proportionate measurement, to the north or west of the quarter section corner.

Quarter section corners and those containing moistered rivers and lakes are also marked by bronze bolts, as near as may be; these fractional lines are quartered from one upward in each section. By an examination of Diagram No. 2, on reverse page, and of the complete other parts of this work, the careful student will be enabled to describe or locate any piece of land. Numbers 1, 2, 3 are the numbers of the quartered lots with areas shown; a, north quarter corner; b, east quarter corner; c, south quarter corner; and d, west quarter corner.

Proceeding down streets, the bank on the left hand is termed the "left bank" and that on the right hand the "right bank." These terms are to be universally used to distinguish the two banks of a river or stream.

RE-ESTABLISHMENT OF LOST CORNERS.

The original corners, where they can be found, must stand as the true corners they were intended to represent, even though not exactly where street professional care might have placed them in the first instance.

Missing corners should be re-established in the identical localities they originally occupied. When the point cannot be determined by the existing landmarks in the field, resort must be had to the field notes of the original survey. The law provides that the lengths of the lines, as stated in the field notes, shall be considered as the true lengths of the lines, and that stakes between corners set down in the field notes constitute proper data from which to determine the true locality of a missing corner; hence the rule that all such should be restored at distances proportionate to the original measurements between existing original corners. That is, if the measurement between two existing original corners be disturbed, the point should be restored in the proportion that the distance between the disturbed corner and the existing original corners should be to the distance between the original corners as the distance between the disturbed corner and the existing original corners should be to the distance between the original corners. Missing corners on standard township and range lines should be restored by proportionate measurement between the nearest existing original corners on these lines. Missing section corners in the interior of townships should be re-established at proportionate distances between the nearest existing original corners north and south of the missing corner, and it will be plain that any excess or deficiency in measurement between existing corners, as mentioned in any description of the corners, beyond what existing corners, but must be noted or substantiated proportionately to or from the intervals embraced between the corners, which are still standing.

OFFICIAL SUB-DIVISIONS BY COUNTY OFFICIALS.

Various States require their county auditors or clerks to cause a survey and plat of "franchise tracts" of land to be made and placed upon record, which, for assessment purposes, the descriptions are to include. These become official, and title will pass as the same appears of record, by the number of each lot being given on the plat. Diagram No. 3, on reverse page, shows a practical subdivision of a section for assessment or other purposes, with a proper description of each fractional part of the quarter section.

MILES AND HOURS.

In the Eastern and New England States the system of surveying and describing lands in miles and hours is followed prior to the establishment of the rectangular system of surveys still exists. The system of this kind is imperfect and uncertain in its working, having no known lines for base of surveys, and seldom any official plots for reference to initial points. Diagram No. 4 shows a tract of land described and platted by "miles and hours," as the same would appear in deeds.

STANDARD TIME.

What is known as the "new standard time," was adopted by agreement of all the principal railroads of the United States at 12 o'clock, noon, on Nov. 18, 1883. The system divides the Continent into time longitudinal belts, and establishes a standard of time for each belt. These meridians are fifteen degrees of longitude, corresponding to one hour of time, apart.

Eastern Maine, New Brunswick, and Nova Scotia use the fifth meridian; the Florida, New England, the Middle States, the Virginia, and the Carolina use the sixth meridian, which is that at Philadelphia; the States of the Mississippi Valley, Alabama, Georgia, Florida, and western Louisiana, including Texas, Kansas, and the greater part of Nebraska and the Dakotas, use the seventh meridian, which is that of New Orleans; the Territories of the western border of Arizona and Pacific States use the eighth meridian, which is that of Denver; and the Territory of Idaho use the ninth meridian.

The time divisions are known as International, eastern, central, mountain, and Pacific standard time. A traveler passing from one belt to another will find his watch one hour too fast or too slow, according to the meridian in which he is going. If traveling westward, his watch will be one hour faster; if eastward, it will be one hour slower than the local which he enters, and will be one hour slower than the time standards used by the other railroads and any other three to five, a great convenience to the railroad and traveling public.

The system of time in the adoption of this new system originated with Professor Abbot of the Signal Service at Washington, and was championed by Dr. J. A. P. Harnell, of a similarly office, New York. The scheme was proposed in 1878, but was not adopted until it had been submitted to a number of scientific associations at home and abroad, and received their approval.

Copyright secured by W. A. Rorer & Co.

2
DIAGRAM

Showing Official Plat of a Township Sectioned and Numbered by Government Surveyors with the fractions on North and West side of Township with plan of numbering fractional lots where bounded by lake or creek.

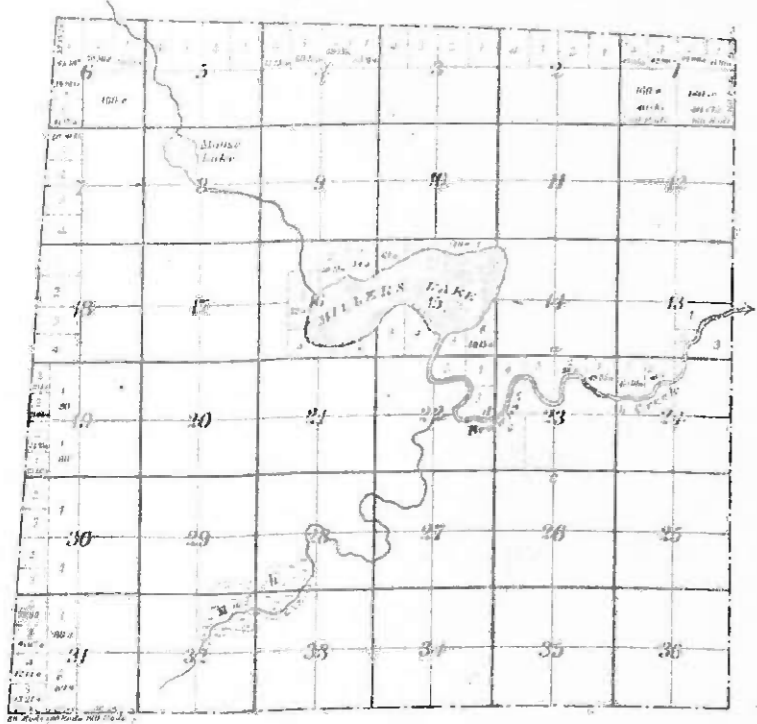

3
DIAGRAM

Showing Practical Sub-Divisions and Descriptions of a Section.



4
DIAGRAM

Showing fractional part of Section described by Acres and Bounties.

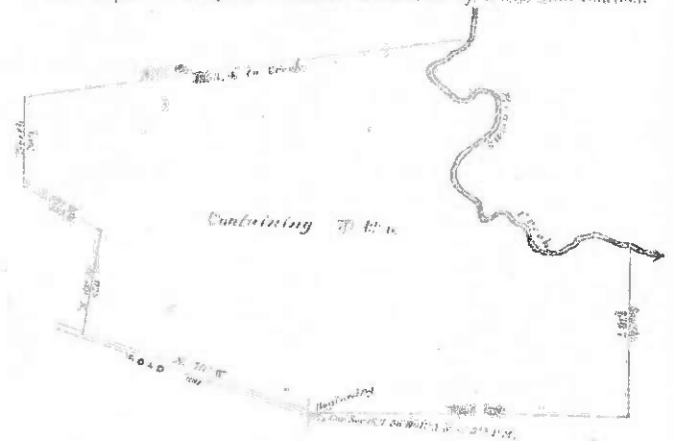

MAP
showing the
PRINCIPAL MERIDIANS AND BASE LINES

IN THE
UNITED STATES
Governing U.S. Surveys also Showing the
BELTS OF STANDARD TIME.

1903.
Copyrighted.



1
DIAGRAM

Showing Official Plan of Numbering Townships from Meridians and Base Lines North and South East and West.

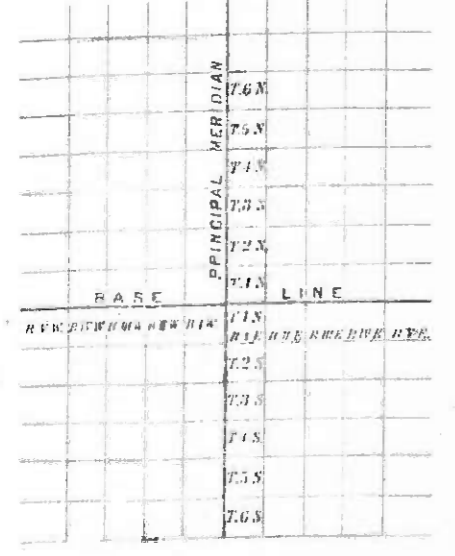

Compiled for this work from Official Data by J. H. Woodson, Surveyor & Engineer, Clinton, Iowa.

PATRONS' DIRECTORY OF DONIPHAN COUNTY, KANSAS.

HURR OAK.

NAME	BUSINESS	POSTOFFICE	SEC.
Bauman, John	Farmer, Stock Raiser and Fruit Grower	Wathena	29
Engemann, W. H.	Farmer, Stock Raiser and Fruit Grower	Wathena	30
Gardner, H. L.	Farmer, Stock Raiser and Fruit Grower	Wathena	3
Jager, J.	Farmer, Stock Raiser and Fruit Grower	Galvied	28
Jennings, E. S.	Farmer, Stock Raiser and Fruit Grower	Galvied	14
Lakmann, Sam	Farmer, Stock Raiser and Fruit Grower	Wathena	32
Piper, D. S.	Farmer and Stock Raiser	Galvied	25
Salter, J. H.	Farmer and Stock Raiser	Troy	1
Schmidt, R.	Farmer, Stock Raiser and Fruit Grower	Wathena	4
Schuler, George	Farmer, Stock Raiser and Fruit Grower	Wathena	29
Schuler, Joseph	Farmer, Stock Raiser and Fruit Grower	Wathena	29
Schuler, Matthew	Farmer, Stock Raiser and Fruit Grower	Wathena	30
Silvers, John	Farmer, Stock Raiser and Fruit Grower	Wathena	29
Studer, John	Farmer, Stock Raiser and Fruit Grower	Wathena	3
Studer, J. P.	Farmer, Stock Raiser and Fruit Grower	Wathena	3

CENTER.

Albert, J. M.	Farmer and Stock Raiser	Troy	27
Alkire, E. Y.	Farmer and Stock Raiser	Bonkema	23
Arnold, W. F.	Farmer, Stock Raiser and Fruit Grower	Troy	3
Barnhill, A. C.	Farmer and Stock Raiser	Troy	29
Briggs, Henry	Farmer and Stock Raiser	Troy	5
Clary, W. M.	Farmer, Stock Raiser and Fruit Grower	Troy	31
Croston, Thos.	Farmer and Stock Raiser	Troy	17
Cox, Moses F.	Farmer and Stock Raiser	Troy	4
Dunn, G. F.	Farmer and Stock Raiser	Troy	27
Dave, Thos. J.	Farmer and Breeder of Short Horn Cattle	Troy	25
Dittmore, J. W.	Farmer and Stock Raiser	Troy	28
Duncan, D. M.	Farmer, Stock Raiser and Fruit Grower	Wathena	14
Echling, J. H.	Farmer, Fruit Grower and Grain Dealer	Troy	15
Eskins, G. M.	Farmer, Fruit Grower and Stock Raiser	Troy	23
Falsche, Wm.	Farmer and Stock Raiser	Troy	36
Gibbins, J. N.	Farmer and Stock Raiser	Troy	3
Gibson, L. H.	Farmer, Merchant and Postmaster	Bazarrh	22
Goss, J. M.	Farmer, Stock Raiser and Dealer	Troy	5
Gunn, Edwin	Farmer, Stock Raiser and Fruit Grower	Troy	9
Haupt, H. W.	Farmer, Stock Raiser and Feeder	Troy	32
Kent, Ab.	Farmer, Stock Raiser and Feeder	Troy	33
King, W. A.	Farmer and Stock Raiser	Galvied	26
Kirwin, P. H.	Farmer and Stock Raiser	Troy	29
Largo, George	Farmer and Stock Raiser	Troy	26
Loroff, Frank	Farmer and Stock Raiser	Troy	26
Montgomery, R. H.	Farmer, Breeder of Draft Horses and Fruit Grower	Troy	9
Morhead, C. A.	Farmer and Stock Raiser	Troy	18
Reynolds, E. R.	Farmer and Stock Raiser	Troy	4
Rickles, John E.	Farmer and Stock Raiser	Troy	29
Saxton, H. L.	Farmer and Fruit Grower	Troy	19
Taylor, G. B.	Farmer and Stock Raiser	Troy	32
Taylor, Henry	Farmer and Fruit Grower	Troy	6
Trotter, Wm.	Farmer, Stock Raiser and Fruit Grower	Troy	4
Triplet, Chas.	Farmer, Stock Raiser and Dealer	Troy	5
Webber, Frank	Farmer and Stock Raiser	Troy	33
Wyker, H. C.	Farmer and Fruit Grower	Troy	9

DENTON, CITY OF.

BUSINESS

NAME	BUSINESS
Harpster, S. G.	Cashier of the Bank of Denton.
Murray, Kyle	Postmaster and School Teacher.
Parr, G. W.	Dealer in Grain and Hay.
Shiltz, A. C.	Proprietor Livery and Feed Barn.
The Denton Lumber Co.	Dealers in Lumber and Building Materials. J. T. Gilhous, Manager.

ELWOOD.

Jones, C. R.	Dealer in Coal, Wood and Feed.
Stacy, J. R.	Justice of the Peace.
Wall, W. W.	Farmer and Dealer in Real Estate.

HIGHLAND.

Armstrong, T. J.	Notary Public, Insurance and Collection Agent.
Back, Prof. E. E.	Teacher.
Bank of Highland, The	General Banking Business.
Bene, W. M., M. D.	Physician and Surgeon.
Dillon, H.	Bridge Commissioner of Doniphan County.
Isaac, J. W.	Carpenter and Joiner.
Darler, John	Contractor and Builder.
Hott, Thomas G.	Farmer and Stock Raiser. Make a specialty of matched items and work a guarantee.
Johnson, Mrs. V. M.	Executor of the Estate of J. P. Johnson, deceased.
Larson, Tobias	Editor of the Highland Valiant.
Rau, John	Proprietor City Hotel.
Rau, Wm. L.	Veterinary Surgeon.
Sheld, J. P.	Dealer in Lumber, Coal and Building Material.
Smith, H. H., M. D.	Physician and Surgeon. Fitting of Glasses a Specialty.
Silvers, L. J.	Dealer in Real Estate and Collection Agent.
Williams, B. D.	Dealer in all kinds of Grain and Live Stock.
Young, John F.	Proprietor Livery, Feed and Sale Stable.

HIGHLAND STATION.

BUSINESS

NAME	BUSINESS	POSTOFFICE	SEC.
Gilgaher, N. N.	Breeder of Short-horn Cattle and Shropshire Sheep.	Highland Station	29
Jennings, Dr. A.	Physician and Surgeon. Proprietor of Drug Store.	Highland	25
Toxell, F. M.	Proprietor Livery, Feed and Sale Stable.	Highland Station	17

IOWA.

NAME	BUSINESS	POSTOFFICE	SEC.
Collins, J. H.	Farmer and Stock Raiser	Highland Station	29
Dovall, J.	Farmer and Stock Raiser	Highland	25
Dutton, J. B.	Farmer and Stock Raiser	Iowa Point	35
Dutton, J. E.	Farmer and Stock Raiser	Highland Station	17
Dutton, John	Farmer and Stock Raiser	White Cloud	1
Dutton, Dr. A. J.	Farmer and Stock Raiser	White Cloud	31
Edwards, L. R.	Farmer and Stock Raiser	Highland Station	18
Ehertson, Tom	Farmer and Stock Raiser	Fanning	33
French, S. E.	Farmer and Stock Raiser, and Breeder of Pure-bred Poland China Hogs	Highland Station	8
Fryland, A.	Farmer and Stock Raiser	Highland	25
Gallagher, C. F.	Farmer and Stock Raiser	Fanning	28
Garrett, E. A.	Of Garrett Bros., Dealers in General Merchandise, also Farmers, Stock Raisers, Fruit Growers. Dealers in Pure-bred Poland China Hogs	Fanning	34
Guthrie, H. D.	Farmer, Feeder and Stock Raiser	Highland Station	3
Hayes, L. J.	Farmer and Grower of Fruits of all kinds	Highland Station	9
Haidan, Thomas	Farmer and Stock Raiser	Highland Station	28
Hedrick, A. J.	Farmer and Stock Raiser	Highland Station	29
Hedrick, Ida M.	Fruit Grower	Fanning	27
Hedrick, E. G.	Dealer in General Merchandise, Grain and Wood	Fanning	34
Jackson, Jas. A.	Fruit Grower and Apurian	Highland Station	9
Lewis, S. M.	Farmer, Breeder of Fine Road Horses, owner of Mischief 2:20	White Cloud	8
Malchow, Z.	Farmer	Iowa Point	35
Massey, F.	Dealer in General Merchandise. Also Postmaster	Iowa Point	36
Miller, Chas. B.	Farmer and Stock Raiser, Ex. County Commissioner	Highland	31
Miner, F. S.	Farmer and Fine Stock Raiser	Highland	15
Moore, G. D.	Farmer, Feeder and Stock Raiser	Highland Station	7
Moore, George W.	Farmer	Iowa Point	6
Moss, J. C.	Farmer and Stock Raiser	Highland	27
Moss, J. J.	Grower of all kinds of Small Fruit also Apples, Peaches, Etc.	Highland Station	15
Nedding, C. C.	Farmer and Stock Raiser	White Cloud	4
Noble, J. L.	Farmer, Stock Raiser and Twp. Trustee	Highland	18
Noble, David	Farmer and Stock Raiser	Highland	12
Noble, W. H.	Farmer and Stock Raiser	Highland	26
Nuzzum, J. E.	Farmer and Stock Raiser	Highland	1
Onstott, W. H.	Farmer and Stock Raiser	Highland	2
Prank, Prior	Proprietor Eagle Springs Farm	Highland	16
Ragland, W. T.	Farmer and Stock Raiser	Highland	30
Robertson, G. W.	Farmer and Breeder of Pure-bred Short-horn Cattle	Severance	36
Robinson, Martin	Farmer and Stock Raiser	Highland	16
Sparks, J. G.	Farmer and Stock Raiser, and Breeder of Fine Males	Highland Station	20
Sparks, Robert	Farmer and Stock Raiser	Highland	32
Scaris, Andrew	Farmer and Stock Raiser	Highland Station	21
Stricker, J. E.	Farmer, Breeder of Short-horn Cattle, Poland China Hogs, Shropshire Sheep, Fancy Doulter, Stock for Sale	Highland Station	39
Scott, Frank	Farmer, Breeder High Grade Cattle	Highland	16
Sutton, James	Farmer and Fruit Grower	Highland Station	22
Taylor, Mrs. R.	Farmer and Stock Raiser	White Cloud	27
Taylor, Peter	Farmer and Stock Raiser	White Cloud	22
Taylor, Ed.	Farmer and Stock Raiser	White Cloud	22
Tacey, R. E.	Farmer and Stock Raiser	Highland Station	17
Timmy, E. W.	Farmer and Stock Raiser	Highland Station	4
Thompson, Clinton	Farmer and Stock Raiser	Highland Station	22
White, John	Represents the Mutual Life Insurance Co. of New York	Hiawatha	—
Williams, John	Farmer, Stock Raiser and Fruit Grower	Iowa Point	35
Wiminger, G. E.	Farmer and Stock Raiser	White Cloud	32
Winkler, W. G.	Farmer and Stock Raiser	White Cloud	6
Wyatt, J. I.	Farmer and Stock Raiser	Highland	30

MARION.

Bell, Aaron	Farmer, Stock Raiser and Fruit Grower	Wathena	32
Carter, W. J.	Farmer, Stock Raiser and Feeder	Wathena	19
Hustins, H. G.	Farmer and Stock Raiser	Idlermo	7
Keatinge, J. A.	Farmer, Stock Raiser and Fruit Grower	Wathena	18
Kucheloff, W. E.	Farmer, Stock Raiser and Fruit Grower	Wathena	24
Lakin, J. J.	Farmer, Stock Raiser and Fruit Grower	Idlermo	5
Miller, Andrew	Farmer, Stock Raiser and Fruit Grower	Wathena	7
Porter, P. A.	Farmer, Stock Raiser and Feeder	Idlermo	12
Wagner, H. D.	Pastor German Lutheran Church	Wathena	2
Wakeman, T. H.	Farmer, Stock Raiser and Fruit Grower	Wathena	31
Winn, H. S.	Farmer, Stock Raiser and Fruit Grower	Wathena	32

SEVERANCE.

BUSINESS

NAME	BUSINESS
Campbell, J. A.	Real Estate and Collection Agent.
Edging, J. E.	Old time of Edging & Laventis. Proprietors Severance Rolling Mills.
Francis, T. J.	Dealer in Coal and Lumber. All kinds of Building Material.
Honey, Ed.	Dealer in Hardware, Implements, Furniture and Undertaking Goods.
Michey, J. M.	Proprietor Bank of Severance. A General Banking Business Transacted.
Pedler, Hattie E.	Editor and Proprietor of Severance News.
Van Bohler, W. N.	Proprietor Livery, Feed and Sale Stable.

TROY.

NAME	BUSINESS
Bank of Troy	A General Banking Business Transacted.
Bowers, Alred	Attorney.
Byers & Sons	Dealers in Hardware, Implements, Undertaking Goods and Furniture.
Charles Bros.	Proprietors of Livery, Feed and Sale Stable.
Dinsmore, Dr. B. S.	Physician and Surgeon.
Edley, Clarence M.	Abstractor of Titles. Real Estate Loans.
Groves, A. H.	Treasurer of Hamilton County.
Helvey, W. A.	Proprietor of Bond Ave.
Jones, A. D.	Dealer in Hardware, Tinware, Stoves, Furniture and Harness Goods.
Lancaster, E. J.	Attorney.
Marsh, F. P.	County Surveyor of Hamilton County.
Muytney, H. A.	Dealer in Pumps, Wind Mills, Gasoline Engines, Tin and Sheet Iron Works. Repairs of all kinds done. Air pressure water works and hot air furnaces a specialty.
Myers, Dr. J. C.	Dentist.
Norman, Chas. V.	Superintendent Public Instruction.
Oandinger, Ed.	Register of Deeds of Hamilton County.
Perry, A. L.	Abstractor.
Rubman & Gullman	Co. Dealers in Farm Machinery, Hardware, Harness, Wagons, Buggies, etc.
Rhue, M. J.	Farmer and Stock Raiser.
Sutton, James A.	Farmer and Fruit Grower.
Schall, T. J.	Publisher of The Troy Kansas Chief.
Strahan, G. W.	Clerk of the District Court.
Zimmerman, W. P.	Dealer in Grain and Produce.

UNION.

BUSINESS

NAME	BUSINESS	POSTOFFICE	SEC.
Alfred, Gene	Farmer and Stock Raiser	Bendona	1
Anderson, O. M.	Proprietor of Walnut Grove Stock Farm. Justice of the Peace. Representative for the Mutual and Old Line Insurance Co.	Union	32
Anderson, Sever	Farmer and Stock Raiser	Dentonville	12
Bradley, Rev. M.	Catholic Priest	Bendona	13
Brentano, B.	Farmer and Stock Raiser	Dentonville	9
Edwards, D. W.	Farmer, Stock Raiser and ex-Representative	Dentonville	13
Groninger, A. H.	Farmer and Stock Raiser	Bendona	12
Groninger, H.	Farmer and Stock Raiser	Bendona	27
Hunter, J. H.	Farmer and Stock Raiser	Dentonville	11
McIndy, Pat.	Farmer and Stock Raiser, Feeder and Shipper	Bendona	12
Mudge, J. P.	Farmer and Stock Raiser	Parcell	17
Normie, W.	Farmer and Stock Raiser	Parson	31
Pinder, A. G.	Farmer and Stock Raiser	Parcell	30
Burrell, M. T.	Dealer in General Merchandise	Dentonville	12
Rank, G. H.	Farmer and Stock Raiser	Dentonville	9
Straator, Emery S.	Farmer and Stock Raiser	Bendona	26
Swartz, A. B.	Farmer and Stock Raiser	Bendona	26

WASHINGTON.

NAME	BUSINESS	POSTOFFICE	SEC.
Clark, E. W.	Farmer and Fruit Grower	Watheon	31
Conger, Wilson	Farmer	Elswood	36
Dubach, Fred.	Farmer, Stock Raiser and Fruit Grower	Watheon	30
Dubach, O. A.	Farmer, Stock Raiser and Fruit Grower	Watheon	31
Euler, J. D.	Farmer and Fruit Grower	Troy	12
Fleck, E. C.	Farmer and Fruit Grower	Watheon	38
Fleck, I.	Farmer, Stock Raiser and Fruit Grower	Troy	12
Foley, F. C.	Farmer, Stock Dealer, Buyer and Shipper	Watheon	7
Fulcrum, William	Farmer and Fruit Grower	Watheon	24
Hasko, August	Farmer and Fruit Grower	Watheon	32
Kicker, L. P.	Fruit Grower and Gardener	Watheon	16
Lohmann, J. W.	Fruit Grower and Stock Raiser	Watheon	31
Marg, Martin	Farmer, Fruit Grower and Stock Raiser	Watheon	23
Martin, A. E.	Farmer and Fruit Grower	Watheon	32
Martin, W. R.	Farmer and Fruit Grower	Watheon	32
Mason, Richard	Farmer and Fruit Grower	Watheon	32
Newton, Othorn	Farmer and Fruit Grower	Watheon	15
Pager, A. L.	Farmer and Stock Raiser	Watheon	30
Rice, F. L.	Farmer and Fruit Grower	Watheon	7
Rogers, I. H.	Farmer and Fruit Grower	Watheon	8
Schilly, F. W.	Farmer and Dealer in Live Stock	Watheon	29
Slaughter, Sam	Farmer and Fruit Grower	Watheon	21
Vares, T. H.	Farmer and Fruit Grower	Watheon	30
Widmer, John	Farmer and Fruit Grower	Watheon	30

WATHENA.

BUSINESS

NAME	BUSINESS
Rauer, M. Jr.	Fruit Grower and Shipper. Real Estate Dealer.
Bullberg, Rev. John	Catholic Clergyman.
Carter, W. W.	Physician and Surgeon.
Cranning, E. H.	Farmer, Fruit Grower, Canner and Real Estate Dealer.
Dreeschner Bros.	Corn Dealers, M. Brown, Jr., Manager.
Gordon, John A. C.	Dealer in Lumber and Building Material. Wholesale Shipper of Feed.
Grubly, J. H., M.D.	Physician and Surgeon.

WATHENA. Continued.

BUSINESS

NAME	BUSINESS
Gilchrist, Paul	Editor of The Wathena Times.
Libel, L. A.	Cashier Farmers' State Bank. A General Banking Business Transacted.
Miller, Jacob	Prescription Druggist. Dealer in Drugs, School Supplies, Wall Paper and Paint.
Pratt, E. N.	Dentist.
Stewart, W. E.	City Clerk.
Thompson, A. W.	Publisher of The Wathena Weekly Republican.

WAYNE.

BUSINESS

NAME	BUSINESS	POSTOFFICE	SEC.
Albers, A. F.	Farmer and Stock Raiser	Atchison	21
Bahr, Nicholas	Farmer and Stock Raiser	Troy	3
Braun, Anton	Farmer and Stock Raiser	Douphin	32
Brenner, N. G.	President and Secretary of the Jacob Brenner Wine Co. Wine Grower. Strictly Dry Wines for Sacramental Purposes a Specialty.	Douphin	5
Buster, W. C.	Farmer and Stock Raiser	Atchison	34
Butler, James	Farmer and Stock Raiser	Douphin	32
Crawski, John	Farmer and Stock Raiser	Troy	17
Chambers, Robert	Farmer and Stock Raiser	Douphin	33
Ege, Edward A.	Farmer, Stock Raiser and Dealer	Atchison	22
Eimerlich, Geo.	Farmer and Stock Raiser	Bendona	19
Evler, J. E.	Farmer and Stock Raiser	Bendona	17
Grady, William	Farmer, Stock Raiser and Fruit Grower	Geary City	27
Hankle, Paul	Farmer and Stock Raiser	Atchison	33
Jones, Edwin	Farmer and Stock Raiser	Atchison	14
Kiehloff, A. M.	Farmer and Stock Raiser	Troy	3
Ludwig, R. M.	Farmer and Stock Raiser	Bendona	2
Lungus, T. W.	Farmer, Stock Raiser and Feeder	Douphin	30
Larsen, Fred	Farmer, Stock Raiser and Feeder	Atchison	14
Laudis, O. W.	Farmer and Stock Raiser	Troy	18
Martin, L. T.	Farmer and Stock Raiser	Douphin	29
McVey, Frank	Farmer and Stock Raiser	Atchison	28
Nitz, Chas.	Farmer and Stock Raiser	Geary City	22
Oswable, E. P.	Farmer and Stock Raiser	Atchison	29
Riekels, Herman	Farmer and Stock Raiser	Troy	4
Reichendenger, J. J.	Farmer and Stock Raiser	Severance	19
Riekels, A. M.	Farmer and Stock Raiser	Bendona	16
Scholz, William	Farmer and Stock Raiser	Douphin	34
Severin, J. E.	Farmer, Stock Raiser and Dealer	Brewer	1
Shaw, George	Farmer and Stock Raiser	Atchison	33
Steinweden, Ch.	Farmer and Stock Raiser	Douphin	3
Sinclair, Geo. C.	Farmer and Stock Raiser	Brewer	1
Willmson, George	Farmer and Stock Raiser	Brewer	6

WHITE CLOUD.

BUSINESS

NAME	BUSINESS
Campbell, J. W.	Dealer in General Merchandise.
Lynds, W. L.	Dealer in Hardware, Stoves, Implements, Pumps and Wind Mills, Seeds and Oils, Sporting Goods, Buggies and Wagons.
Marker, E. L.	Editor of the White Cloud Globe, published Thursday. Also Agent for Fire, Tornado and Hail Insurance.
Shreve, C. W.	Druggist and Notary Public.
Stanley, H. M.	Dealer in Dry Goods, Groceries, and Furnishing Goods.
White Cloud Lumber Co.	R. E. Garlock, Manager. Headquarters for all kinds of Building Material.

WOLF RIVER.

BUSINESS

NAME	BUSINESS	POSTOFFICE	SEC.
Andrus, W. W.	Farmer and Stock Raiser	Severance	10
Black, W. H.	Farmer and Stock Raiser	Severance	2
Brown, J. D.	Farmer and Stock Raiser	Fanning	3
Carter, Geo. W.	Farmer and Stock Raiser	Severance	9
Farmers' Bank	Do a General Banking Business	Leona	—
Ferrie, Monroe	Farmer and Stock Raiser	Severance	11
Dittmore, J. C.	Farmer and Stock Raiser	Severance	13
Dudin, Leo	Farmer, Breeder of Short-horn Cattle and German Coach Horses	Leona	30
Dudin, Bro.	Farmer, Breeder of Short-horn Cattle and German Coach Horses	Leona	30
Hale, John R.	Farmer and Stock Raiser	Severance	10
Hanson, George	Farmer and Grain Raiser	Leona	29
Hreizing Bros.	Farmer and Cattle Raisers	Highland Station	8
Hudson, A. A.	Farmer and Stock Raiser	Moray	22
Huss, J. H.	Farmer, Breeder High-grade Road Horses	Highland Station	17
Jandus, John	Farmer and Stock Raiser	Severance	12
Lancaster, Ed.	Farmer and Breeder of High-grade Short-horn Cattle	Highland Station	1
Lavrentz, Henry A.	Farmer and Breeder of High-grade Coach Horses	Severance	22
Mayer, C. L.	Farmer and Breeder of Mules	Severance	11
Nelson, N. L.	Farmer, Stock Raiser and County Commissioner	Moray	21
Pennell, George	Farmer and Stock Raiser	Fanning	3
Rhincour, William	Farmer and Stock Raiser	Severance	15
Ritcheous, Noah	Farmer, Stock Raiser and Fruit Grower	Severance	20
Ruddy, Michael	Farmer and Stock Raiser	Troy	9
Slay, John	Farmer and Stock Raiser	Highland Station	17
Straator, Mrs. Fred	Farmer and Stock Raiser	Severance	10
Stinson, Amelia G.	Farmer and Stock Raiser	Troy	21
Thomas, Frank	Farmer and Fruit Grower	Fanning	3
Viggs, William	Farmer and Stock Raiser	Highland	12
Wood, W. E.	Farmer, Breeder of Pure Poland China Hogs. Lathrop Clocks and Bronze Toys. Fruit Grower	Troy	16